

Floor Expansion Joint Covers

i424[®]



Description

The **i424[®]** floor expansion joint system is a pan system designed for generous thermal and seismic movement requirements.

Key Features

- **Install Condition:** Floor/Floor, Floor/Wall.
- **Joint width:** 50-300mm.
- Optional fire rated.
- Seamlessly integrates with coordinating Wall system.
- Anti-slip surface serrations.
- Applicable for existing conditions, additions and new construction.
- System can be modified to meet any movement.
- Mill finish aluminum.

Materials

Aluminum: Alloy types of 6061-T6, 6063-T6, 6005A, or 5052-H32 sheet goods.

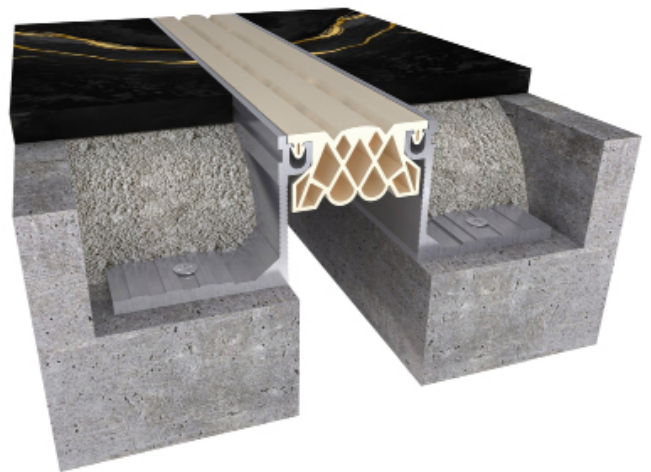

Application Instructions

Installation: Joint systems: Install in accordance with manufacturer's instructions.

Align work plumb, level and flush with adjacent surfaces. Mechanically anchor to substrate. Allowances should be made where actual structural gap at time of installation varies from nominal design gap. No shimming of frames is permitted. Coordinate with work of other Sections.

If concrete blockouts (rebates) are required, ensure continuous support equal to surrounding substrate structural values.

Fire Rated Assemblies: Where required, install to manufacturer's instructions.

Moisture Barrier: Where required, install to manufacturer's instructions.

Floor Expansion Joint Covers

i424[®]



Protect: the completed Expansion Control system work from damage during construction. Damage protection includes surface abrasion and overloading of coverplate by materials handling equipment and construction waste/debris. Protection from environmental factors required throughout installation process until Project Closeout. Protection includes but is not limited to rain events, moisture protection, exposure to temperature fluctuations or direct sunlight for temperature sensitive product offerings.

Store

Store components in original containers in a clean, dry location. Ensure temperature or moisture sensitive components are stored in a tempered location.

Contractor to provide temporary protective covers on all installed finished surfaces. Protection is required to guard against both surface abrasions as well as overloading of horizontal deck components by construction traffic .

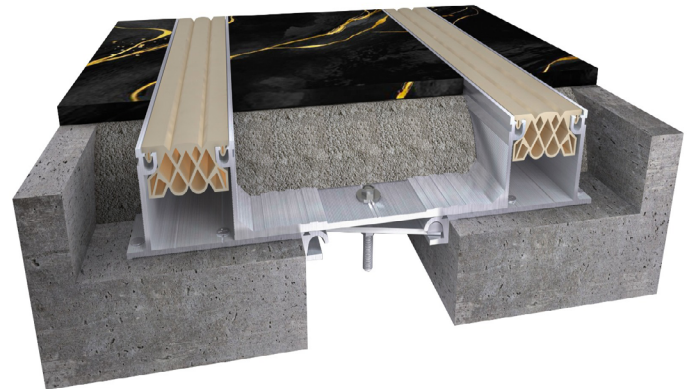

Movement ± 50%

| Application | System | W | H1 | H2 | S | B | Movement +/- | | L |
|----------------|------------|-------------|----------------|----------|-----------|----------|--------------|----------|------|
| | | Joint Width | Frame Height 1 | Height 2 | Sightline | Blockout | Horizontal | Vertical | Load |
| | | mm | mm | mm | mm | mm | mm | mm | Kn |
| Floor to Floor | i424-50 | 50 | 60 | * | 55 | 155 | 25 | 25 | 45 |
| | i424-75 | 75 | 60 | * | 80 | 155 | 37.5 | 7.35 | 45 |
| | i424-100 | 100 | 60 | * | 110 | 155 | 50 | 50 | 45 |
| | i424-150 | 150 | 60 | * | 160 | 155 | 75 | 75 | 45 |
| | i424-200 | 200 | 60 | * | 210 | 155 | 100 | 100 | 45 |
| | i424-250 | 250 | 60 | * | 260 | 155 | 125 | 125 | 45 |
| | i424-300 | 300 | 60 | * | 260 | 155 | 150 | 150 | 45 |
| Floor to Wall | i424-C-50 | 50 | 60 | * | 55 | 155 | 25 | 25 | 45 |
| | i424-C-75 | 75 | 60 | * | 80 | 155 | 37.5 | 37.5 | 45 |
| | i424-C-100 | 100 | 60 | * | 110 | 155 | 50 | 50 | 45 |
| | i424-C-150 | 150 | 60 | * | 160 | 155 | 75 | 75 | 45 |
| | i424-C-200 | 200 | 60 | * | 210 | 155 | 100 | 100 | 45 |
| | i424-C-250 | 250 | 60 | * | 260 | 155 | 125 | 125 | 45 |
| | i424-C-300 | 300 | 60 | * | 310 | 155 | 150 | 150 | 45 |

Series i424-100 Floor to Floor

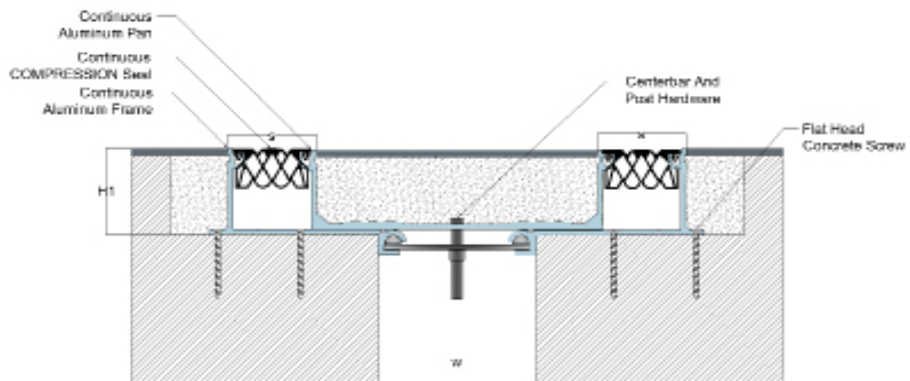

Series i424-c-50 - Floor to Wall

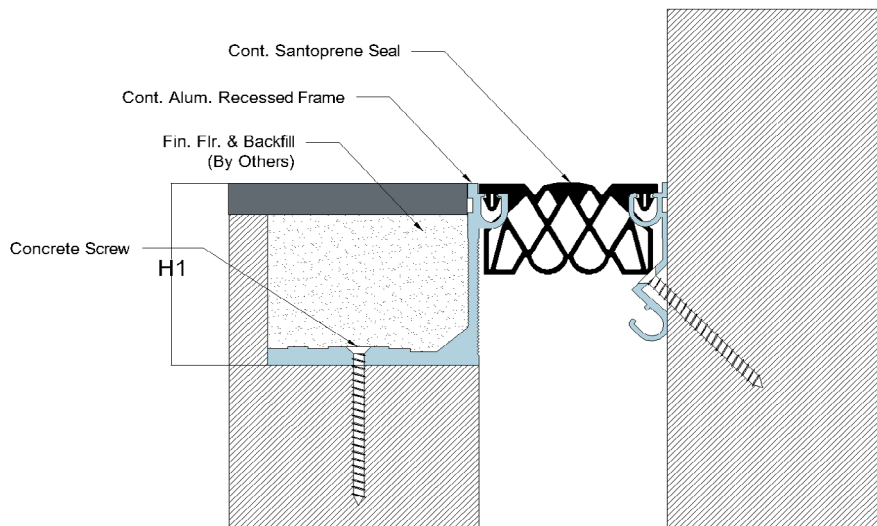

i424[®]

Series i424-100 iFlex PVC Options

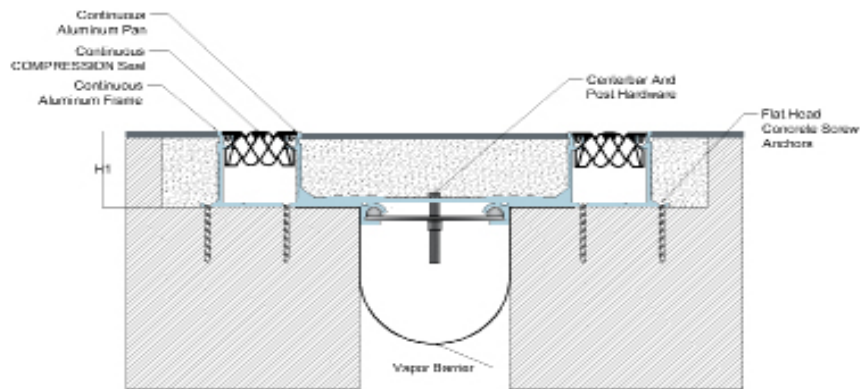

Series i424-50 FireStop S30 Options

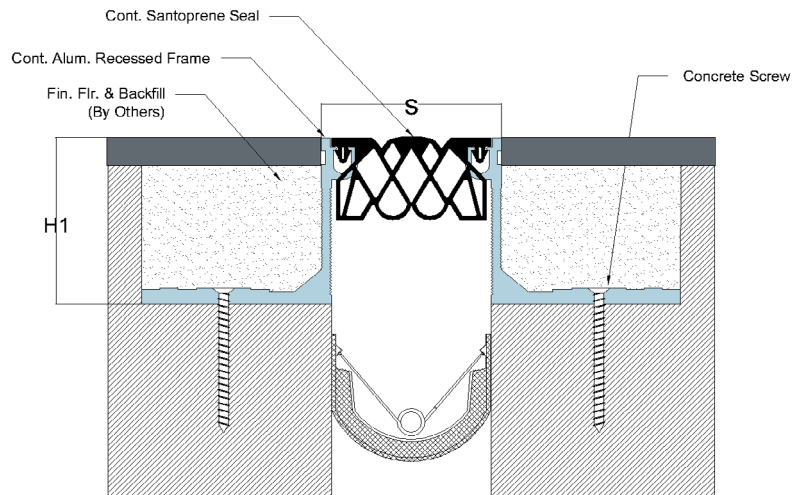

Technical Data Sheet - January 2024, Version 1.1.5

Office : 22 El-Shaheed Mohamed Abd
El-Hadi Street, Nasr City, Cairo
Website : www.iChemEg.com
Email : info@ichemeg.com

