

## Roof Expansion Joint System

# i110<sup>®</sup>

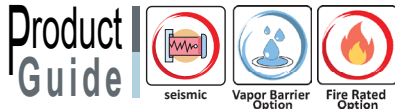

### Description

The i110<sup>®</sup> roof expansion joint system accommodates multi-directional seismic movement and is installed with a 2x up stand mount.

### Key Features

- **Install Condition:** Roof/Roof, Roof/Wall.
- **Joint width:** Manufactured according to site requirements.
- Optional fire rated.
- Seamlessly integrates with coordinating Wall system.
- Applicable for existing conditions, additions and new construction.
- Mill finish aluminum.

### Materials

**Aluminum:** Alloy types of 6061-T6, 6063-T6, 6005A, or 5052-H32 sheet goods.

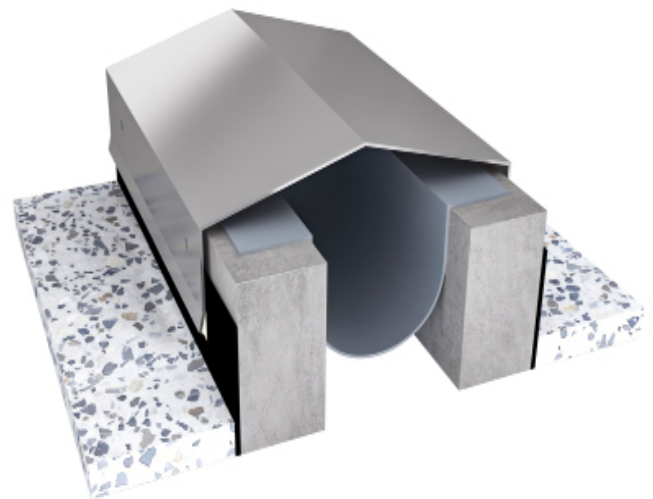

### Application Instructions

**Installation:** Joint systems: Install in accordance with manufacturer's instructions.

Align work plumb, level and flush with adjacent surfaces. Mechanically anchor to substrate. Allowances should be made where actual structural gap at time of installation varies from nominal design gap. No shimming of frames is permitted. Coordinate with work of other Sections.

If concrete blockouts (rebates) are required, ensure continuous support equal to surrounding substrate structural values.

Fire Rated Assemblies: Where required, install to manufacturer's instructions.

**Moisture Barrier:** Where required, install to manufacturer's instructions.

## Roof Expansion Joint System

# i110<sup>®</sup>



**Protect:** the completed Expansion Control system work from damage during construction. Damage protection includes surface abrasion and overloading of coverplate by materials handling equipment and construction waste/debris. Protection from environmental factors required throughout installation process until Project Closeout. Protection includes but is not limited to rain events, moisture protection, exposure to temperature fluctuations or direct sunlight for temperature sensitive product offerings.

### Store

Store components in original containers in a clean, dry location. Ensure temperature or moisture sensitive components are stored in a tempered location.

Contractor to provide temporary protective covers on all installed finished surfaces. Protection is required to guard against both surface abrasions as well as overloading of horizontal deck components by construction traffic.

### Movement ± 50%

Application	System	W	H1	H2	S	Movement +/-		L
		Joint Width	Frame Height 1	Height 2	Sightline	Horizontal	Vertical	Load
		mm	mm	mm	mm	mm	mm	Kn
Roof to Roof		<b>Manufactured according to site requirements</b>						
Roof to Wall		<b>Manufactured according to site requirements</b>						

# Roof Expansion Joint System

# i110<sup>®</sup>



## Series i110 - Roof to Roof

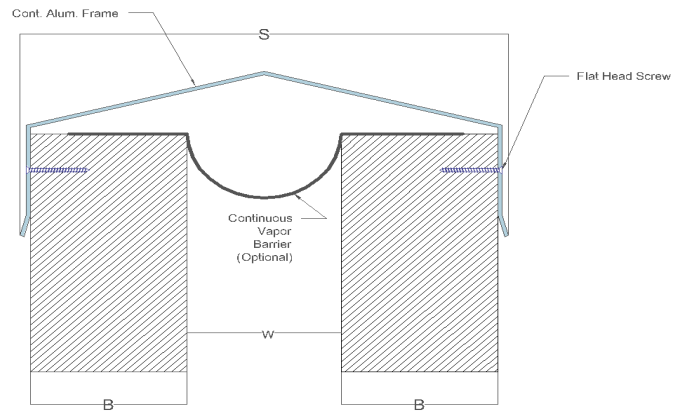

## Series i110 C - Roof to Wall

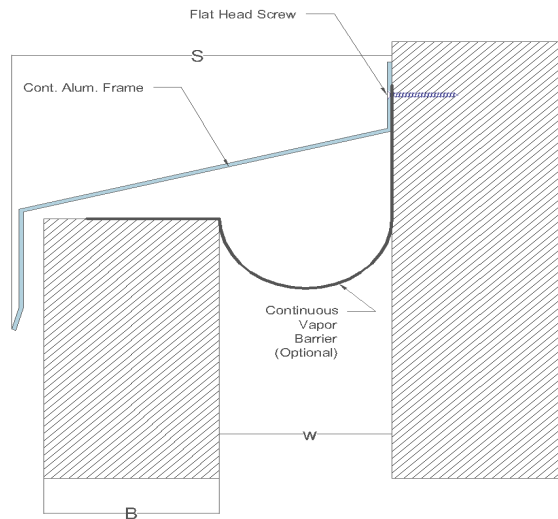

## Roof Expansion Joint System

# i110<sup>®</sup>

### Series i110- FireStop S30 Options

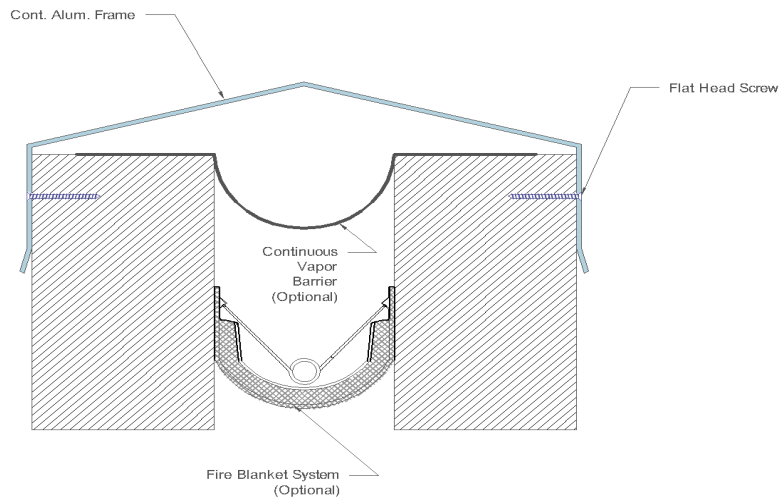

Technical Data Sheet - January 2024, Version 1.1.5

Office : 22 El-Shaheed Mohamed Abd  
El-Hadi Street, Nasr City, Cairo  
Website : [www.iChemEg.com](http://www.iChemEg.com)  
Email : [info@ichemeg.com](mailto:info@ichemeg.com)

