

i110[®]

Description

The i110[®] roof expansion joint system accommodates multi-directional seismic movement and is installed with a 2x up stand mount.

Key Features

- **Install Condition:** Roof/Roof, Roof/Wall.
- **Joint width:** Manufactured according to site requirements.
- Optional fire rated.
- Seamlessly integrates with coordinating Wall system.
- Applicable for existing conditions, additions and new construction.
- Mill finish aluminum.

Materials

Aluminum: Alloy types of 6061-T6, 6063-T6, 6005A, or 5052-H32 sheet goods.

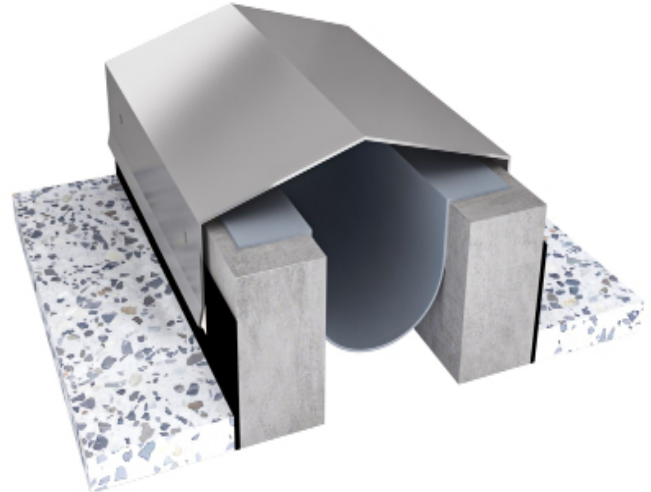

Application Instructions

Installation: Joint systems: Install in accordance with manufacturer's instructions.

Align work plumb, level and flush with adjacent surfaces. Mechanically anchor to substrate. Allowances should be made where actual structural gap at time of installation varies from nominal design gap. No shimming of frames is permitted. Coordinate with work of other Sections.

If concrete blockouts (rebates) are required, ensure continuous support equal to surrounding substrate structural values.

Fire Rated Assemblies: Where required, install to manufacturer's instructions.

Moisture Barrier: Where required, install to manufacturer's instructions.

i110[®]

Protect: the completed Expansion Control system work from damage during construction. Damage protection includes surface abrasion and overloading of coverplate by materials handling equipment and construction waste/debris. Protection from environmental factors required throughout installation process until Project Closeout. Protection includes but is not limited to rain events, moisture protection, exposure to temperature fluctuations or direct sunlight for temperature sensitive product offerings.

Store

Store components in original containers in a clean, dry location. Ensure temperature or moisture sensitive components are stored in a tempered location.

Contractor to provide temporary protective covers on all installed finished surfaces. Protection is required to guard against both surface abrasions as well as overloading of horizontal deck components by construction traffic.

Movement ± 50%

Application	System	W	H1	H2	S	Movement +/-		L
		Joint Width	Frame Height 1	Height 2	Sightline	Horizontal	Vertical	Load
		mm	mm	mm	mm	mm	mm	Kn
Roof to Roof		Manufactured according to site requirements						
Roof to Wall		Manufactured according to site requirements						

i110[®]

Series i110 - Roof to Roof

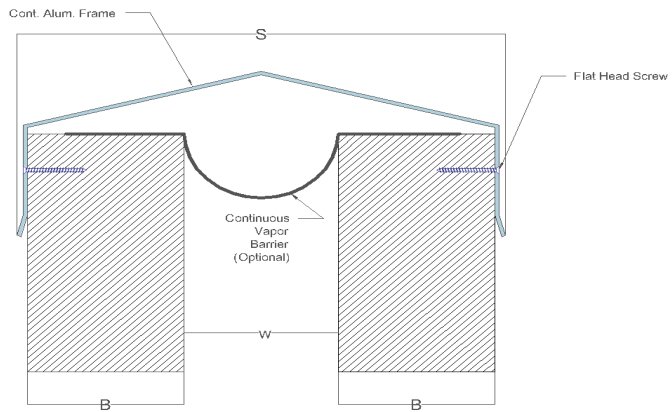

Series i110 C - Roof to Wall

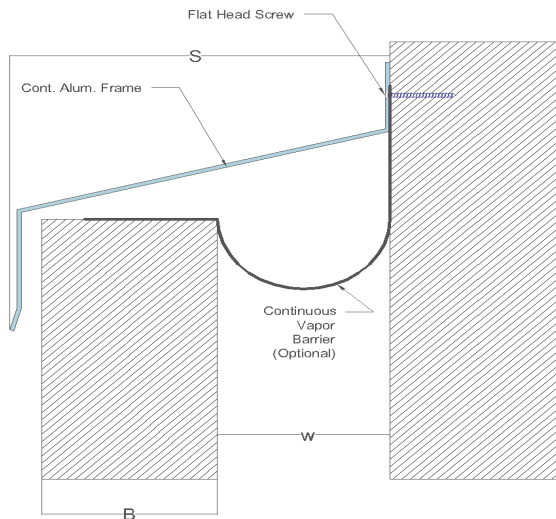

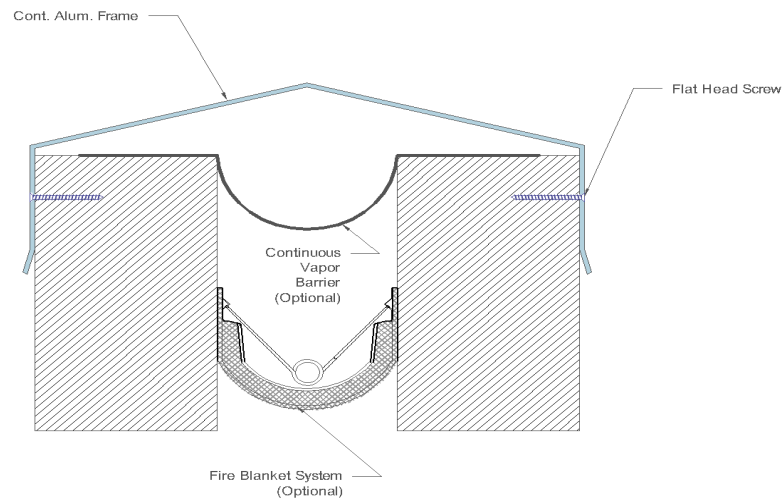

Series i110- FireStop S30 Options



i110[®]

Our Previous Submittals & Approvals

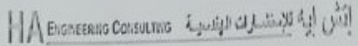
					
طلب اعتماد مواد Material Approval Request					
26/05/2024 MCC-MUST-MAR-AR-093-00 جامعة مصر العلوم والتكنولوجيا				التاريخ :- رقم الطلب :- مبنى :-	
<input type="checkbox"/> Other / اخرى		<input type="checkbox"/> As Built Dwg		<input checked="" type="checkbox"/> مواصفات فنية Specs	
<input type="checkbox"/> رسومات تشغيل work shop		<input type="checkbox"/> ميكانيكا		<input type="checkbox"/> كهرباء	
<input type="checkbox"/> معمارى		<input checked="" type="checkbox"/> إنشائى		<input type="checkbox"/>	
الشركة / المورد ICHEM		المرفقات : DATA SHEET + عينة		نوع المسند نوعية الاعمال	
طلب اعتماد عينات فواصل شركة ICHEM الشركة : ICHEM					
النتيجة الفحص		الوصف / البيان		م	
		(B) 1424 (LAND SCAPE)		1	
		(B) 1870 (فاصل الحوائط + الاسقف الجراجات)		2	
		(B) IFLEX CSW (فاصل الجراجات)		3	
		(B) 1110 (فاصل اسطح)		4	
				5	
MUST CONSTRUCTION COMPANY					
Name/الاسم : م / احسان فؤاد Signature/التوقيع :		مدير المشروع/المقاول Project Manager		Name/الاسم : Signature/التوقيع :	
Result / نتيجة الفحص					
Evaluation / التقييم				Date / تاريخ الاستلام :Receive	
مرفوض / Rejected D <input type="checkbox"/>	يعاد التقديم / Resubmit C <input type="checkbox"/>	معتمد بشروط / Approved as noted B <input type="checkbox"/>	معتمد / Approved A <input type="checkbox"/>	Receiver / المستلم :	
:Recommendation / القرار و التوصيات					
لقد فحصنا العينات المصنوعة من قبلك ونرى ان المواد المستخدمة في تصنيعها تتوافق مع المواصفات المطلوبة ويمكن استخدامها في المشروع المذكور في الجدول التالي.					
اننا نوصي باستخدامها في المشروع المذكور في الجدول التالي.					
اننا نوصي باستخدامها في المشروع المذكور في الجدول التالي.					
اننا نوصي باستخدامها في المشروع المذكور في الجدول التالي.					
: Project Consultant/المشرف على المشروع					
Name/الاسم : Signature/التوقيع : Date/التاريخ :		مدير المشروع Project Manager		Name/الاسم : Signature/التوقيع : Date/التاريخ :	
				المشرف على المشروع Consultant	

LMD[°] **LMS CONSTRUCTION** *360 Project* **HILL International**

MATERIAL SUBMITTAL FORM - (MAR)

Contract No: PEG - 1156 Package No.: CP01

TO: Eng. Mohamed Shehata
Project Manager, Hill International

FROM: ENG. Mohamed sherif
Project manager LMS Construction

TITLE: Expansion Joints (STC)

SUBMITTAL NO.: PEG-1156-CP01-CN-LS-MAR-0354

REVISION NO.: Rev. 00

SUBMISSION DATE: 26/02/2024

C/REF.:

MATERIAL SUBMISSION DESCRIPTION

Discipline: Architecture

Description of Material: Construction Joints

Manufacturer (Name & Address): STC

Specification:

Supplier / Local Agent: STC

BOQ Ref:

Description of Attachments:

- Area of application
- Technical data sheet i320-50(Floor to Floor)
- Technical data sheet for i840-50(Floor to Floor) Heavy duty
- Technical data sheet for i870-50(Wall to Wall)- Interior & Exterior
- Technical data sheet for i320-C-50(Floor to Wall)
- Technical data sheet for i110-C-50(Roof to wall)
- Technical data sheet for fire sealant
- Technical data sheet for backing rod.
- Technical data sheet for non-fire sealant
- Technical data sheet for vapor barrier
- Previous approvals for I chem profiles

Description of Samples: N/A

Specification Comparison Sheet:

Comparison in case of Alternative Submittal:

Prepared by: Ramiz Mikhael
Designation: Department

for Ramiz
Signed by Sender

Mohamed sherif
Project manager

Signed by Sender

Hill Receive:

RECEIVED
26 FEB 2024
Hill International
360 PROJECT

Consultant Receive:

Date: 26 Feb 2024

Sabbour

Returned From Consultant:

RECEIVED
04 MAR 2024
Hill International
360 PROJECT

Contractor Receive:

4/3

Page 1 of 13

Doc./Form No: PEG-1156-PP-02-06-FM Rev
Revision Date: February-20

Document Control & Archiving Procedures
Project

i110 Submittal - January 2025, Version 1.2.2

