



ichem<sup>®</sup>  
building solutions

EXPANSION JOINT  
SOLUTIONS

## ichem Introduction

ichem<sup>®</sup> was established in Cairo, Egypt.

Team business with values that include: experience , do the right thing and work hard.

As the manufacturer, we verify that only the best products are shipped out to your project.

We constantly test and review our systems for continuous innovation to provide you with the best solutions.

Yeah, we're obsessed, but in a good way ichem<sup>®</sup> classified as a class A contractor and have built a strong reputation and growing business in Egypt.

we are able to undertake multidisciplinary projects of scale and complexity.

Fast growth in business and revenue is a testimony to our proven capability to deliver quality products and services with speed and cost effectiveness.

EXPANSION JOINT  
SOLUTIONS

# ichem

## Welcome to ichem<sup>®</sup>

A trailblazer in the construction industry, where innovation, expertise, and unwavering commitment converge to redefine the standards of excellence.

As a distinguished provider of construction solutions, we take pride in delivering cutting-edge products designed to elevate your projects to unprecedented levels of success.

**Why Choose ichem® for Your Construction Endeavors:**

Elevate your projects with our avant-garde construction chemicals solutions. Our portfolio includes state-of-the-art admixtures and expertly formulated joint sealants that not only meet but exceed industry standards, ensuring the durability, resilience, and longevity of your structures.

**Our Journey – Shaping the Future of Construction:**

ichem® was founded with a vision to not just meet but exceed construction standards. Throughout our journey, we have consistently pushed boundaries, set industry benchmarks, and introduced cutting-edge construction chemicals that redefine what's possible in construction





## FLOOR SYSTEMS

▪ i210	▪ i322	▪ i330	▪ i336	▪ i830	▪ i890
▪ i314	▪ i325	▪ i331	▪ i412	▪ i831	▪ i920
▪ i320	▪ i326	▪ i332	▪ i510	▪ i840	
▪ i321	▪ i327	▪ i335	▪ i520	▪ i845	

## WALL + CEILING SYSTEMS

▪ i315	▪ i710	▪ i870
▪ i317	▪ i730	
▪ i370	▪ i820	
▪ i371	▪ i821	

## EXTERIOR JOINT SYSTEM

▪ i110	▪ i424
▪ i120	▪ i720
▪ i130	▪ i750

## COMPRESSION SEALS

▪ iFlex CS
▪ iFlex CSW
▪ iFlex CSL

## FIRE + MOISTURE BARRIERS

▪ FS i1005	▪ iFlex EPDM	▪ iFlex RS
▪ FS i1010	▪ iFlex BR	
▪ iFlex PVC	▪ ChemSeal PU	

OUR  
PROJECT

## 3' SIXTY

Landmark Sabbour has assigned well-known international companies to design 360 Mall New Cairo, where you can find commercial, administrative, or medical units for sale, in a large area most of it is allocated to green spaces and landscapes, providing stunning views to all units.

Mall Three Sixty New Cairo consists of 11 distinctive buildings with unique divisions of the interior spaces that achieve maximum benefit from units, and each building consists of a ground floor and 3 upper floors, in which the activities of the Mall are separated.

Mall Three Sixty New Cairo is built over 12.5 acres, that has been used well to include multiple activities, services, and facilities.

## Location

New Cairo

## Client

LMD

## Consultant

SABOUR

## Contractor

LMS

## Quantities

7620 M

## iChem products used

I320 Floor systems  
I870 Wall Systems



FLOOR SYSTEM

i210<sup>®</sup>



Description

The **i210<sup>®</sup>** System is a recessed mount floor expansion joint system. can coordinate with your desired flooring finish.

Key Features

**Install Condition:** Floor/Floor, Floor/Wall.

**Joint width:** 25-150mm.

Dual durometer seal provides secure fit and optimal flexibility.

Adaptable to many finishes, including ceramic tile, marble, stone, vinyl tile and carpet.

Snap-fit design for easy on site assembly.

Optional vapor barrier Optional fire rated.

Mill finish aluminum.

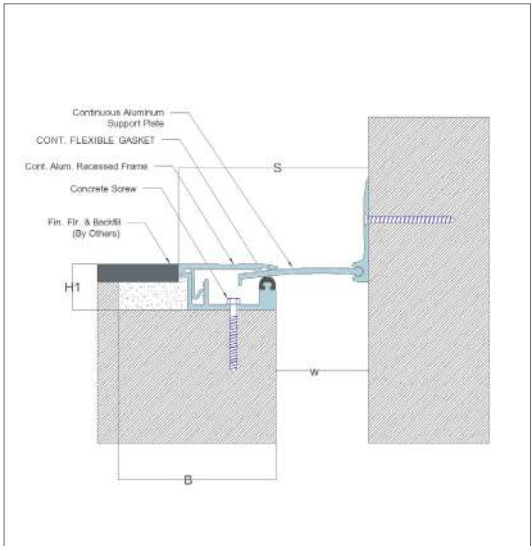
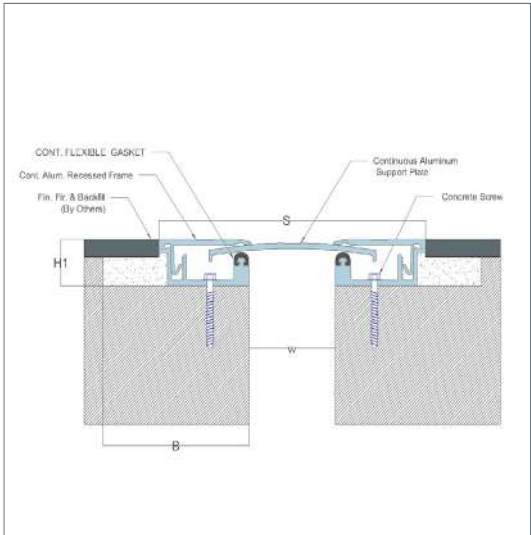

Movement ± 50%

Application	System	W	H1	H2	S	B	Movement +/-		Load
		Joint Width	Frame Height 1	Height 2	Sightline	Blockout	Horizontal	Vertical	
		mm	mm	mm	mm	mm	mm	mm	
Floor/Floor	i210-25	25	25	*	125	60	13	6	Pedestrian
	i210-50	50	25	*	155	60	25	13	Pedestrian
	i210-75	75	25	*	275	105	38	19	Pedestrian
	i210-100	100	25	*	300	105	50	25	Pedestrian
	i210-150	150	25	*	350	105	75	37	Pedestrian
Floor/Wall	i210-C-25	25	25	*	75	60	3	3	Pedestrian
	i210-C-50	50	25	*	100	60	10	6	Pedestrian
	i210-C-75	75	25	*	175	105	14	10	Pedestrian
	i210-C-100	100	25	*	200	105	19	13	Pedestrian
	i210-C-150	150	25	*	250	105	30	19	Pedestrian



## i314®



## Description

The **i314**® System is a surface mount floor expansion joint system. can coordinate with your desired flooring finish.

## Key Features

**Install Condition:** Floor/Floor, Floor/Wall.

**Joint width:** 25-50mm.

System is ideal for retrofit applications.

Designed to accommodate several different floor finishes such as tile, wood, or concrete.

Easy to clean flush seals, no dirt or water traps.

Standard and Custom seal colors available.

Dual durometer seal provides a secure fit and optimal flexibility.

Snap-fit design for easy on site assembly.

Standard loading capabilities.

Aluminum mill finish.

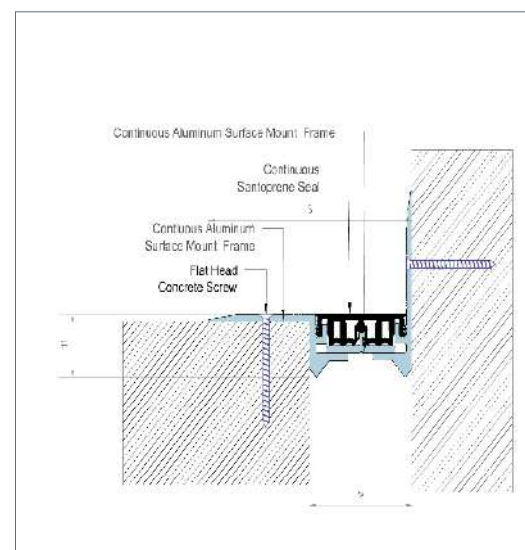
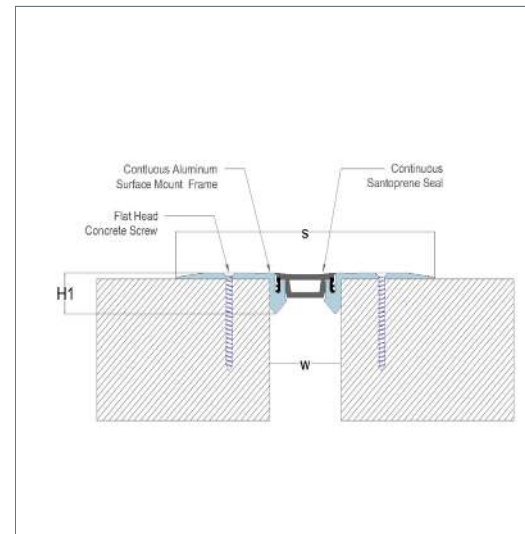

## Movement ± 25%

Application	System	W	H1	H2	S	B	Movement +/-		Load
		Joint Width	Frame Height 1	Height 2	Sightline	Blockout	Horizontal	Vertical	
		mm	mm	mm	mm	mm	mm	mm	
Floor/Floor	i314-25	25	16	*	120	*	6	6	Pedestrian
	i314-50	50	25	*	145	*	13	13	Pedestrian
Floor/Wall	i314-C-25	25	16	*	75	*	6	6	Pedestrian
	i314-C-50	50	25	*	95	*	13	13	Pedestrian

## i320®



## Description

The **i320**® System is a recessed mount floor expansion joint system. can coordinate with your desired flooring finish.

## Key Features

**Install Condition:** Floor/Floor, Floor/Wall.

**Joint width:** 25-75mm.

Recessed modular frames for minimal sight line.

Dual durometer seal provides secure fit and optimal flexibility .

Adaptable to many finishes, including ceramic tile, marble, stone, vinyl tile and carpet.

Seamlessly integrates with wall and ceiling systems.

Snap-fit design for easy on site assembly.

Easy to clean flush seals.

No dirt or water traps.

Optional vapor barrier Optional fire rated.

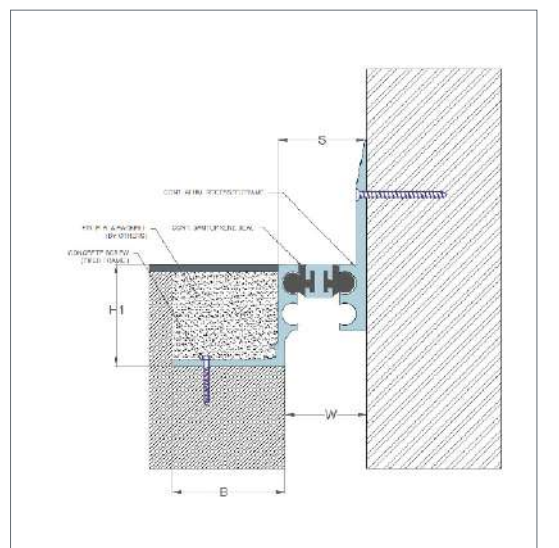
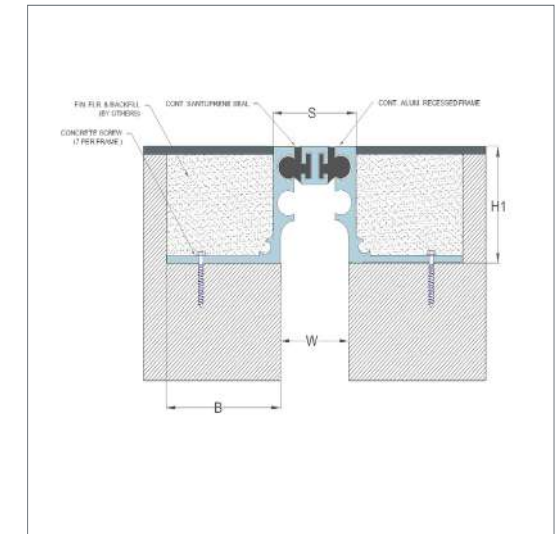

## Movement ± 25%

Application	System	W	H1	H2	S	B	Movement +/-		Load
		Joint Width	Frame Height 1	Height 2	Sightline	Blockout	Horizontal	Vertical	
		mm	mm	mm	mm	mm	mm	mm	
Floor/Floor	i320-25	25	49.4	*	38	48	10	10	Pedestrian
	i320-50	50	49.4	*	60	48	13	13	Pedestrian
	i320-75	75	49.4	*	80	48	19	19	Pedestrian
Floor/Wall	i320-C-25	25	49.4	*	38	48	10	10	Pedestrian
	i320-C-50	50	49.4	*	60	48	13	13	Pedestrian
	i320-C-75	75	49.4	*	80	48	19	19	Pedestrian

## i321®

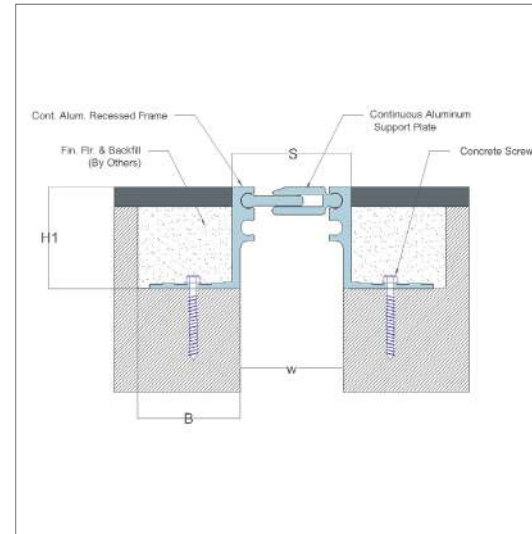

## Description

The **i321®** System is a recessed mount floor expansion joint system. can coordinate with your desired flooring finish.

## Key Features

**Install Condition:** Floor/Floor, Floor/wall.

**Joint width:** 38-75mm.

Recessed modular frames for minimal sight line.

Adaptable to many finishes, including ceramic tile, marble, stone, vinyl tile and carpet.

Seamlessly integrates with wall and ceiling systems.

Snap-fit design for easy on site assembly.

Easy to clean flush seals.

No dirt or water traps.

Optional vapor barrier Optional fire rated.

Mill finish aluminum.

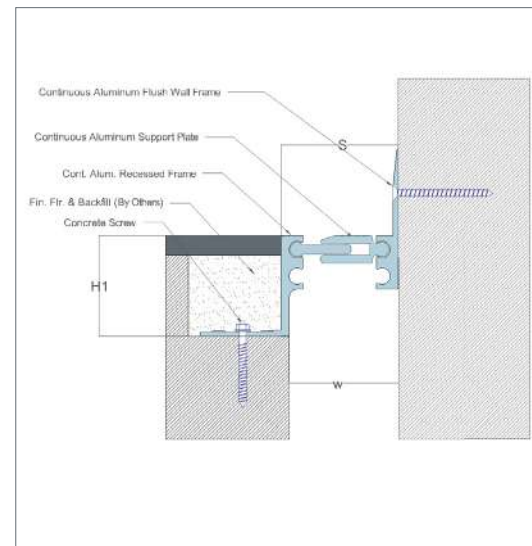

## Movement ± 25%

Application	System	W	H1	H2	S	B	Movement +/-		Load
		Joint Width	Frame Height 1	Height 2	Sightline	Blockout	Horizontal	Vertical	
		mm	mm	mm	mm	mm	mm	mm	
Floor/Floor	i321-38	38	49.4	*	38	48	10	10	Pedestrian
	i321-50	50	49.4	*	58	48	13	13	Pedestrian
	i321-75	75	49.4	*	83	48	19	19	Pedestrian
Floor/Wall	i321-C-38	38	49.4	*	38	48	10	10	Pedestrian
	i321-C-50	50	49.4	*	58	48	13	13	Pedestrian
	i321-C-75	75	49.4	*	83	48	19	19	Pedestrian

## i322®

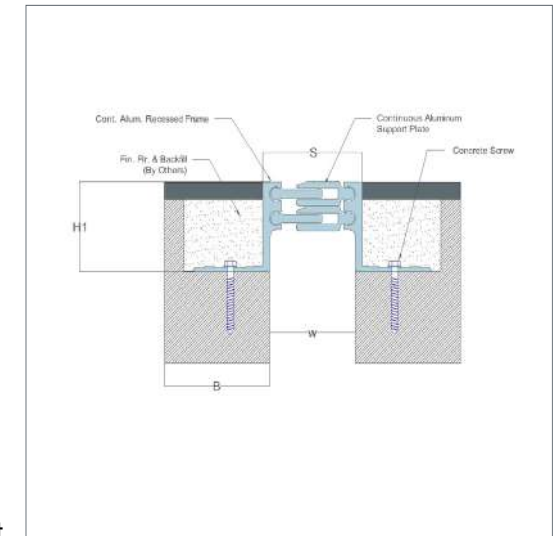

## Description

The **i322®** System is a recessed mount floor expansion joint system. can coordinate with your desired flooring finish.

## Key Features

**Install Condition:** Floor/Floor, Floor/wall.

**Joint width:** 38-75mm.

Recessed modular frames for minimal sight line.

Adaptable to many finishes, including ceramic tile, marble, stone, vinyl tile and carpet.

Seamlessly integrates with wall and ceiling systems.

Snap-fit design for easy on site assembly.

Easy to clean flush seals.

No dirt or water traps.

Optional vapor barrier Optional fire rated.

Mill finish aluminum.

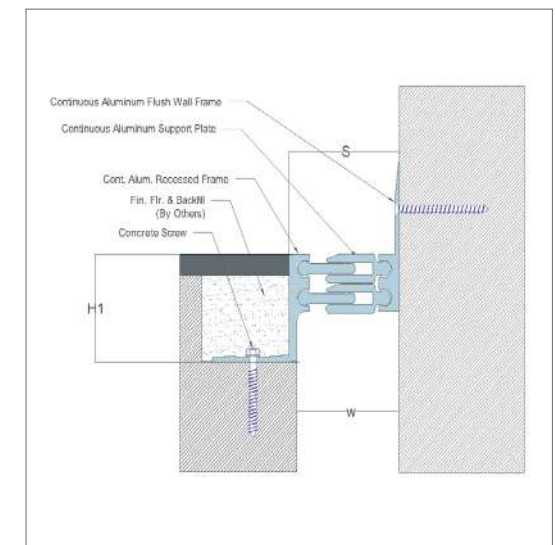

## Movement ± 25%

Application	System	W	H1	H2	S	B	Movement +/-		Load
		Joint Width	Frame Height 1	Height 2	Sightline	Blockout	Horizontal	Vertical	
		mm	mm	mm	mm	mm	mm	mm	
Floor/Floor	i322-38	38	49.4	*	38	48	10	10	Vehicle
	i322-50	50	49.4	*	58	48	13	13	Vehicle
	i322-75	75	49.4	*	83	48	19	19	Vehicle
Floor/Wall	i322-C-38	38	49.4	*	38	48	10	10	Vehicle
	i322-C-50	50	49.4	*	58	48	13	13	Vehicle
	i322-C-75	75	49.4	*	83	48	19	19	Vehicle



## i325®

**Description**

The **i325®** System is a surface mount floor expansion joint system. can coordinate with your desired flooring finish.

**Key Features**

**Install Condition:** Floor/Floor, Floor/wall.

**Joint width:** 38-75mm.

Recessed modular frames for minimal sight line.

Adaptable to many finishes, including ceramic tile, marble, stone, vinyl tile and carpet.

Seamlessly integrates with wall and ceiling systems.

Snap-fit design for easy on site assembly.

Easy to clean flush seals.

No dirt or water traps.

Optional vapor barrier Optional fire rated.

Mill finish aluminum.

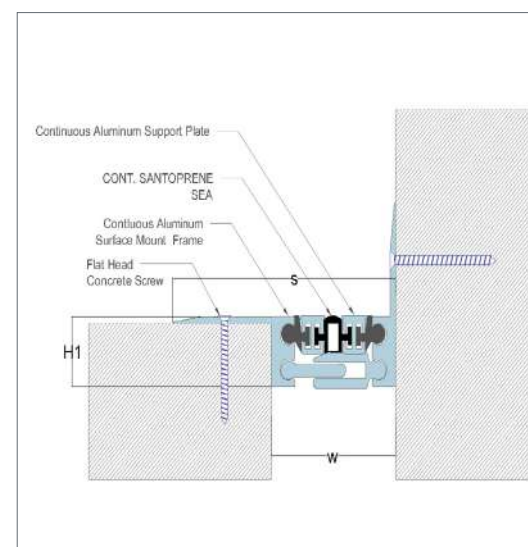
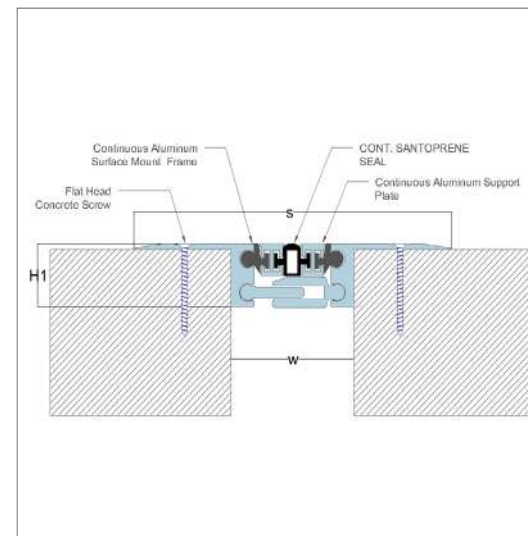
**Movement ± 25%**

Application	System	W	H1	H2	S	B	Movement +/-		Load
		Joint Width	Frame Height 1	Height 2	Sightline	Blockout	Horizontal	Vertical	
		mm	mm	mm	mm	mm	mm	mm	
Floor/Floor	i325-38	38	27	*	138	*	10	10	Pedestrian
	i325-50	50	27	*	150	*	13	13	Pedestrian
	i325-75	75	27	*	175	*	19	19	Pedestrian
Floor/Wall	i325-C-38	38	27	*	90	*	10	10	Pedestrian
	i325-C-50	50	27	*	103	*	13	13	Pedestrian
	i325-C-75	75	27	*	116	*	19	19	Pedestrian

## i326®

**Description**

The **i326®** System is a surface mount floor expansion joint system. can coordinate with your desired flooring finish.

**Key Features**

**Install Condition:** Floor/Floor, Floor/wall.

**Joint width:** 38-75mm.

Recessed modular frames for minimal sight line.

Adaptable to many finishes, including ceramic tile, marble, stone, vinyl tile and carpet.

Seamlessly integrates with wall and ceiling systems.

Snap-fit design for easy on site assembly.

Easy to clean flush seals.

No dirt or water traps.

Optional vapor barrier Optional fire rated.

Mill finish aluminum.

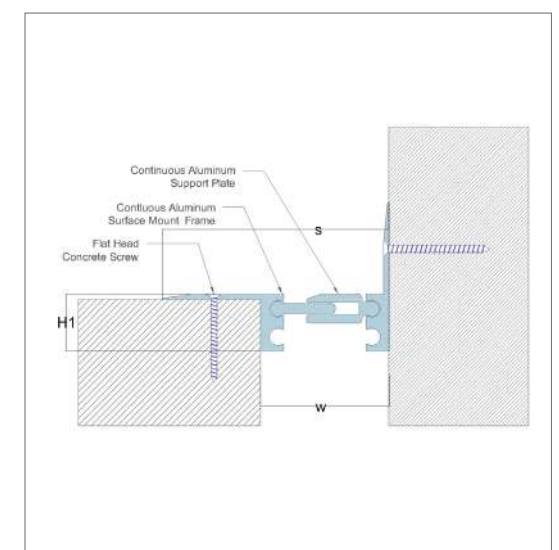
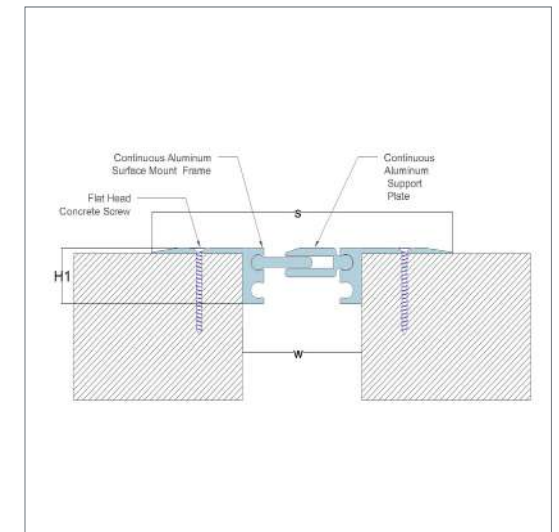
**Movement ± 25%**

Application	System	W	H1	H2	S	B	Movement +/-		Load
		Joint Width	Frame Height 1	Height 2	Sightline	Blockout	Horizontal	Vertical	
		mm	mm	mm	mm	mm	mm	mm	
Floor/Floor	i326-38	38	27	*	138	*	10	10	Pedestrian
	i326-50	50	27	*	150	*	13	13	Pedestrian
	i326-75	75	27	*	175	*	19	19	Pedestrian
Floor/Wall	i326-C-38	38	27	*	90	*	10	10	Pedestrian
	i326-C-50	50	27	*	103	*	13	13	Pedestrian
	i326-C-75	75	27	*	116	*	19	19	Pedestrian



## i327®



## Description

The **i327®** System is a surface mount floor expansion joint system. can coordinate with your desired flooring finish.

## Key Features

**Install Condition:** Floor/Floor, Floor/wall.

**Joint width:** 38-75mm.

Recessed modular frames for minimal sight line.

Adaptable to many finishes, including ceramic tile, marble, stone, vinyl tile and carpet.

Seamlessly integrates with wall and ceiling systems.

Snap-fit design for easy on site assembly.

Easy to clean flush seals.

No dirt or water traps.

Optional vapor barrier Optional fire rated.

Mill finish aluminum.

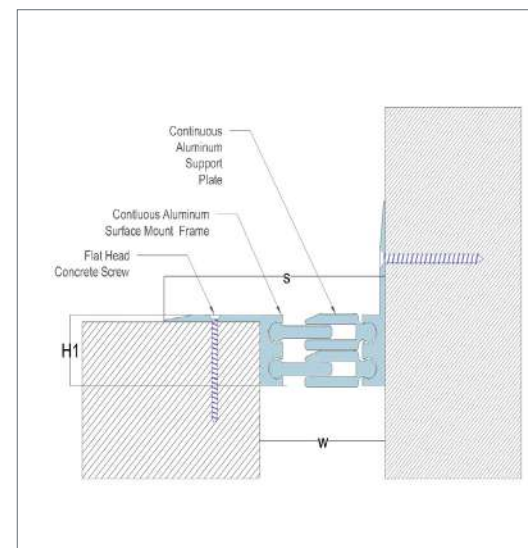
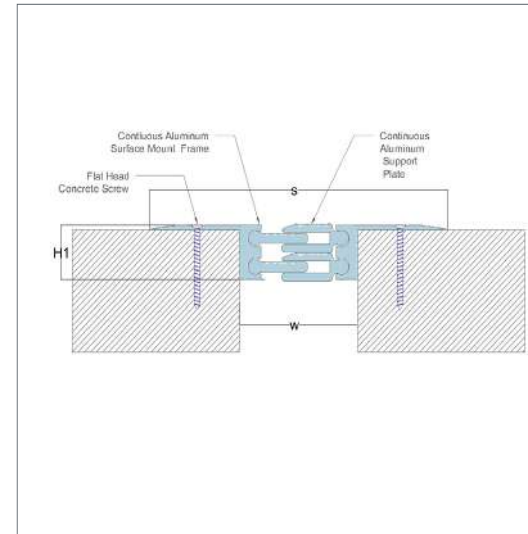

## Movement ± 25%

Application	System	W	H1	H2	S	B	Movement +/-		Load
		Joint Width	Frame Height 1	Height 2	Sightline	Blockout	Horizontal	Vertical	
		mm	mm	mm	mm	mm	mm	mm	
Floor/Floor	i327-38	38	27	*	138	*	10	10	Vehicle
	i327-50	50	27	*	150	*	13	13	Vehicle
	i327-75	75	27	*	175	*	19	19	Vehicle
Floor/Wall	i327-C-38	38	27	*	90	*	10	10	Vehicle
	i327-C-50	50	27	*	103	*	13	13	Vehicle
	i327-C-75	75	27	*	116	*	19	19	Vehicle

## i330®



## Description

The **i330®** System is a recessed mount floor expansion joint system. can coordinate with your desired flooring finish.

## Key Features

**Install Condition:** Floor/Floor, Floor/Wall.

**Joint width:** 25-50mm.

Recessed modular frames for minimal sight line.

Dual durometer seal provides secure fit and optimal flexibility.

Adaptable to many finishes, including ceramic tile, marble, stone, vinyl tile and carpet.

Seamlessly integrates with wall and ceiling systems.

Snap-fit design for easy on site assembly.

Easy to clean flush seals.

No dirt or water traps.

Optional vapor barrier Optional fire rated.

Mill finish aluminum.

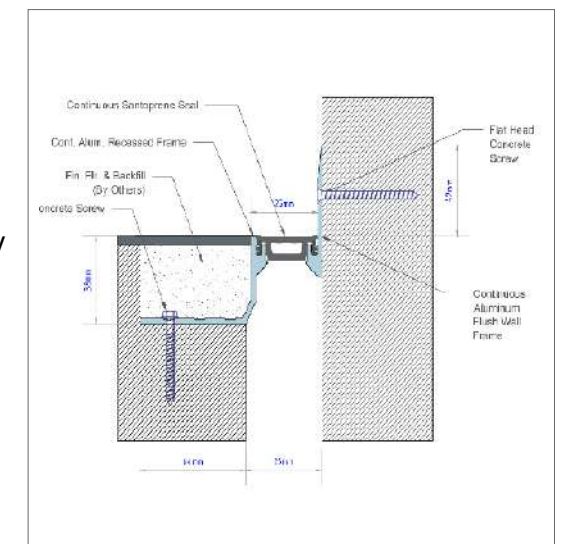
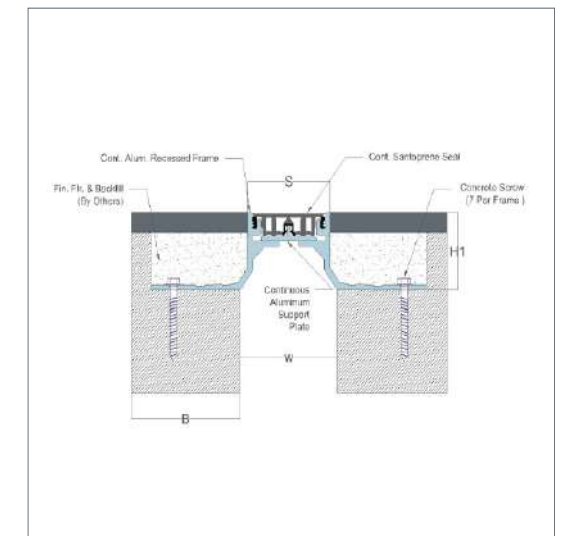

## Movement ± 25%

Application	System	W	H1	H2	S	B	Movement +/-		Load
		Joint Width	Frame Height 1	Height 2	Sightline	Blockout	Horizontal	Vertical	
		mm	mm	mm	mm	mm	mm	mm	
Floor/Floor	i330-25	25	38	*	28	64	6	6	Pedestrian
	i330-50	50	38	*	50	64	13	13	Pedestrian
Floor/Wall	i330-C-25	25	38	*	28	64	6	6	Pedestrian
	i330-C-50	50	38	*	50	64	13	13	Pedestrian

## i331®



## Description

The **i331®** System is a recessed mount floor expansion joint system. can coordinate with your desired flooring finish.

## Key Features

**Install Condition:** Floor/Floor, Floor/Wall.

**Joint width:** 25-50mm.

Recessed modular frames for minimal sight line.

Dual durometer seal provides secure fit and optimal flexibility.

Adaptable to many finishes, including ceramic tile, marble, stone, vinyl tile and carpet.

Seamlessly integrates with wall and ceiling systems.

Snap-fit design for easy on site assembly.

Easy to clean flush seals.

No dirt or water traps.

Optional vapor barrier Optional fire rated.

Mill finish aluminum.

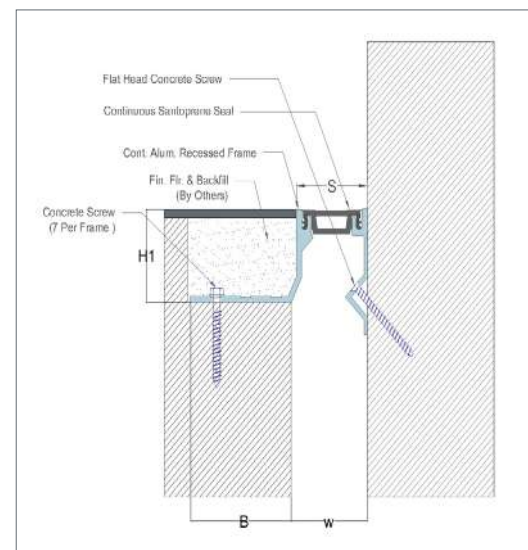
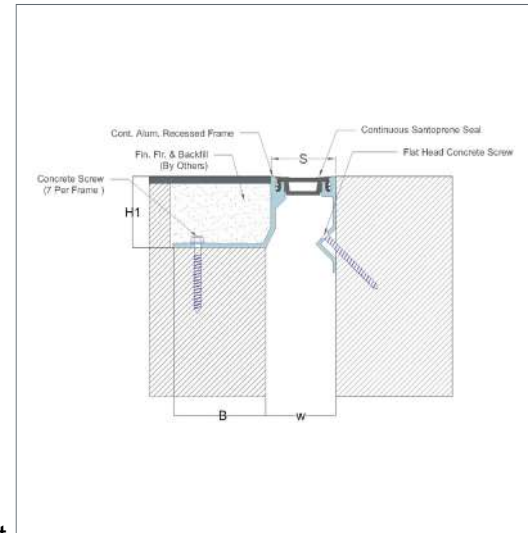

## Movement ± 25%

Application	System	W	H1	H2	S	B	Movement +/-		Load
		Joint Width	Frame Height 1	Height 2	Sightline	Blockout	Horizontal	Vertical	
		mm	mm	mm	mm	mm	mm	mm	
Floor/Floor	i331-25	25	38	*	25	64	6	6	Pedestrian
	i331-50	50	38	*	50	64	13	13	Pedestrian
Floor/Wall	i331-C-25	25	38	*	25	64	6	6	Pedestrian
	i331-C-50	50	38	*	50	64	13	13	Pedestrian

## i332®



## Description

The **i332®** System is a surface mount floor expansion joint system. can coordinate with your desired flooring finish.

## Key Features

**Install Condition:** Floor/Floor.

**Joint width:** 25-50mm.

Recessed modular frames for minimal sight line.

Dual durometer seal provides secure fit and optimal flexibility.

Adaptable to many finishes, including ceramic tile, marble, stone, vinyl tile and carpet.

Seamlessly integrates with wall and ceiling systems.

Snap-fit design for easy on site assembly.

Easy to clean flush seals.

No dirt or water traps.

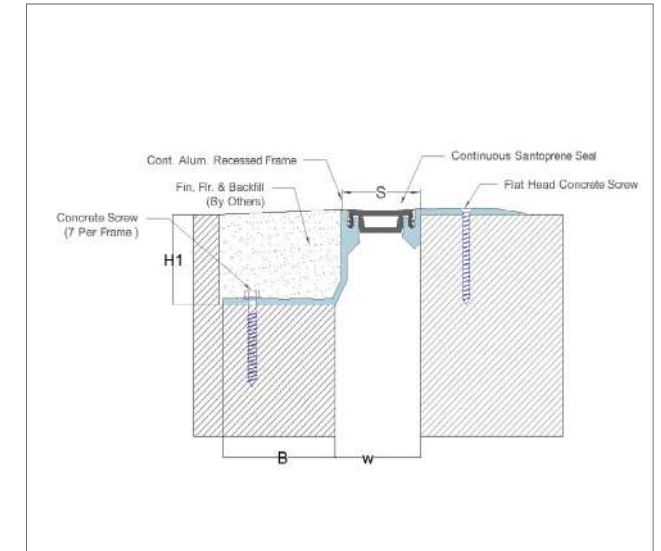

## Movement ± 25%

Application	System	W	H1	H2	S	B	Movement +/-		Load
		Joint Width	Frame Height 1	Height 2	Sightline	Blockout	Horizontal	Vertical	
		mm	mm	mm	mm	mm	mm	mm	
Floor/Floor	i332-25	25	38	*	25	64	6	6	Pedestrian
	i332-50	50	38	*	50	64	13	13	Pedestrian



## i335®

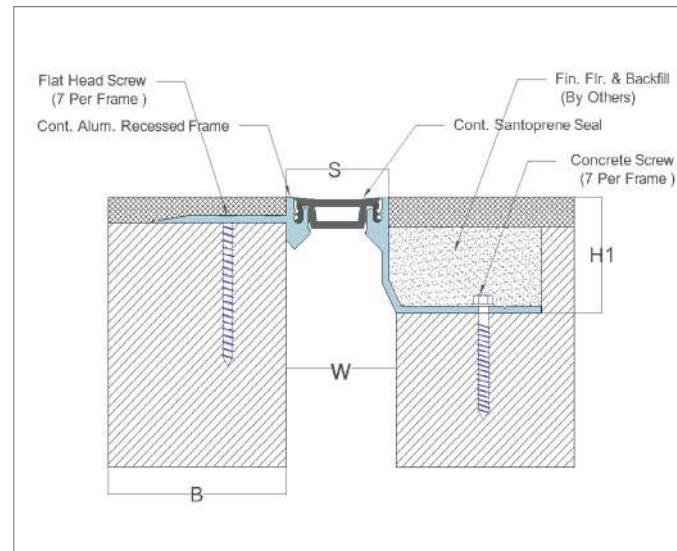

## Description

The **i335®** System is a surface mount floor expansion joint system. can coordinate with your desired flooring finish.

## Key Features

**Install Condition:** Floor/Floor.

**Joint width:** 25-50mm.

Recessed modular frames for minimal sight line.

Dual durometer seal provides secure fit and optimal flexibility.

Seamlessly integrates with wall and ceiling systems.

Snap-fit design for easy on site assembly.

Easy to clean flush seals.

No dirt or water traps.

Optional vapor barrier Optional fire rated.

Mill finish aluminum.

## Movement ± 25%

Application	System	W	H1	H2	S	B	Movement +/-		Load
		Joint Width	Frame Height 1	Height 2	Sightline	Blockout	Horizontal	Vertical	
		mm	mm	mm	mm	mm	mm	mm	
Floor/Floor	i335-25	25	38	3	25	64	6	6	Pedestrian
	i335-50	50	38	3	50	64	13	13	Pedestrian

## i336®

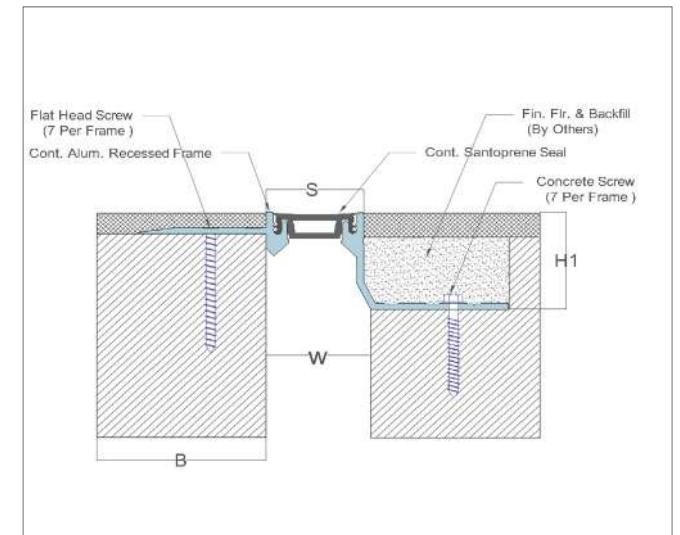

## Description

The **i336®** System is a surface mount floor expansion joint system. can coordinate with your desired flooring finish.

## Key Features

**Install Condition:** Floor/Floor.

**Joint width:** 25-50mm.

Recessed modular frames for minimal sight line.

Dual durometer seal provides secure fit and optimal flexibility.

Seamlessly integrates with wall and ceiling systems.

Snap-fit design for easy on site assembly.

Easy to clean flush seals.

No dirt or water traps.

Optional vapor barrier Optional fire rated.

Mill finish aluminum.

## Movement ± 25%

Application	System	W	H1	H2	S	B	Movement +/-		Load
		Joint Width	Frame Height 1	Height 2	Sightline	Blockout	Horizontal	Vertical	
		mm	mm	mm	mm	mm	mm	mm	
Floor/Floor	i336-25	25	38	6	25	64	6	6	Pedestrian
	i336-50	50	38	6	50	64	13	13	Pedestrian

## i412®



## Description

The **i412®** floor expansion joint system is a pan system designed for generous thermal and seismic movement requirements and narrow sight lines that minimize aesthetic disruption to flooring finishes.

## Key Features

**Install Condition:** Floor/Floor, Floor/Wall.

**Joint width:** 50-350mm.

Optional fire rated.

Seamlessly integrates with coordinating Wall system.

Anti-slip surface serrations.

Applicable for existing conditions, additions and new construction.

Mill finish aluminum.

## Movement ± 50%

Application	System	W	H1	H2	S	B	Movement +/-		Load
		Joint Width	Frame Height 1	Height 2	Sightline	Blockout	Horizontal	Vertical	
		mm	mm	mm	mm	mm	mm	mm	
Floor to Floor	i412-50	50	53.5	*	65	125	25	50	Pedestrian
	i412-100	100	53.5	*	65	125	50	50	Pedestrian
	i412-150	150	53.5	*	65	125	75	50	Pedestrian
	i412-200	200	53.5	*	65	140	100	50	Pedestrian
	i412-250	250	53.5	*	65	175	125	50	Pedestrian
	i412-300	300	53.5	*	65	200	150	50	Pedestrian
	i412-350	350	53.5	*	65	200	175	50	Pedestrian
Floor to Wall	i412-C-50	50	53.5	*	32	175	15	50	Pedestrian
	i412-C-100	100	53.5	*	32	150	25	50	Pedestrian
	i412-C-150	150	53.5	*	32	125	35	50	Pedestrian
	i412-C-200	200	53.5	*	32	140	50	50	Pedestrian
	i412-C-250	250	53.5	*	32	175	65	50	Pedestrian
	i412-C-300	300	53.5	*	32	200	80	50	Pedestrian
	i412-C-350	350	53.5	*	32	200	95	50	Pedestrian

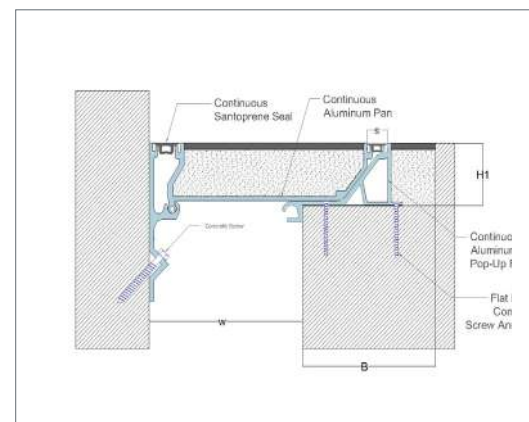
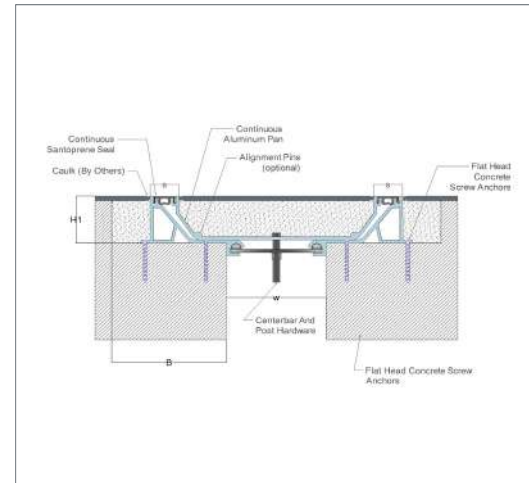

## i510®



## Description

The **i510®** floor expansion joint is a heavy duty system designed for generous thermal and seismic movement for flooring finishes.

## Key Features

**Install Condition:** Floor/Floor, Floor/Wall.

**Joint width:** 50-350mm.

Optional fire rated.

Seamlessly integrates with coordinating Wall system.

Anti-slip surface serrations.

Applicable for existing conditions, additions and new construction.

Mill finish aluminum.

Stainless steel: Alloy types of 304 or 316.

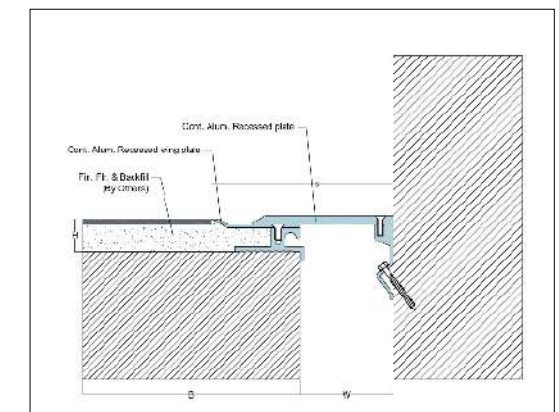
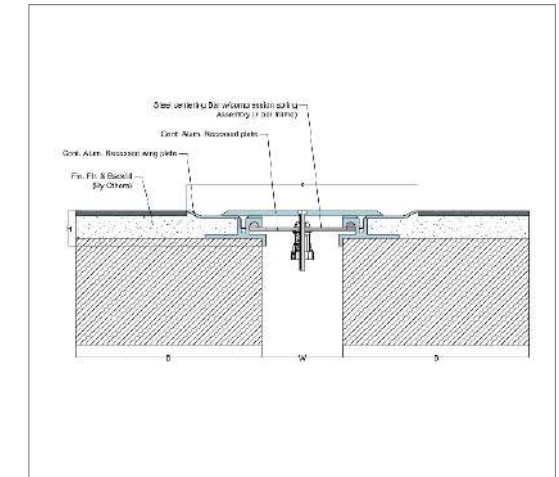

## Movement ± 50%

Application	System	W	H1	H2	S	B	Movement +/-		L
		Joint Width	Frame Height 1	Height 2	Sightline	Blockout	Horizontal	Vertical	
		mm	mm	mm	mm	mm	mm	mm	
Floor to Floor	i510-50	50	35	*	300	120	25	50	Truck
	i510-100	100	35	*	300	120	50	50	Truck
	i510-150	150	35	*	375	130	75	50	Truck
	i510-200	200	35	*	450	145	100	50	Truck
	i510-250	250	35	*	500	145	125	50	Truck
	i510-300	300	35	*	630	190	150	50	Truck
	i510-350	350	35	*	705	190	175	50	Truck
Floor to Wall	i510-C-50	50	35	*	32	175	15	50	Truck
	i510-C-100	100	35	*	32	150	25	50	Truck
	i510-C-150	150	35	*	32	125	35	50	Truck
	i510-C-200	200	35	*	32	140	50	50	Truck
	i510-C-250	250	35	*	32	175	65	50	Truck
	i510-C-300	300	35	*	32	200	80	50	Truck
	i510-C-350	350	35	*	32	200	95	50	Truck



## i520®

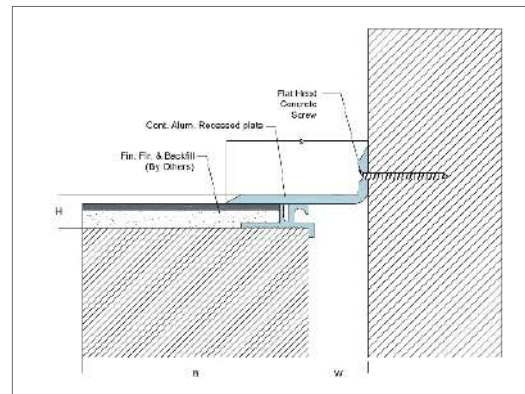
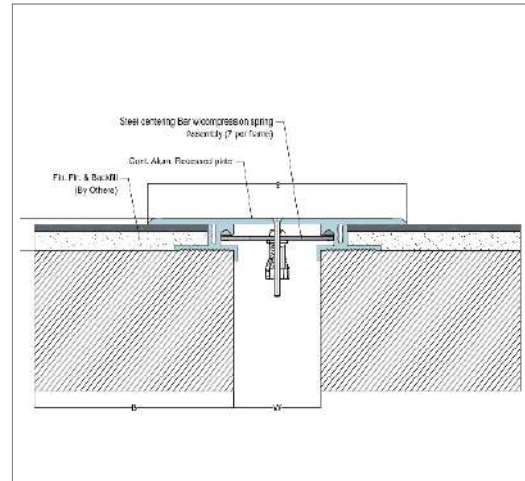

## Description

The **i520®** floor expansion joint is a heavy duty system designed for generous thermal and seismic movement for flooring finishes.

## Key Features

**Install Condition:** Floor/Floor, Floor/Wall.

**Joint width:** 50-350mm.

Optional fire rated.

Seamlessly integrates with coordinating Wall system.

Anti-slip surface serrations.

Applicable for existing conditions, additions and new construction.

Mill finish aluminum.

Stainless steel: Alloy types of 304 or 316.

## Movement ± 50%

Application	System	W	H1	H2	S	B	Movement +/-		L
		Joint Width	Frame Height 1	Height 2	Sightline	Blockout	Horizontal	Vertical	
		mm	mm	mm	mm	mm	mm	mm	
Floor to Floor	i520-50	50	32	*	300	120	25	50	Truck
	i520-100	100	32	*	300	120	50	50	Truck
	i520-150	150	32	*	375	130	75	50	Truck
	i520-200	200	32	*	450	145	100	50	Truck
	i520-250	250	32	*	500	145	125	50	Truck
	i520-300	300	32	*	630	190	150	50	Truck
	i520-350	350	32	*	705	190	175	50	Truck
Floor to Wall	i520-C-50	50	32	*	32	175	15	50	Truck
	i520-C-100	100	32	*	32	150	25	50	Truck
	i520-C-150	150	32	*	32	125	35	50	Truck
	i520-C-200	200	32	*	32	140	50	50	Truck
	i520-C-250	250	32	*	32	175	65	50	Truck
	i520-C-300	300	32	*	32	200	80	50	Truck
	i520-C-350	350	32	*	32	200	95	50	Truck

## i830®

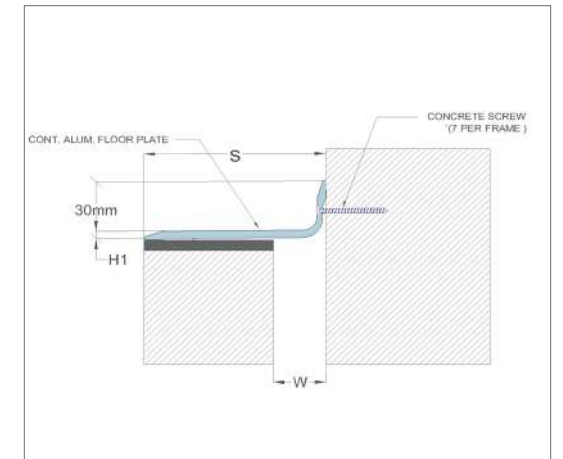
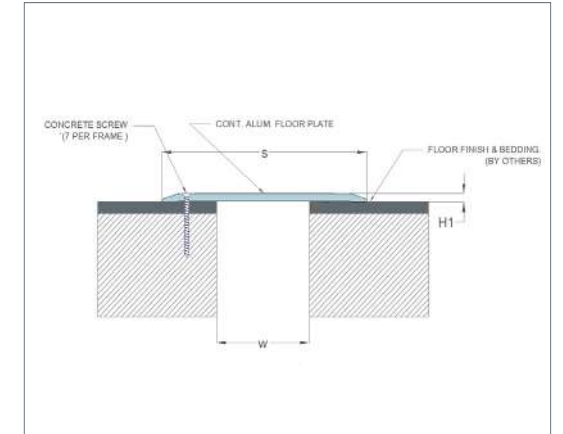

## Description

The **i830®** System is a Designed for interior and exterior floor and wall.

## Key Features

**Install Condition:** Floor/Floor, Floor/Wall .

**Joint width:** 25-150mm.

Optional fire rated.

Seamlessly integrates with coordinating **i820®** Wall system.

Flush mount interior and exterior systems reduce sightline.

Adaptable to many finishes, including ceramic tile, marble, stone.

Clear anodized finish.

## Movement ± 25%

Application	System	W	H1	H2	S	B	Movement +/-		Load
		Joint Width	Frame Height 1	Height 2	Sightline	Blockout	Horizontal	Vertical	
		mm	mm	mm	mm	mm	mm	mm	
Floor/Floor	i830-25	25	4	*	60	*	13	*	Pedestrian
	i830-38	38	4	*	80	*	19	*	Pedestrian
	i830-50	50	4	*	110	*	25	*	Pedestrian
	i830-75	75	4	*	150	*	38	*	Pedestrian
	i830-100	100	4	*	200	*	50	*	Pedestrian
	i830-125	125	4	*	250	*	65	*	Pedestrian
	i830-150	150	4	*	250	*	75	*	Pedestrian
	i830-C-25	25	4	*	70	*	13	*	Pedestrian
Floor/Wall	i830-C-38	38	4	*	70	*	19	*	Pedestrian
	i830-C-50	50	4	*	80	*	25	*	Pedestrian
	i830-C-75	75	4	*	120	*	38	*	Pedestrian
	i830-C-100	100	4	*	150	*	50	*	Pedestrian
	i830-C-125	125	4	*	220	*	65	*	Pedestrian
	i830-C-150	150	4	*	220	*	75	*	Pedestrian

## i831®

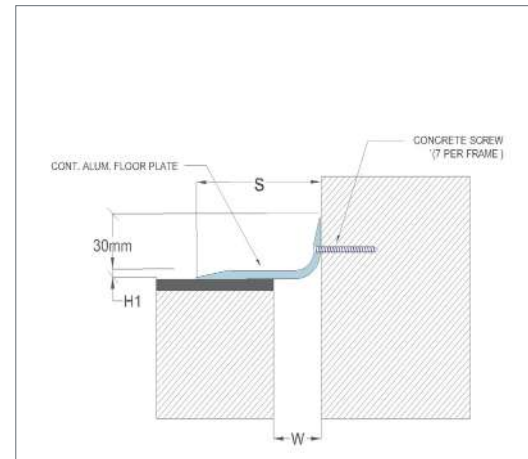
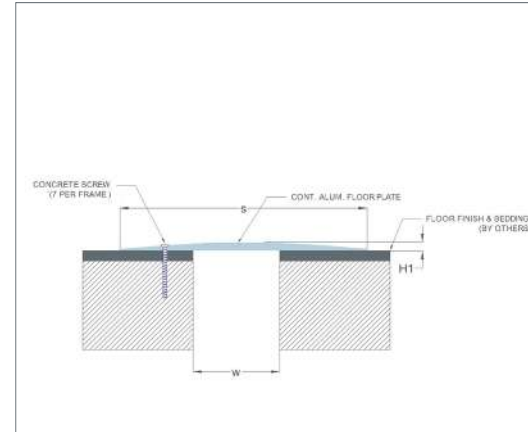
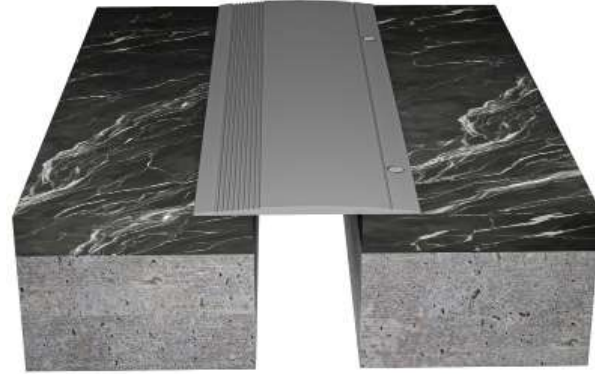
**Description**

The **i831®** System is a Designed for interior and exterior floor and wall.

**Key Features**

**Install Condition:** Floor/Floor, Floor/Wall .

**Joint width:** 25-150mm.

Optional fire rated.

Seamlessly integrates with coordinating Wall system.

Flush mount interior and exterior systems reduce sightline.

Adaptable to many finishes, including ceramic tile, marble, stone.

Clear anodized finish.

**Movement ± 25%**

Application	System	W	H1	H2	S	B	Movement +/-		Load
		Joint Width	Frame Height 1	Height 2	Sightline	Blockout	Horizontal	Vertical	
		mm	mm	mm	mm	mm	mm	mm	
Floor/Floor	i831-25	25	4	*	60	*	13	*	Pedestrian
	i831-38	38	4	*	80	*	19	*	Pedestrian
	i831-50	50	4	*	100	*	25	*	Pedestrian
	i831-75	75	4	*	145	*	38	*	Pedestrian
	i831-100	100	4	*	200	*	50	*	Pedestrian
	i831-125	125	4	*	250	*	65	*	Pedestrian
	i831-150	150	4	*	250	*	75	*	Pedestrian
Floor/Wall	i831-C-25	25	4	*	70	*	13	*	Pedestrian
	i831-C-38	38	4	*	70	*	19	*	Pedestrian
	i831-C-50	50	4	*	70	*	25	*	Pedestrian
	i831-C-75	75	4	*	115	*	38	*	Pedestrian
	i831-C-100	100	4	*	150	*	50	*	Pedestrian
	i831-C-125	125	4	*	200	*	65	*	Pedestrian
	i831-C-150	150	4	*	200	*	75	*	Pedestrian

## i840®

**Description**

The **i840®** floor expansion joint system is designed for uneven slab construction.

**Key Features**

**Install Condition:** Floor/Floor, Floor/Wall.

**Joint width:** 50-200mm.

Optional fire rated.

Seamlessly integrates with coordinating Wall system.

Anti-slip surface serrations.

Clear anodized finish.

Applicable for existing conditions, additions and new construction.

Mill finish aluminum.

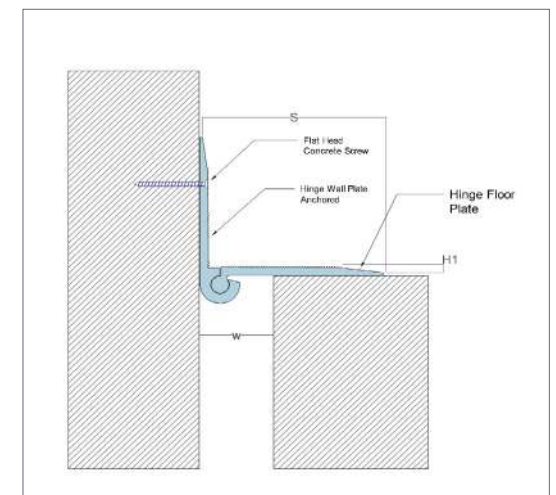
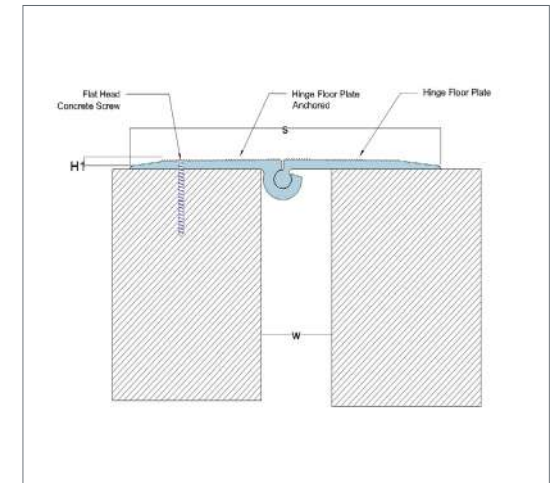

**Movement ± 25%**

Application	System	W	H1	H2	S	B	Movement +/-		Load
		Joint Width	Frame Height 1	Height 2	Sightline	Blockout	Horizontal	Vertical	
		mm	mm	mm	mm	mm	mm	mm	
Floor to Floor	i840-50	50	5	*	175	*	±25	-51 / +10	Vehicle
	i840-100	100	5	*	265	*	±50	-51 / +10	Vehicle
	i840-150	150	5	*	327	*	±75	-71 / +13	Vehicle
	i840-200	200	11	*	446	*	±100	-64 / +25	Vehicle
	i840-C-50	50	5	*	175	*	±25	-51 / +10	Vehicle
Floor to Wall	i840-C-100	100	5	*	265	*	±50	-51 / +10	Vehicle
	i840-C-150	150	5	*	330	*	±75	-71 / +13	Vehicle
	i840-C-200	200	11	*	450	*	±100	-64 / +25	Vehicle



## i845®

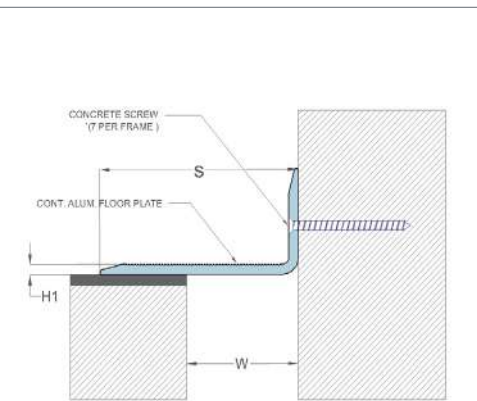
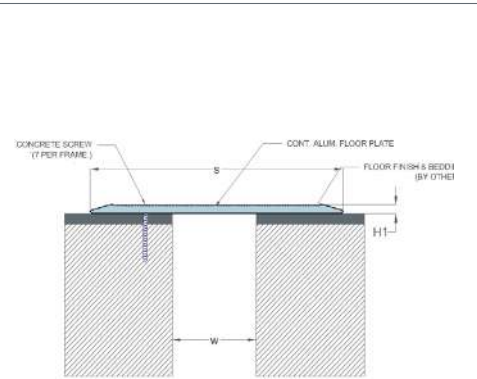

## Description

The **i845®** is a floor expansion joint system is designed for uneven slab construction.

## Key Features

**Install Condition:** Floor/Floor, Floor/Wall.

**Joint width:** 25-150mm.

Optional fire rated.

Seamlessly integrates with coordinating Wall system.

Anti-slip surface serrations.

Applicable for existing conditions, additions and new construction .

Mill finish aluminum.

## Movement ± 25%

Application	System	W	H1	H2	S	B	Movement +/-		Load
		Joint Width	Frame Height 1	Height 2	Sightline	Blockout	Horizontal	Vertical	
		mm	mm	mm	mm	mm	mm	mm	
Floor/Floor	i845-25	25	5	*	150	*	13	*	Vehicle
	i845-50	50	5	*	150	*	19	*	Vehicle
	i845-75	75	6	*	200	*	51	*	Vehicle
	i845-100	100	6	*	200	*	51	*	Vehicle
	i845-125	125	6	*	250	*	65	*	Vehicle
	i845-150	150	6	*	250	*	65	*	Vehicle
Floor/Wall	i845-C-25	25	5	*	100	*	13	*	Vehicle
	i845-C-50	50	5	*	100	*	19	*	Vehicle
	i845-C-75	75	5	*	150	*	25	*	Vehicle
	i845-C-100	100	5	*	150	*	51	*	Vehicle
	i845-C-125	125	6	*	220	*	65	*	Vehicle
	i845-C-150	150	6	*	220	*	65	*	Vehicle

## i890®

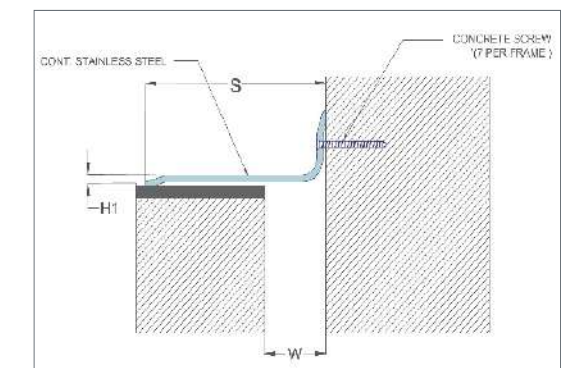
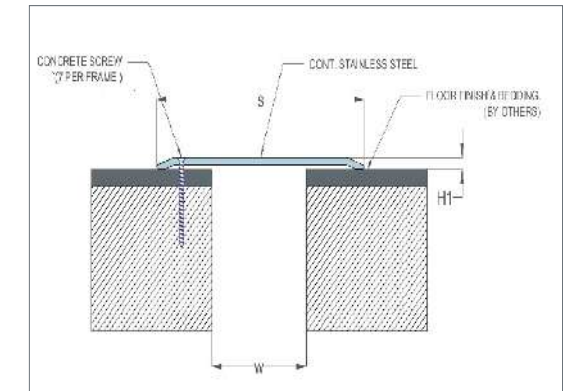

## Description

The **i890®** a System is a Designed for interior and exterior floor, wall And Ceiling.

## Key Features

Install Condition: floor, wall And Ceiling systems.

Joint width: 25-150mm.

Optional fire rated.

Flush mount interior and exterior systems reduce sightline.

Adaptable to many finishes, including ceramic tile, marble, stone.

The product is available in all PVD coating colors.

## Materials

Stainless steel: Alloy types of 304 or 316.

Thickness : 0.8 & 1.3 & 1.8 & 2.3 & 2.8.

## Movement ± 25%

Application	System	W	H1	H2	S	B	Movement +/-	
		Joint Width	Frame Height 1	Height 2	Sightline	Blockout	Horizontal	Vertical
		mm	mm	mm	mm	mm	mm	mm
Floor/Floor Wall/Wall	i890-25	25	*	*	60	*	13	*
	i890-38	38	*	*	80	*	19	*
	i890-50	50	*	*	110	*	25	*
	i890-75	75	*	*	200	*	38	*
	i890-100	100	*	*	200	*	50	*
	i890-125	125	*	*	250	*	65	*
Floor/Wall Wall/Corner	i890-150	150	*	*	250	*	75	*
	i890-C-25	25	*	*	50	*	13	*
	i890-C-38	38	*	*	70	*	19	*
	i890-C-50	50	*	*	80	*	25	*
	i890-C-75	75	*	*	150	*	38	*
	i890-C-100	100	*	*	150	*	50	*
	i890-C-125	125	*	*	220	*	65	*
	i890-C-150	150	*	*	220	*	75	*



i920®

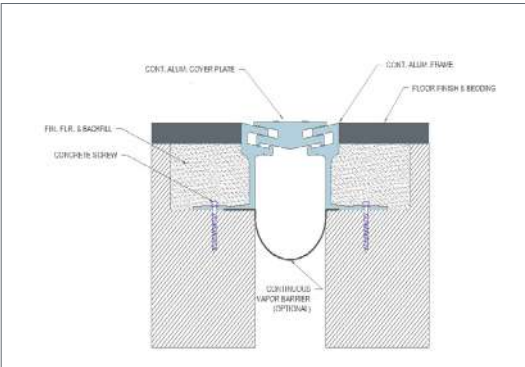
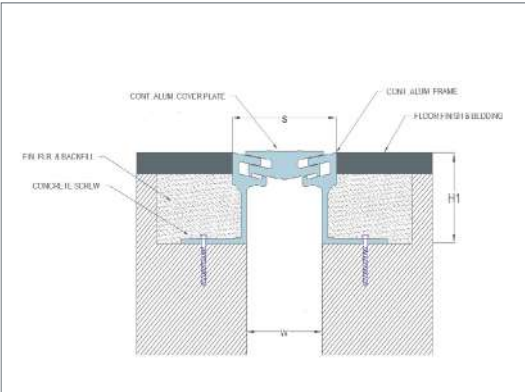

Description

The **i920®** floor expansion joint system is a cost effective solution for high load bearing spaces that encounter vehicular traffic such as parking garages, warehouses and more.

Key Features

- Install Condition:** Floor/Floor.
- Joint width:** 25-50mm.
- Designed with a crisp, narrow surface profile to minimize visual sightline.
- High loading capacity capable of withstanding heavy maintenance equipment.
- Self-Centering .
- Ideal for large Civil and Government projects.
- Alignment pins allow for easy continuous straight installation.
- Mill finish aluminum.

Movement ± 25%

System	W	H1	H2	S	B	Movement +/-		Load
	Joint Width	Frame Height 1	Height 2	Sightline	Blockout	Horizontal	Vertical	
	mm	mm	mm	mm	mm	mm	mm	
i920-25	25	50	*	34	57	6	*	Vehicle
i920-50	50	50	*	60	57	13	*	Vehicle

OUR PROJECT

MISR UNIVERSITY FOR SCIENCE & TECHNOLOGY (MUST)

Established in 1996, the Misr University for Science and Technology is a non-profit private higher education institution located in the medium city of 6th of October City (population range of 250,000-499,999 inhabitants), Giza.

Officially recognized by the Ministry of Higher Education of Egypt, Misr University for Science and Technology (MUST) is a large-sized (uniRank enrollment range: 20,000-24,999 students) coeducational Egyptian higher education institution.

MUST also provides several academic and non-academic facilities and services to students including a library, housing, sports facilities, financial aids and/or scholarships, study abroad and exchange programs, online courses and distance learning opportunities, as well as administrative services.



Location	6th of October
Client	Better Home
Consultant	Better Home
Contractor	Alshorouk - Redcon - Hueck - Alahram
Quantities	17,300 M
iChem products used	1330 Floor systems 1845 Floor systems i412 Exterior systems 1870 Wall systems





WALL + CEILING  
SYSTEMS

i315®



Description

The i315® System is a surface mount wall expansion joint system can coordinate with your desired walling finish.

Key Features

- Install Condition:** Wall/Wall, Wall to Corner.
- Joint width:** 25-50mm.
- System is ideal for retrofit applications.
- Designed to accommodate several different wall finishes such as tile, wood, or concrete.
- Easy to clean flush seals, no dirt or water traps.
- Standard and Custom seal colors available.
- Dual durometer seal provides a secure fit and optimal flexibility.
- Snap-fit design for easy on site assembly.
- Standard loading capabilities.
- Clear anodized finish.

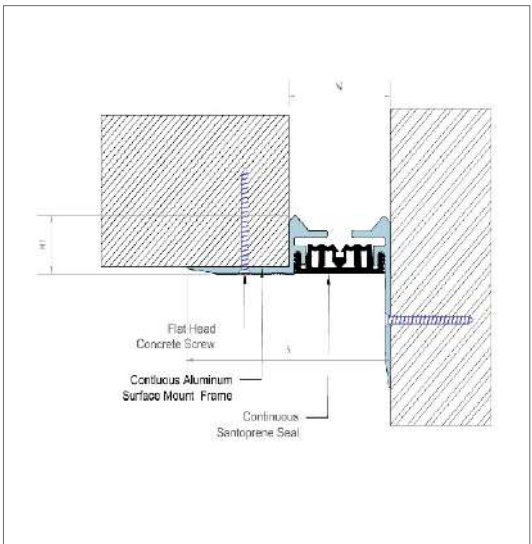
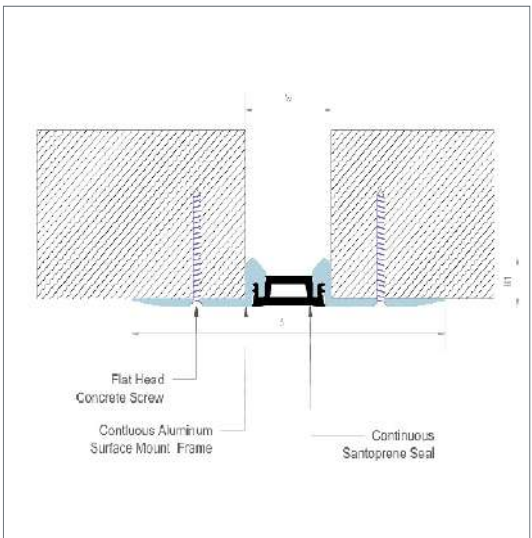

Movement ± 25%

Application	System	W	H1	H2	S	B	Movement +/-		L
		Joint Width	Frame Height 1	Height 2	Sightline	Blockout	Horizontal	Vertical	Load
		mm	mm	mm	mm	mm	mm	mm	Kn
Wall/Wall Ceiling/Ceiling	i315-25	25	16	*	120	*	6	6	*
	i315-50	50	25	*	140	*	13	13	*
Wall/Corner Wall/Ceiling	i315-C-25	25	16	*	75	*	6	6	*
	i315-C-50	50	25	*	95	*	13	13	*

## i317®



## Description

The **i317**® a System is a Flush mount wall expansion joint system. can coordinate with your desired walling finish.

## Key Features

**Install Condition:** Wall / Wall, Wall to Corner.

**Joint width:** 25-50mm.

System is ideal for retrofit applications.

Designed to accommodate several different wall finishes such as tile, wood, or concrete.

Easy to clean flush seals, no dirt or water traps.

Standard and Custom seal colors available.

Dual durometer seal provides a secure fit and optimal flexibility.

Snap-fit design for easy on site assembly.

Standard loading capabilities.

Mill finish aluminum.

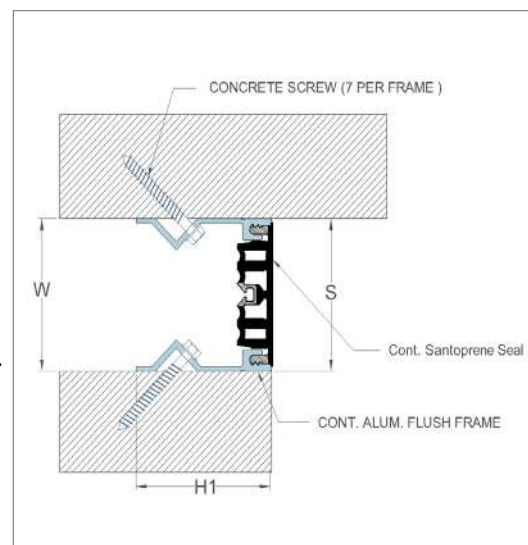
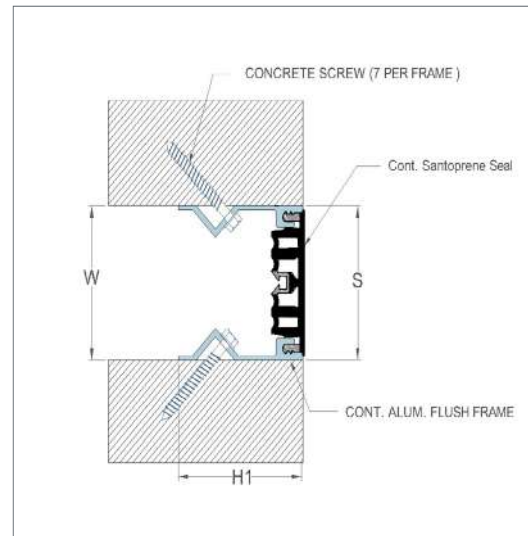

## Movement ± 25%

Application	System	W	H1	H2	S	B	Movement +/-		L
		Joint Width	Frame Height 1	Height 2	Sightline	Blockout	Horizontal	Vertical	Load
		mm	mm	mm	mm	mm	mm	mm	Kn
Wall/Wall Ceiling/Ceiling	i317-25	25	20	*	25	*	6.25	6.25	*
	i317-50	50	20	*	50	*	12.5	12.5	*
Wall/Corner Wall/Ceiling	i317-C-25	25	20	*	25	*	6.25	6.25	*
	i317-C-50	50	20	*	50	*	12.5	12.5	*

## i370®



## Description

The **i370**® ceiling expansion joint system includes bellows seals that allow for seismic movement.

This system comes in a variety of colors to match your ceiling material.

## Key Features

**Install Condition:** Ceiling/Ceiling, Wall/Ceiling.

**Joint width:** 50-150mm.

Model **i370** frame pop rivets to T-Bar profile in suspended ceiling system.

Bellows seal allows for seismic movement.

Standard and Custom seal colors available.

All seals achieve UL Environmental Greenguard.

Mill finish aluminum.

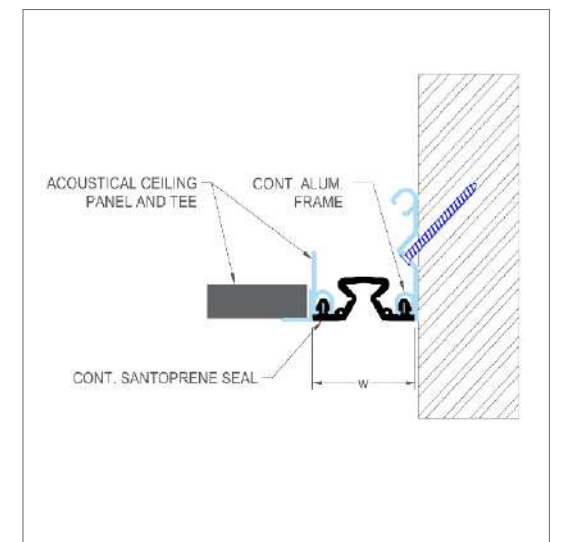
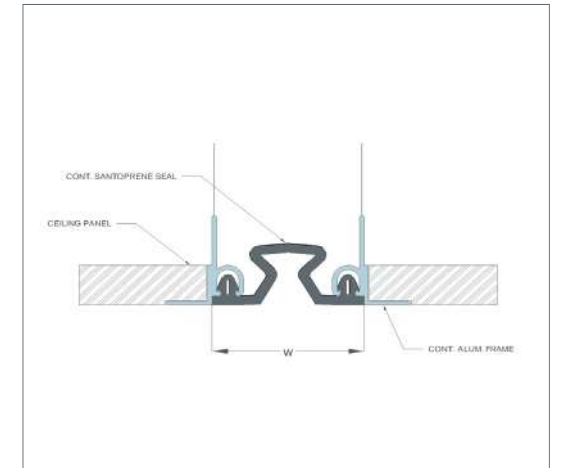

## Movement ± 50%

Application	System	W	H1	H2	S	B	Movement +/-		L
		Joint Width	Frame Height 1	Height 2	Sightline	Blockout	Horizontal	Vertical	Load
		mm	mm	mm	mm	mm	mm	mm	Kn
Ceiling/Ceiling	i370-50	50	*	*	50	*	25	25	*
	i370-75	75	*	*	75	*	38	38	*
	i370-100	100	*	*	100	*	50	50	*
	i370-125	125	*	*	125	*	63	63	*
	i370-150	150	*	*	150	*	75	75	*
Wall/Ceiling	i370-C-50	50	*	*	50	*	25	25	*
	i370-C-75	75	*	*	75	*	38	38	*
	i370-C-100	100	*	*	100	*	50	50	*
	i370-C-125	125	*	*	125	*	63	63	*
	i370-C-150	150	*	*	150	*	75	75	*



## i371®

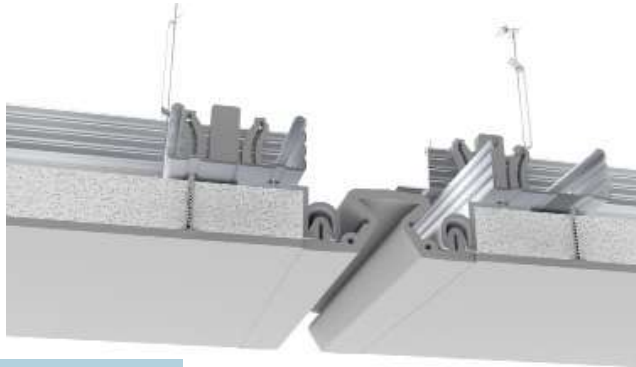

## Description

The **i371®** ceiling expansion joint system includes bellows seals that allow for seismic movement. This system comes in a variety of colors to match your ceiling material.

## Key Features

**Install Condition:** Ceiling/Ceiling, Wall/Ceiling.

**Joint width:** 50-150mm.

Model **i371®** frame pop rivets to T-Bar profile in suspended ceiling system.

Bellows seal allows for seismic movement.

Standard and Custom seal colors available.

All seals achieve UL Environmental Greenguard.

Mill finish aluminum.

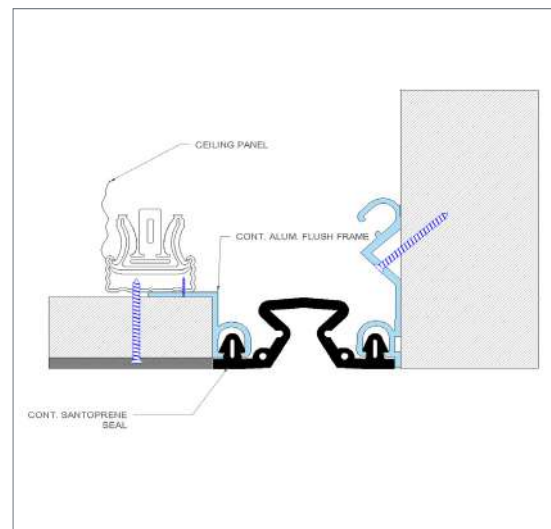
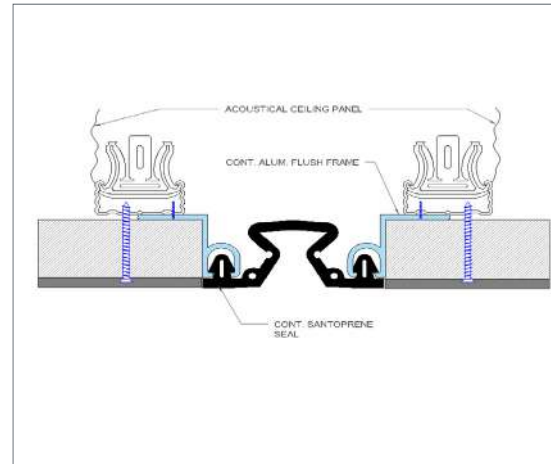

## Movement ± 50%

Application	System	W	H1	H2	S	B	Movement +/-		L
		Joint Width	Frame Height 1	Height 2	Sightline	Blockout	Horizontal	Vertical	Load
		mm	mm	mm	mm	mm	mm	mm	Kn
Ceiling/Ceiling	i371-50	50	*	*	50	*	25	25	*
	i371-75	75	*	*	75	*	38	38	*
	i371-100	100	*	*	100	*	50	50	*
	i371-125	125	*	*	125	*	63	63	*
	i371-150	150	*	*	150	*	75	75	*
Wall/Ceiling	i371-C-50	50	*	*	50	*	25	25	*
	i371-C-75	75	*	*	75	*	38	38	*
	i371-C-100	100	*	*	100	*	50	50	*
	i371-C-125	125	*	*	125	*	63	63	*
	i371-C-150	150	*	*	150	*	75	75	*

## i710®



## Description

The **i710®** interior wall + ceiling expansion joint system is flush mounted to reduce sightline.

Additionally, the pleated seal comes in a variety of colors to blend into your wall material.

## Key Features

**Install Condition:** Wall/Wall, Ceiling/Ceiling.

**Joint width:** 50-150mm.

Flush mount interior systems reduce sightline.

Standard seal colors: black, beige, gray, off white and bright white. Custom colors available upon request.

3component interior system.

May be installed to various substrates with mechanical anchors or epoxy adhesive.

Mill finish aluminum.

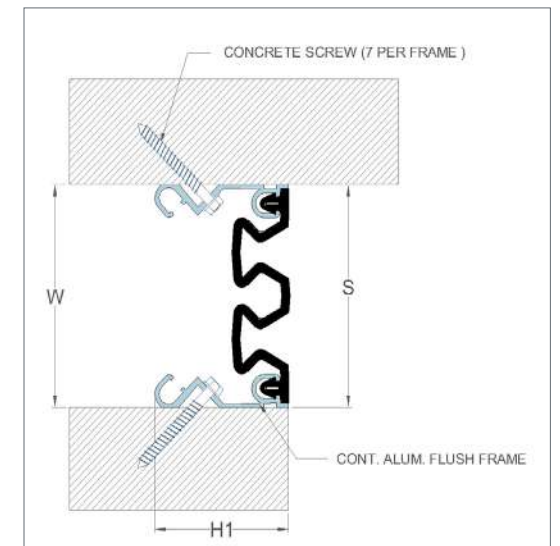
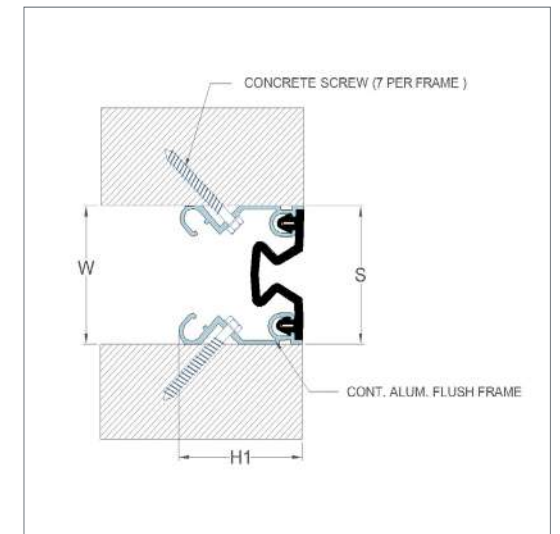

## Movement ± 50%

Application	System	W	H1	H2	S	B	Movement +/-		L
		Joint Width	Frame Height 1	Height 2	Sightline	Blockout	Horizontal	Vertical	Load
		mm	mm	mm	mm	mm	mm	mm	Kn
Wall/Wall Ceiling/ Ceiling	i710-50	50	49	*	50	*	25	25	*
	i710-75	75	49	*	75	*	38	38	*
	i710-100	100	49	*	100	*	50	50	*
	i710-125	125	49	*	125	*	63	63	*
	i710-150	150	49	*	150	*	75	75	*
Wall/Corner Wall/Ceiling	i710-C-50	50	49	*	50	*	25	25	*
	i710-C-75	75	49	*	75	*	38	38	*
	i710-C-100	100	49	*	100	*	50	50	*
	i710-C-125	125	49	*	125	*	63	63	*
	i710-C-150	150	49	*	150	*	75	75	*

## i730®

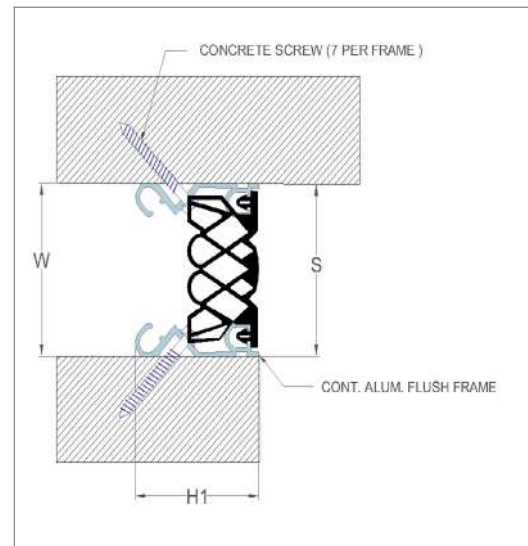
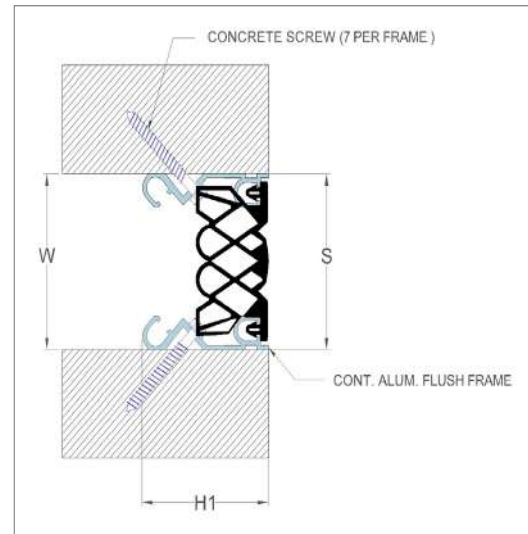

## Description

The **i730®** exterior wall + ceiling expansion joint system is flush mounted to reduce sightline.

Additionally, the pleated seal comes in a variety of colors to blend into your wall material.

## Key Features

**Install Condition:** Wall/Wall, Ceiling/Ceiling.

**Joint width:** 50-100mm.

Flush mount interior and exterior systems reduce sightline.

Standard seal colors: black, beige, gray, off white and bright white.

Custom colors available upon request.

3component exterior system.

May be installed to various substrates with mechanical anchors or epoxy adhesive.

Mill finish aluminum.

## Movement ± 25%

Application	System	W	H1	H2	S	B	Movement +/-		L
		Joint Width	Frame Height 1	Height 2	Sightline	Blockout	Horizontal	Vertical	
		mm	mm	mm	mm	mm	mm	mm	
Wall/Wall Ceiling/ Ceiling	i720-50	50	49	*	50	*	25	25	*
	i720-75	75	49	*	75	*	38	38	*
	i720-100	100	49	*	100	*	50	50	*
Wall/Corner Wall/Ceiling	i720-C-50	50	49	*	50	*	25	25	*
	i720-C-75	75	49	*	75	*	38	38	*
	i720-C-100	100	49	*	100	*	50	50	*

## i820®



## Description

The **i820®** System is a Designed for interior and exterior walls and ceilings.

## Key Features

**Install Condition:** Wall/Wall, Ceiling/Ceiling.

**Joint width:** 25-150mm.

Seamlessly integrates with coordinating **i830®** floor system.

Optional fire rated.

Designed for interior and exterior walls and ceilings.

Unique ratcheted design accommodates uneven or odd angle wall conditions .

Economical solution for retrofit and surface mount installations .

Flush mount interior and exterior systems reduce sightline.

Adaptable to many finishes, including ceramic tile, marble, stone .

Clear anodized finish.

## Movement ± 25%

Application	System	W	H1	H2	S	B	Movement +/-		L
		Joint Width	Frame Height 1	Height 2	Sightline	Blockout	Horizontal	Vertical	
		mm	mm	mm	mm	mm	mm	mm	
Wall/Wall Ceiling/ Ceiling	i820-25	25	4	*	60	*	13	*	*
	i820-38	38	4	*	80	*	19	*	*
	i820-50	50	4	*	110	*	25	*	*
	i820-75	75	4	*	150	*	38	*	*
	i820-100	100	4	*	200	*	50	*	*
	i820-125	125	4	*	250	*	65	*	*
Wall/Corner Wall/Ceiling	i820-150	150	4	*	250	*	75	*	*
	i820-C-25	25	4	*	70	*	13	*	*
	i820-C-38	38	4	*	70	*	19	*	*
	i820-C-50	50	4	*	80	*	25	*	*
	i820-C-75	75	4	*	120	*	38	*	*
	i820-C-100	100	4	*	150	*	50	*	*
	i820-C-125	125	4	*	220	*	65	*	*
	i820-C-150	150	4	*	220	*	75	*	*

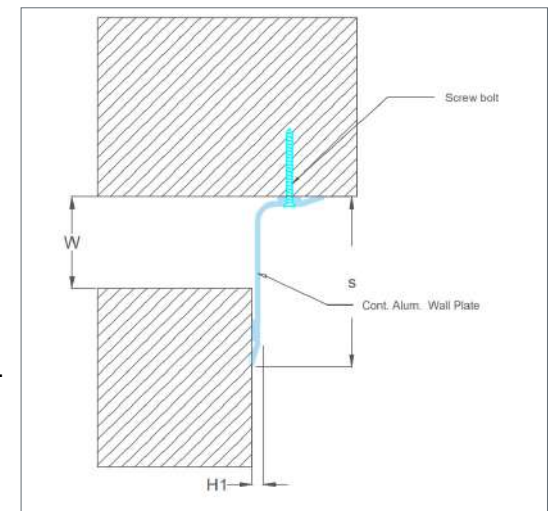
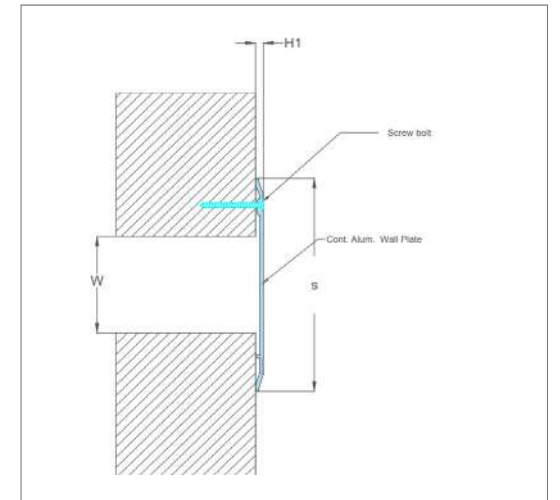



## i821®

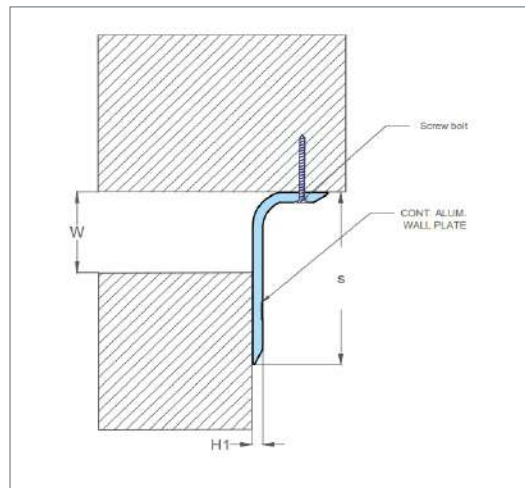
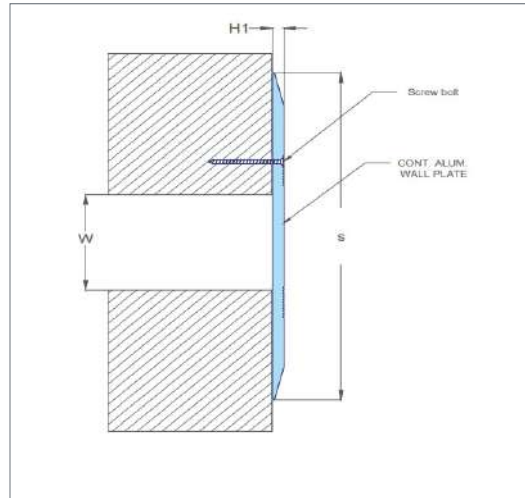
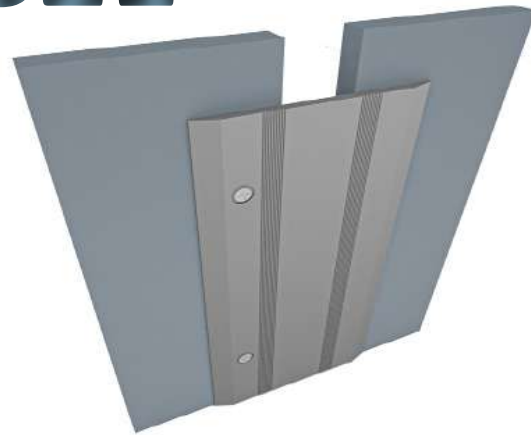

## Description

The **i821®** System is a Designed for interior and exterior walls and ceilings.

## Key Features

**Install Condition:** Wall/Wall, Ceiling/Ceiling.

**Joint width:** 25-150mm.

Seamlessly integrates with coordinating floor system.

Optional fire rated.

Designed for interior walls and ceilings.

Unique ratcheted design accommodates uneven or odd angle wall conditions.

Flush mount interior and exterior systems reduce sightline.

Adaptable to many finishes, including ceramic tile, marble, stone.

Clear anodized finish.

## Movement ± 25%

Application	System	W	H1	H2	S	B	Movement +/-		L
		Joint Width	Frame Height 1	Height 2	Sightline	Blockout	Horizontal	Vertical	Load
		mm	mm	mm	mm	mm	mm	mm	
Wall/Wall Ceiling/ Ceiling	<b>i821-25</b>	25	4	*	60	*	13	*	*
	<b>i821-38</b>	38	4	*	80	*	19	*	*
	<b>i821-50</b>	50	4	*	100	*	25	*	*
	<b>i821-75</b>	75	4	*	145	*	38	*	*
	<b>i821-100</b>	100	4	*	200	*	50	*	*
	<b>i821-125</b>	125	4	*	250	*	65	*	*
	<b>i821-150</b>	150	4	*	250	*	75	*	*
Wall/Corner Wall/Ceiling	<b>i821-C-25</b>	25	4	*	70	*	13	*	*
	<b>i821-C-38</b>	38	4	*	70	*	19	*	*
	<b>i821-C-50</b>	50	4	*	70	*	25	*	*
	<b>i821-C-75</b>	75	4	*	115	*	38	*	*
	<b>i821-C-100</b>	100	4	*	150	*	50	*	*
	<b>i821-C-125</b>	125	4	*	200	*	65	*	*
	<b>i821-C-150</b>	150	4	*	200	*	75	*	*

## i870®

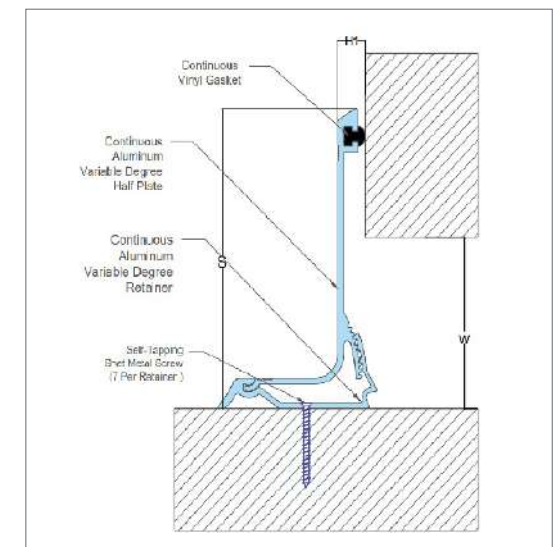
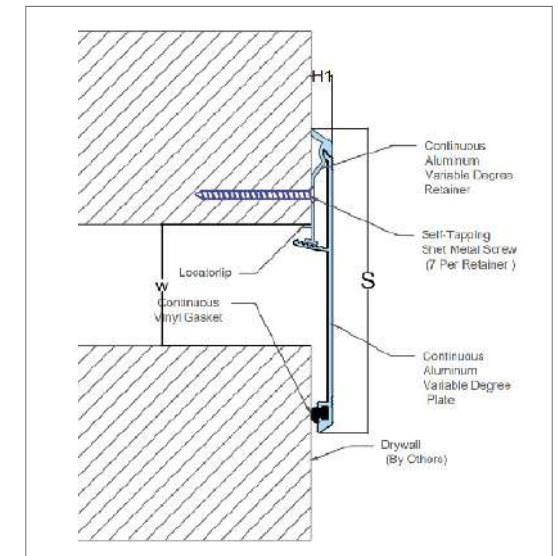

## Description

The **i870®** wall + ceiling expansion joint system is a surface mount design making it a great solution for retrofit projects.

## Key Features

**Install Condition:** Wall/Wall, Ceiling/Ceiling .

**Joint width:** 25-100mm.

Optional fire rated.

Designed for interior walls and ceilings.

Unique ratcheted design accommodates uneven or odd angle wall conditions.

Snap-fit cover plate design hides the fasteners and allows for quick on-site assembly.

Economical solution for retrofit and surface mount installations.

## Movement ± 25%

Application	System	W	H1	H2	S	B	Movement +/-		L
		Joint Width	Frame Height 1	Height 2	Sightline	Blockout	Horizontal	Vertical	Load
		mm	mm	mm	mm	mm	mm	mm	Kn
Wall/Wall Ceiling/ Ceiling	<b>i870-25</b>	25	9	*	79	*	13	*	*
	<b>i870-50</b>	50	9	*	118	*	25	*	*
	<b>i870-75</b>	75	9	*	156	*	38	*	*
	<b>i870-100</b>	100	9	*	194	*	50	*	*
Wall/Corner Wall/Ceiling	<b>i870-C-25</b>	25	9	*	44	*	13	*	*
	<b>i870-C-50</b>	50	9	*	83	*	25	*	*
	<b>i870-C-75</b>	75	9	*	121	*	38	*	*
	<b>i870-C-100</b>	100	9	*	159	*	50	*	*

INTERIOR

It provides practical solutions suitable for interior finishes within buildings, whether installed on floors, walls, or ceilings. It also withstands movement caused by thermal changes in the structures.

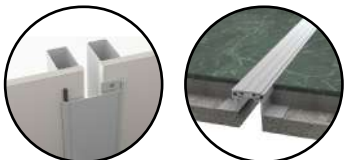

Wall Floor

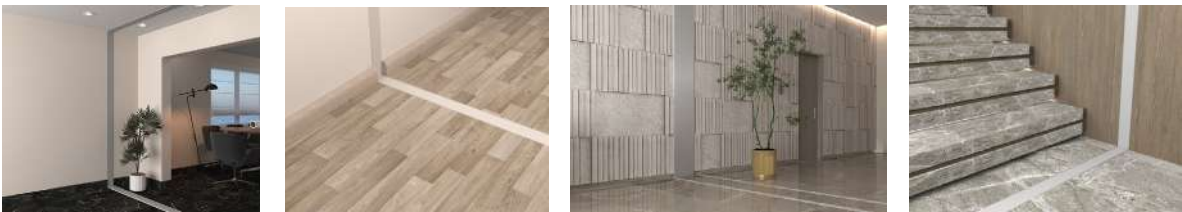

EXTERIOR

Manufactured from durable materials that make it capable of absorbing movements caused by the expansion and contraction of the structure, while remaining resistant to external factors such as direct exposure to sunlight, rain, and wind, preventing erosion or damage.

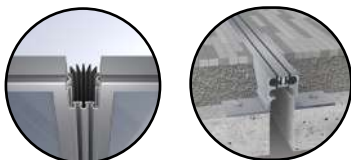

Wall Floor



HEAVY DUTY

Equipped with a feature that enables it to withstand the high loads and pressures encountered in certain structures, such as factories, airports, and warehouses.



OUR PROJECT ONE NINETY

A well rounded mixed-use destination where vibration amplifies and energy multiplies. Master planned by SOM, One Ninety adopts a unique leveling technique to elevate a holistic outlook on integrated living, rolling out on 344,315 m2.

A new degree of extraordinary, inviting all corners of the world in the heart of New Cairo to dictate a trendsetting lifestyle, as well as a sensory feast, complemented by a 34,553 m2 Urban Park where native flora and cosmopolitan cultures thrive.

Location	New Cairo
Client	LMS
Consultant	Sabbour
Contractor	LMD
Quantities	310 M
iChem products used	i920-50i + EPDM iFlex + sealant(Flex seal STP) & Backer rod (iFlex BR) Floor system



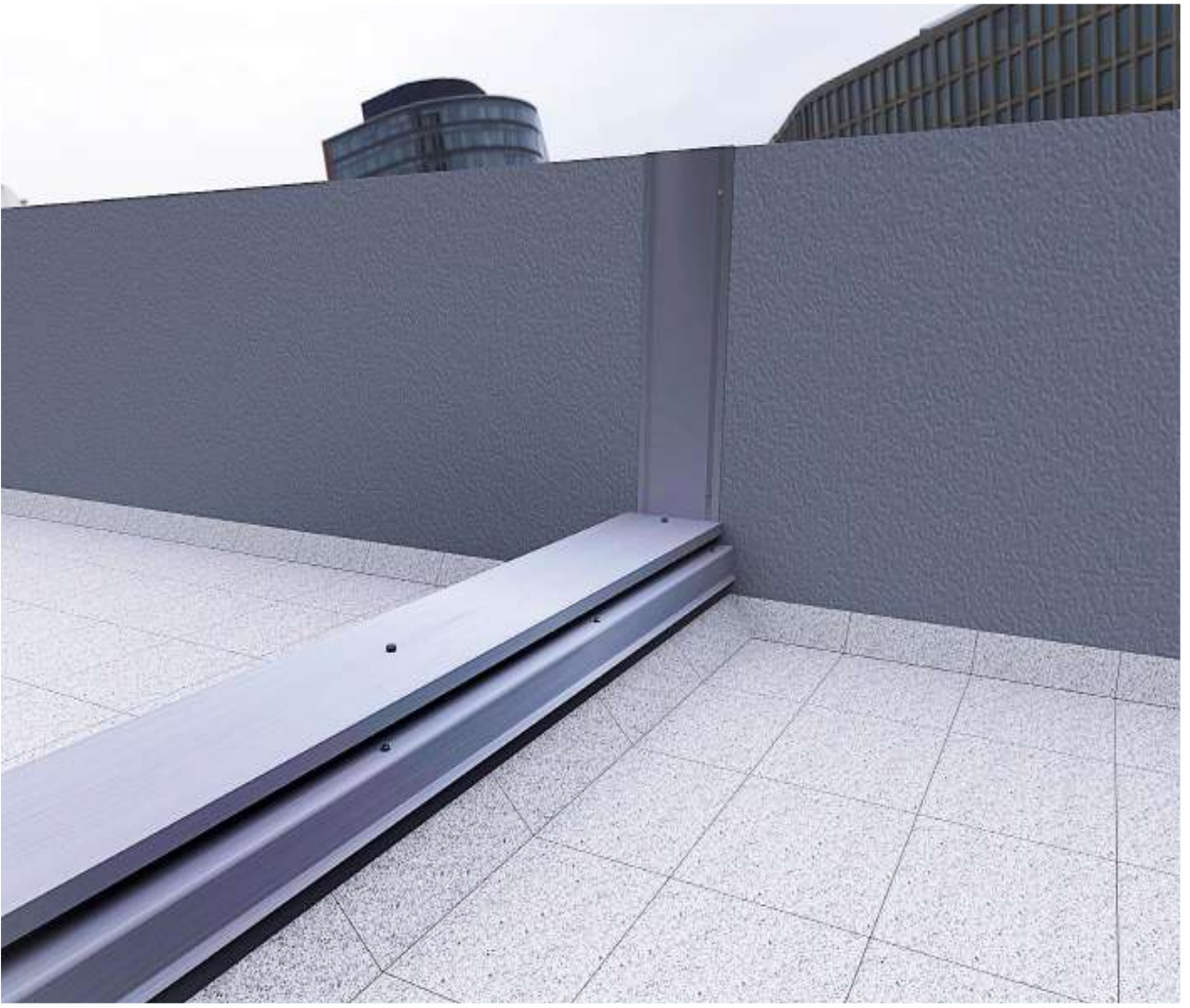

EXTERIOR JOINT SYSTEM

L
Load
Kn
*
*
*
*
*
*
*

i110®

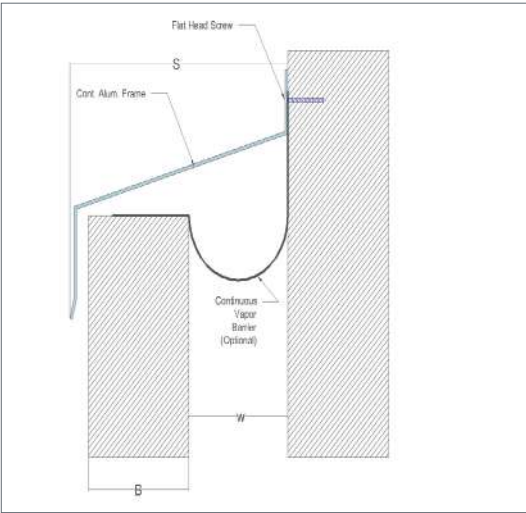
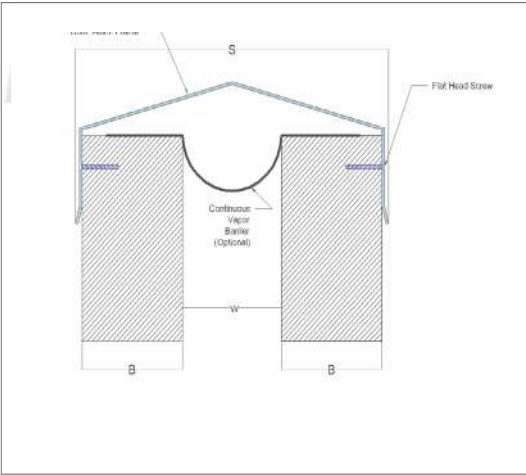

Description

The i110® roof expansion joint system accomodates multi-directional seismic movement and is installed with a 2x up stand mount.

Key Features

**Install Condition:** Roof/Roof, Roof/Wall.

**Joint width:** Manufactured according to site requirements.

Optional fire rated.

Seamlessly integrates with coordinating Wall system.

Applicable for existing conditions, additions and new construction.

Mill finish aluminum.

Movement ± 50%

Application	System	W	H1	H2	S	Movement +/-		L
		Joint Width	Frame Height 1	Height 2	Sightline	Horizontal	Vertical	Load
		mm	mm	mm	mm	mm	mm	Kn
Roof to Roof	Manufactured according to site requirements							*
Roof to Wall	Manufactured according to site requirements							*

## i120®



## Description

The **i120®** roof expansion joint system accommodates multi-directional seismic movement and is installed with a 2x up stand mount.

## Key Features

**Install Condition:** Roof/Roof, Roof/Wall.

**Joint width:** 50-350mm.

Optional fire rated.

Seamlessly integrates with coordinating Wall system.

Anti-slip surface serrations.

Applicable for existing conditions, additions and new construction.

Mill finish aluminum.

**Movement ± 50%**

Application	System	W	H1	H2	S	Movement +/-		L
		Joint Width mm	Frame Height 1 mm	Height 2 mm	Sightline mm	Horizontal mm	Vertical mm	
Roof to Roof	i120-50	50	32	*	130	25	25	*
	i120-75	75	32	*	160	38	38	*
	i120-100	100	32	*	185	50	50	*
	i120-150	150	32	*	265	75	75	*
	i120-200	200	32	*	345	100	100	*
	i120-250	250	32	*	420	125	125	*
	i120-300	300	32	*	495	150	150	*
	i120-350	350	32	*	570	175	175	*
Roof to Wall	i120-C-50	50	32	*	95	25	25	*
	i120-C-75	75	32	*	125	38	38	*
	i120-C-100	100	32	*	165	50	50	*
	i120-C-150	150	32	*	240	75	75	*
	i120-C-200	200	32	*	320	100	100	*
	i120-C-250	250	32	*	395	125	125	*
	i120-C-300	300	32	*	470	150	150	*
	i120-C-350	350	32	*	545	175	175	*

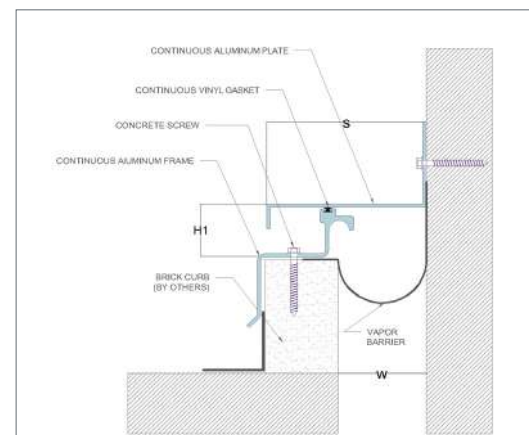
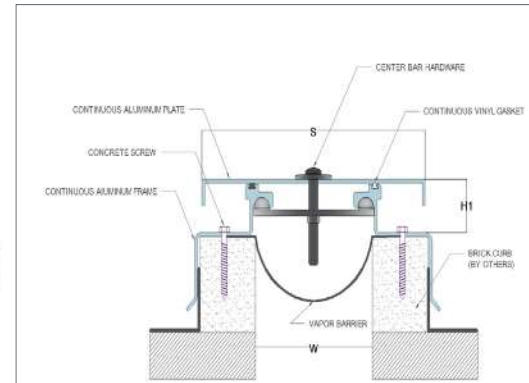

## i130®



## Description

The **i130®** roof expansion joint system accommodates multi-directional seismic movement and is installed with a 2x up stand mount.

## Key Features

**Install Condition:** Roof/Roof, Roof/Wall.

**Joint width:** 50-350mm.

Optional fire rated.

Seamlessly integrates with coordinating Wall system.

Anti-slip surface serrations.

Applicable for existing conditions, additions and new construction.

Mill finish aluminum.

**Movement ± 50%**

Application	System	W	H1	H2	S	Movement +/-		L
		Joint Width mm	Frame Height 1 mm	Height 2 mm	Sightline mm	Horizontal mm	Vertical mm	
Roof to Roof	i130-50	50	32	*	130	25	25	*
	i130-75	75	32	*	160	38	38	*
	i130-100	100	32	*	185	50	50	*
	i130-150	150	32	*	265	75	75	*
	i130-200	200	32	*	345	100	100	*
	i130-250	250	32	*	420	125	125	*
	i130-300	300	32	*	495	150	150	*
	i130-350	350	32	*	570	175	175	*
Roof to Wall	i130-C-50	50	32	*	95	25	25	*
	i130-C-75	75	32	*	125	38	38	*
	i130-C-100	100	32	*	165	50	50	*
	i130-C-150	150	32	*	240	75	75	*
	i130-C-200	200	32	*	320	100	100	*
	i130-C-250	250	32	*	395	125	125	*
	i130-C-300	300	32	*	470	150	150	*
	i130-C-350	350	32	*	545	175	175	*

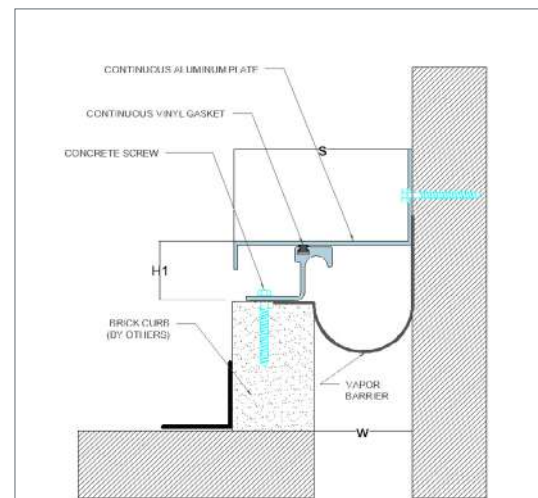
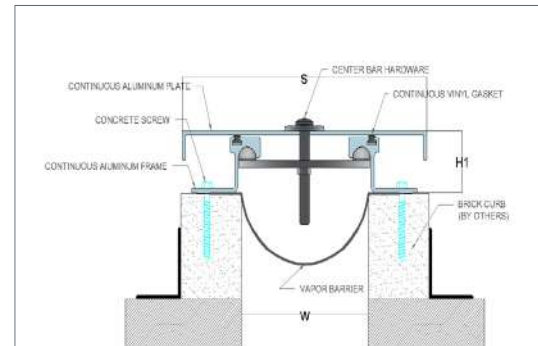



i424®

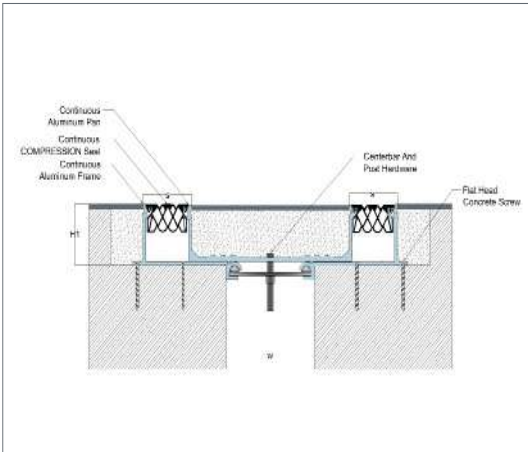

Description

The **i424®** floor expansion joint system is pan system Designed for generous thermal and seismic movement requirements.

Key Features

- Install Condition:** Floor/Floor, Floor/Wall.
- Joint width:** 50-100mm.
- Optional fire rated.
- Seamlessly integrates with coordinating Wall system.
- Anti-slip surface serrations.
- Applicable for existing conditions, additions and new construction.
- System can be modified to meet any movement.
- Mill finish aluminum.

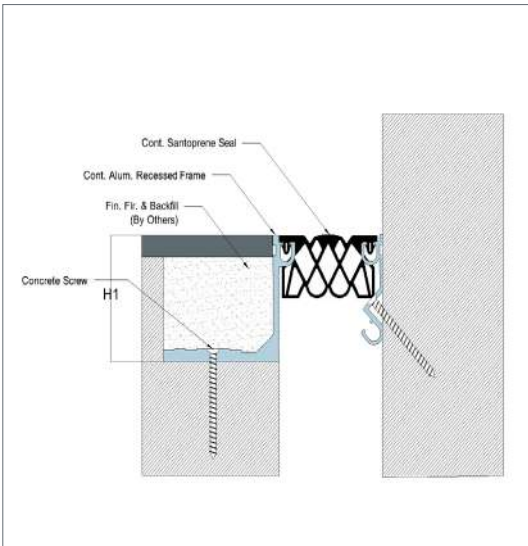

Movement ±50%

Application	System	W	H1	H2	S	B	Movement +/-		Load
		Joint Width	Frame Height 1	Height 2	Sightline	Blockout	Horizontal	Vertical	
		mm	mm	mm	mm	mm	mm	mm	
Floor to Floor	i424-50	50	57	*	55	155	25	25	Vehicle
	i424-100	100	57	*	110	155	50	50	Vehicle
Floor to Wall	i424-C-50	50	57	*	55	155	25	25	Vehicle
	i424-C-100	100	57	*	110	155	50	50	Vehicle

i720®

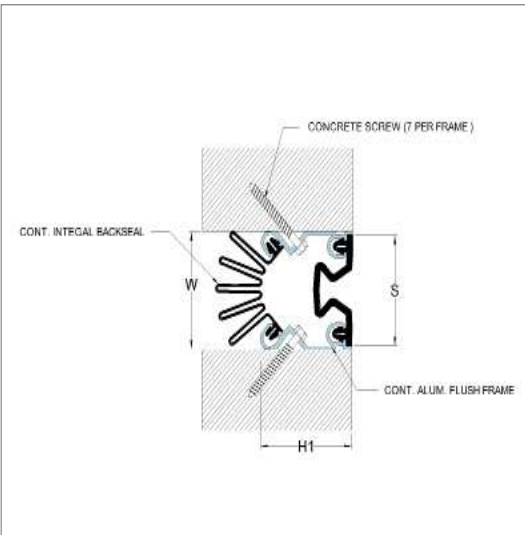

Description

The **i720®** exterior wall + ceiling expansion joint system is flush mounted to reduce sightline. Additionally, the pleated seal comes in a variety of colors to blend into your wall material.

Key Features

- Install Condition:** Wall/Wall, Ceiling/Ceiling.
- Joint width:** 50-150mm.
- Flush mount interior and exterior systems reduce sightline.
- i900 TR®** seals - Field heat weldable for weather tight transitions.
- Standard seal colors:** black, beige, gray, off white and bright white.
- Custom colors available upon request.
- 4 component exterior system includes integral backseal.
- May be installed to various substrates with mechanical anchors or epoxy adhesive.
- Mill finish aluminum.

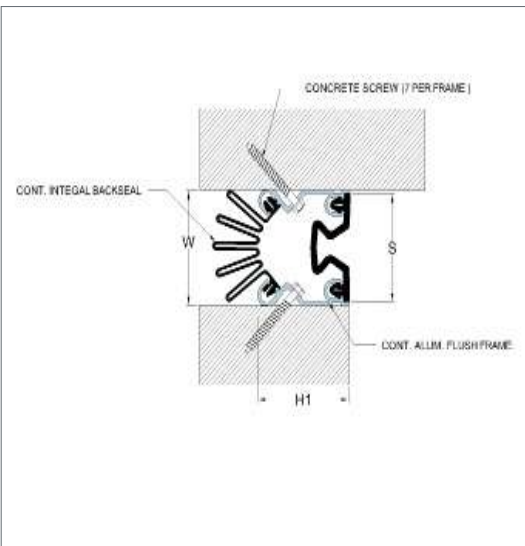

Movement ±50%

Application	System	W	H1	H2	S	B	Movement +/-		L
		Joint Width	Frame Height 1	Height 2	Sightline	Blockout	Horizontal	Vertical	Load
		mm	mm	mm	mm	mm	mm	mm	Kn
Wall/Wall Ceiling/ Ceiling	i720-50	50	49	*	50	*	25	25	*
	i720-75	75	49	*	75	*	38	38	*
	i720-100	100	49	*	100	*	50	50	*
	i720-125	125	49	*	125	*	63	63	*
	i720-150	150	49	*	150	*	75	75	*
Wall/Corner Wall/Ceiling	i720-C-50	50	49	*	50	*	25	25	*
	i720-C-75	75	49	*	75	*	38	38	*
	i720-C-100	100	49	*	100	*	50	50	*
	i720-C-125	125	49	*	125	*	63	63	*
	i720-C-150	150	49	*	150	*	75	75	*



i750®

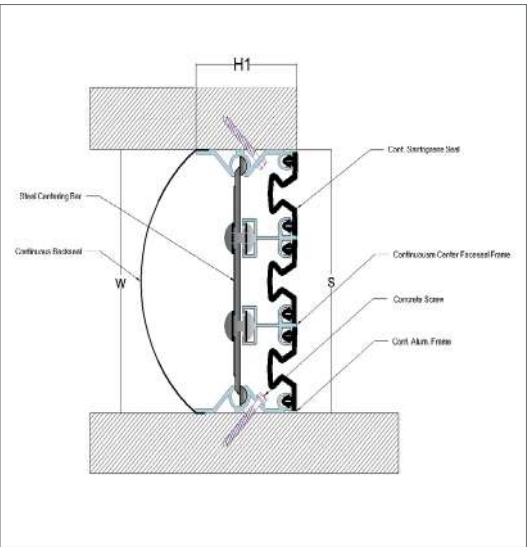
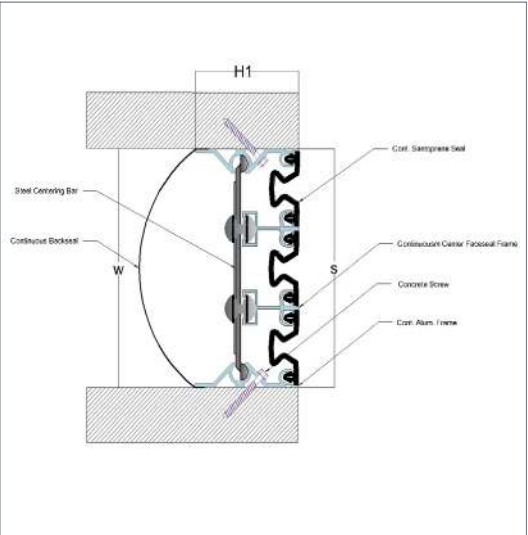

Description

The **i750®** interior wall + ceiling expansion joint system is flush mounted to reduce sightline. Additionally, the pleated seal comes in a variety of colors to blend into your wall material.

Key Features

**Install Condition:** Wall/Wall,Ceiling/Ceiling.

**Joint width:**150-300mm.

Flush mount interior systems reduce sightline.

**Standard seal colors:** black, beige, gray, off white and bright white.

Custom colors available upon request.

May be installed to various substrates with mechanical anchors or epoxy adhesive.

Mill finish aluminum.

Movement ± 50%

Application	System	W	H1	H2	S	B	Movement +/-		L
		Joint Width	Frame Height 1	Height 2	Sightline	Blockout	Horizontal	Vertical	Load
		mm	mm	mm	mm	mm	mm	mm	Kn
Wall/Wall Ceiling/ Ceiling	i750-150	150	75	*	150	*	75	75	*
	i750-200	200	75	*	200	*	100	100	*
	i750-250	250	75	*	250	*	125	125	*
	i750-300	300	75	*	300	*	150	150	*
Wall/Corner Wall/ Ceiling	i750-C-150	150	75	*	150	*	75	75	*
	i750-C-200	200	75	*	200	*	100	100	*
	i750-C-250	250	75	*	250	*	125	125	*
	i750-C-300	300	75	*	300	*	150	150	*

OUR  
PROJECT

O - WEST

O West October project is an integrated residential complex by Orascom Real Estate, which is one of the most famous companies in the field of real estate development in Egypt and abroad with more than 30 years of experience of success

The area of O West Orascom project is one of the features of the compound, because the area of O West reaches 1000 acres, which makes O West Orascom project one of the giant projects, and O West Compound rises from the surrounding area with a height ranging from 30 to 50 m above the ground.

The area of O West October project was divided as follows  
20% of buildings are divided into 60% villas, 20% residential apartments, and 20% services  
The remaining 80% are for landscaping and artificial lakes



Location

6 October city

Client

Orascom Development

Consultant

Nature for Engineering Consultancy

Contractor

RED SEA Construction

Quantities

762 M

iChem products used

I424-50 with pvc Exterior systems  
I424-c-50 with pvc Exterior systems

I830-50      I331-50  
I710-50      I317-50  
I330-50      I870-50





COMPRESSION  
SEALS

iFlex CS<sup>®</sup>



Description

The **iFlex CS<sup>®</sup>** is a The unique design creates crisp sight lines and incorporates ribs on the sides to aid in pooling **EpoMortar SF<sup>®</sup>** and adding surface area for increased adhesion during installation. Comprised of Rubber, this system has superior movement while being highly resistant to UV degradation, extreme temperatures, and chemicals.

Key Features

- Install Condition:** Floor/Floor.
- Joint width:** 25-100mm.
- Optional fire rated.
- Heavy pedestrian/moderate vehicular loading.
- Heat weldable for watertight seams.
- Standard Color:** Black.
- Excellent adhesion to many materials.
- Weather and water resistant.
- UV resistant.
- Good resistance to many chemicals.
- Versatile system suitable for many difficult situations.
- Extremely flexible.

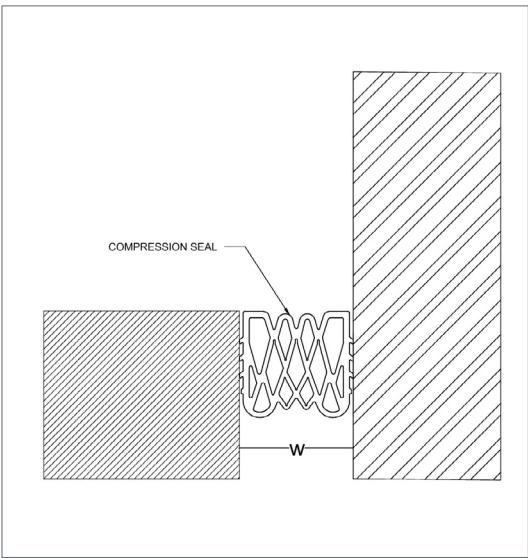
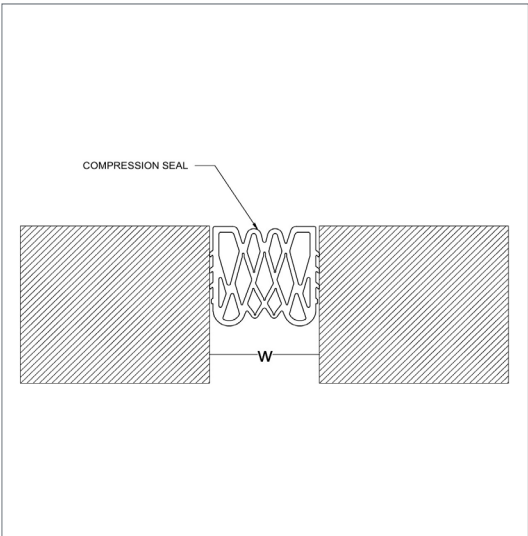

% Movement  $\pm$  50

System	W	H1	Load
	Joint Width	Seal Height	
	mm	mm	
iFlex CS -25	20-30	60	Vehicle
iFlex CS -50	40-60	70	Vehicle
iFlex CS -75	60-80	100	Vehicle
iFlex CS -100	90-110	125	Vehicle

iFlex CSW®



Description

The **iFlex CSW®** is a The unique design creates crisp sight lines and incorporates ribs on the sides to aid in pooling **EpoMortar SF®** and adding surface area for increased adhesion during installation. Comprised of Rubber, this system has superior movement while being highly resistant to UV degradation, extreme temperatures, and chemicals.

Key Features

- Install Condition:** Floor to Floor.
- Joint width:** 25-100mm.
- Optional fire rated.
- Heavy pedestrian/moderate vehicular loading.
- Heat weldable for watertight seams.
- Standard Color:** Black.
- Excellent adhesion to many materials.
- Weather and water resistant.
- UV resistant.
- Good resistance to many chemicals.
- Versatile system suitable for many difficult situations.
- Extremely flexible.

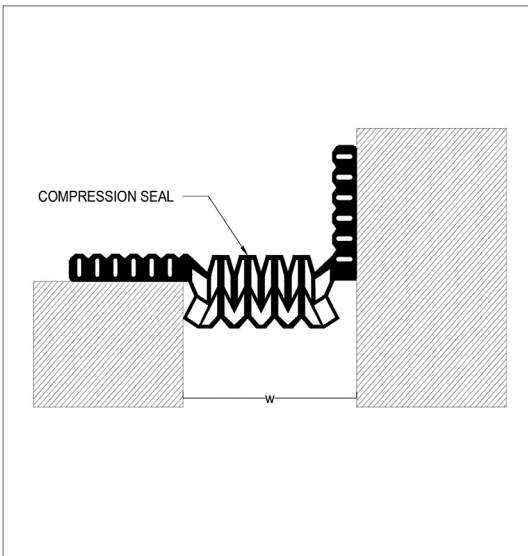
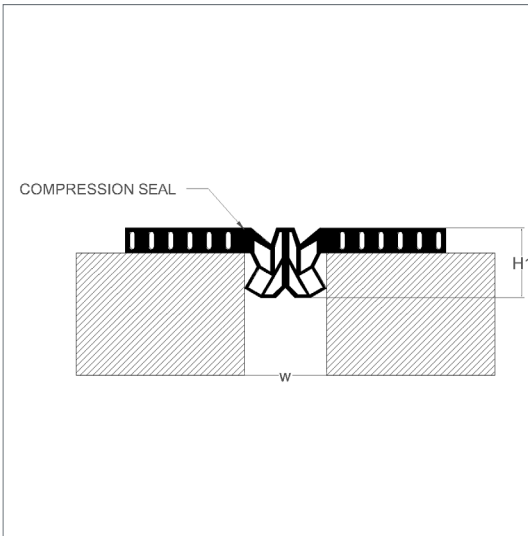

Movement ± 50%

System	W	H1	Load
	Joint Width	Seal Height	
	mm	mm	
iFlex CSW -25	20-30	50	Vehicle
iFlex CSW -50	40-60	50	Vehicle
iFlex CSW -75	60-80	50	Vehicle
iFlex CSW -100	90-110	50	Vehicle

iFlex CSL®



Description

The **iFlex CSL®** is a The unique design creates crisp sight lines and incorporates ribs on the sides to aid in pooling **EpoMortar SF®** and adding surface area for increased adhesion during installation. Comprised of Rubber, this system has superior movement while being highly resistant to UV degradation, extreme temperatures, and chemicals.

Key Features

- Install Condition:** Floor to Floor.
- Joint width:** 25-100mm.
- Optional fire rated.
- Heavy pedestrian/moderate vehicular loading.
- Standard Color:** Black.
- Excellent adhesion to many materials.
- Weather and water resistant.
- UV resistant.
- Good resistance to many chemicals.
- Mill finish aluminum.

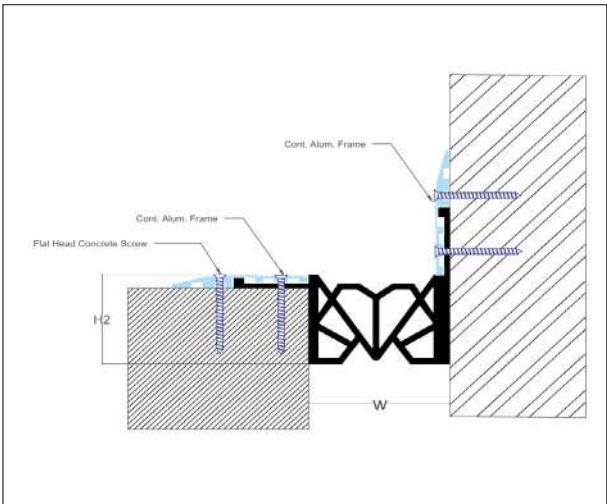
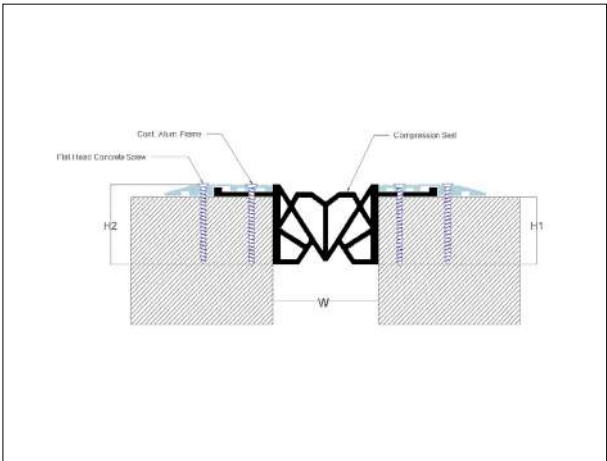

Movement ± 50%

System	W	H1	H2	Load
	Joint Width	Seal Height	Seal Depth	
	mm	mm	mm	
iFlex CSL -25	20-30	40	50	Vehicle
iFlex CSL -50	40-60	50	60	Vehicle
iFlex CSL -75	65-85	80	90	Vehicle
iFlex CSL -100	90-110	80	90	Vehicle



Discover iChem’s Specialized Expansion Joints for Rare Applications

RAISED FLOORS

If you are using raised floors to route cables, wires, ventilation, or cooling systems in offices, data centers, or any other location, iChem provides strong and flexible expansion joints that protect the building from cracks and damage while maintaining an organized appearance.



CURTAIN WALLS

iChem expansion joints for curtain walls are designed to align perfectly with the wall structure, allowing natural movement of the framework due to temperature changes and wind pressure. They prevent cracks or damage in the structure, ensuring the safety and sustainability of curtain walls under various conditions.



GIPSUM BOARD (FALSE CEILING)

The expansion joints designed for gypsum board false ceilings work to distribute pressure effectively and avoid any negative impact on their external appearance caused by environmental conditions. They ensure the stability and quality of the ceiling while delivering a cohesive and visually appealing final design.

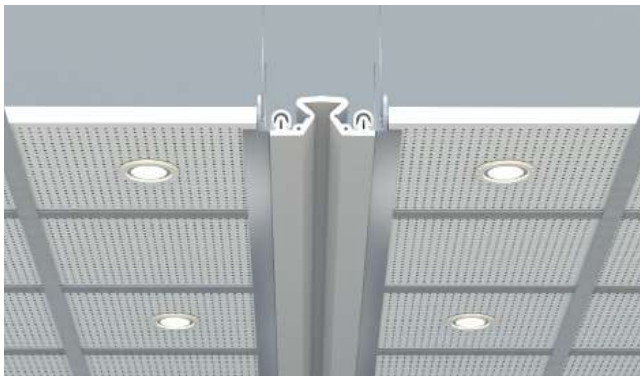

OUR PROJECT

ROCK CAPITAL

Rock Capital One Mall in the Creative Financial District: It is the number one building in the Financial District in the New Administrative Capital, constantly stopping at vital areas and landmarks. Rock Capital One Mall overlooks a main street, 850 meters wide, and another 34 meters wide.

Rock Capital, One covers approximately 5 acres.

Rock Capital One New Capital was built on 30% of the area, with the remainder allocated to green spaces and landscaped gardens.

Rock Capital One consists of a ground floor and seven floors. All units in Rock Capital One New Capital enjoy direct views, and there are no standalone units.

It includes Rock Capital Mall, as well as medical and administrative units.



Location	New Administrative Capital
Client	El Batal
Consultant	El Batal development
Contractor	B1 Investment
Quantities	1739 M
iChem products used	i330 Floor systems i830 Floor Systems iFlex CSW iFlex CS





FIRE + MOISTURE  
BARRIERS

## FS i1005®

### Description

The **FS i1005®** is economical fire barrier system from ceramic fiber that protect your building and the people inside from the spread of smoke.

### Key Features

**Install Condition:** Horizontal and Vertical.

**Joint width:** 25-50mm.

Fire barrier system for 2 and 3 Hr. Fire Ratings.

Designed for interior and exterior expansion joints.

No mechanical fastening required for installation.

**Color:** White.

### Material

Ceramic Fiber Blanket.

### Packaging

**Available in:** Rolls of 2m.

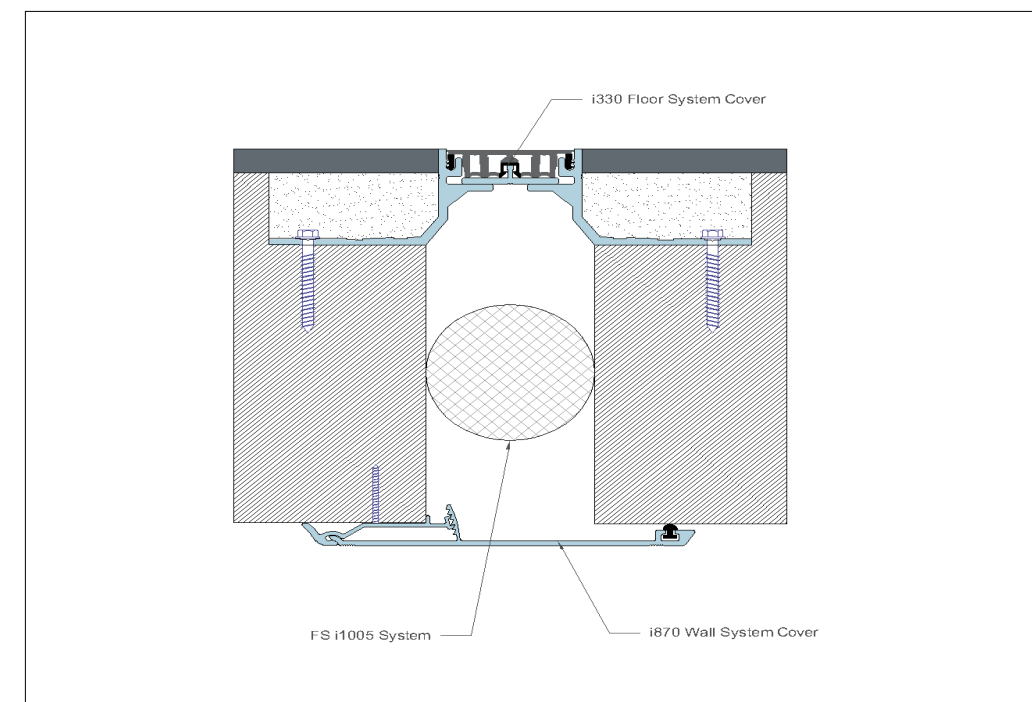



# FS i1010®

## Description

The **FS i1010®** is fire barrier system that protect your building and the people inside from the spread of smoke and fire easier than ever before.

## Key Features

**Install Condition:** Horizontal and Vertical.

**Joint width:** 50-250mm.

Fire barrier system for 1 and 2 Hr. Fire Ratings.

Designed for interior and exterior expansion joints.

No mechanical fastening required for installation.

## Packaging

**Available in:** Rolls of 2m.

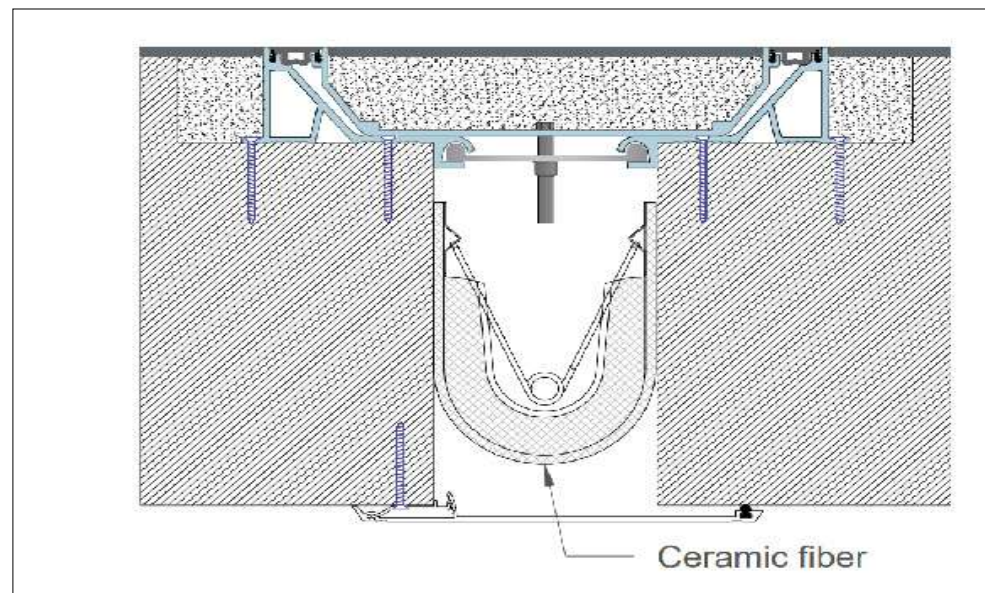

# iFlex PVC®

## Description

The **iFlex PVC®** is a non reinforced liner on base of plasticized polyvinylchloride PVC, type T according to Standard EN 13967.

**iFlex PVC®** is produced by extrusion of the selected secondary raw materials of PVC without other polymer materials.

## Key Features

Excellent adhesion to many materials.

Weather and water resistant.

UV resistant.

Available with normal and rapid hardening grades of adhesive.

Root resistant.

Good resistance to many chemicals.

Versatile system suitable for many difficult situations.

Extremely flexible.

## Uses

Sealing system for expansion, construction and connection joints in oints with extreme movement.

Water retaining structures and drinking water reservoirs.

Hydro electric power plants.

Sewage treatment plants.

## Packaging

**Available in:** Rolls of 20m.

**Thickness:** 1.5mm.

**Width:** 20, 25, 32cm.

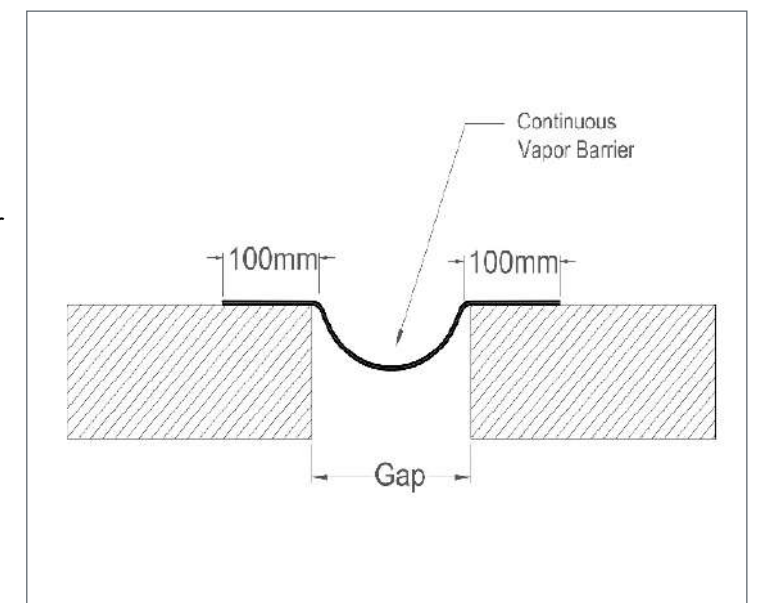

# iFlex EPDM®

## Description

The **iFlex EPDM®** is a type of synthetic rubber that is commonly used across many industries.

**iFlex EPDM®** is made from ethylene, propylene, and diene monomers and is a very versatile and durable type of rubber with many applications.

## Key Features

Excellent adhesion to many materials.  
Extremely flexible.  
Weather and water resistant.  
UV resistant.  
Root resistant.  
Available with normal and rapid hardening grades of adhesive.  
Good resistance to many chemicals.  
Versatile system suitable for many difficult situations.



## Technical Properties

Tensile Strength	11.67N/mm <sup>2</sup>
Tear Strength	13.54N/mm
Shore A Hardness	91%
Elongation at Break	320%
Thickness	1.5mm
color	Black
polymer	EPDM

## Packaging

**Available in:** Rolls of 20m.

**Thickness:** 1.5mm.

**Width:** 20, 25, 32cm.

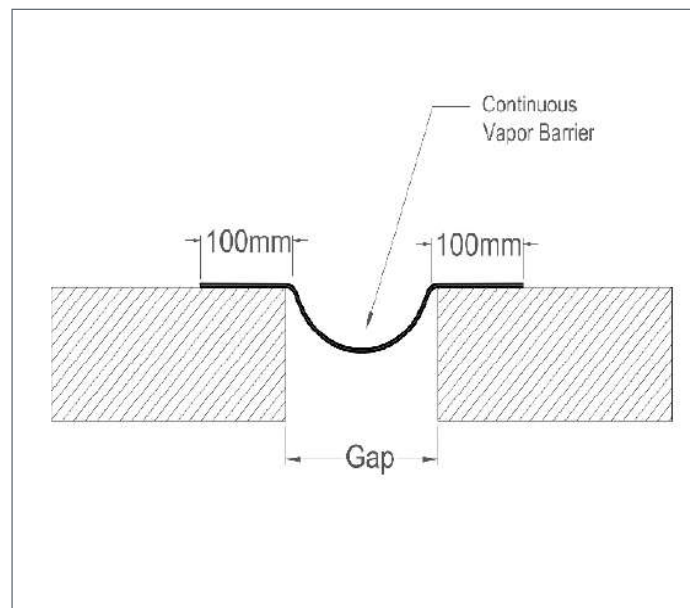

# iFlex BR®

## Description

The **iFlex BR®** Foam Backer Rod Closed Cell is manufactured from closed cell, low density, polyethylene foam. **iFlex BR®** Foam Backer Rod Closed Cell has excellent compression and recovery properties, is available in various sizes and lengths. The round profile assists in providing the correct joint sealant profile allowing optimum movement capability.

## Key Features

Easy to use.  
Extremely flexible.  
Excellent recovery after compression.  
Water resistant.  
Closed cell.  
Compatible with cold applied sealants polyurethane, silicone.  
Assists with sealant profile.  
Assists with joint design.

## Uses

The **iFlex BR®** Foam Backer Rod is especially recommended for use in:  
Joint sealant support for concrete flooring.  
Expansion joints in concrete structures.  
Water treatment plants.  
Potable water structures : Tanks, Canals, reservoirs.

## Packaging

Size	Packing
10mm	100m Roll
15mm	100m Roll
20mm	100m Roll
25mm	100m Roll
30mm	100m Roll
40mm	2m Rod
50mm	2m Rod

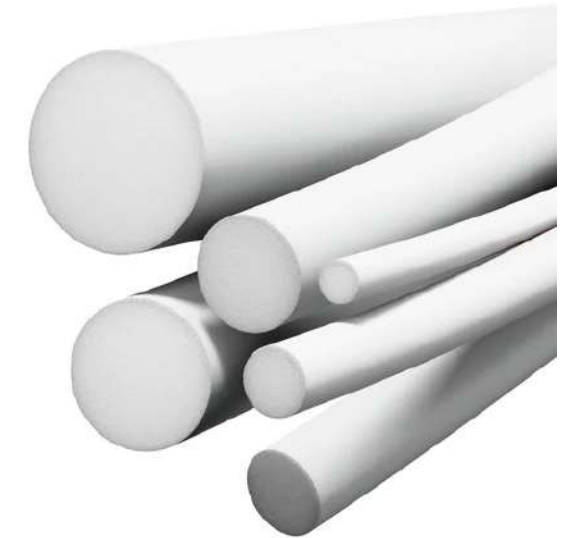

## Technical Properties

Color	White
Density	0.025 ~ 0.040 gm / cm <sup>3</sup>
Average Cell Size	0.26 ~ 0.33
Tensile Strength	2.2 ~ 3.4 kg / cm <sup>2</sup>
Elongation	130 ~ 140 %
Permanent Compression set	5.0 %
Dielectric Constant	1.05 ~ 1.58 E (kHz)
Sound properties	Good
Toxic character	Non toxic.
Chemicals Resistance	Excellent
Thermal Conductivity	0.027 ~ 0.040 hr °C
Water Absorption	0.03 below mg / cm <sup>2</sup>
Combustion Rate	6.40 ~ 10.0 cm / min
Heat Distortion temperature	70 ~ 80°C
Repeated Compression set:	2.2 ~ 2.40 %



# ChemSeal PU®

## Description

The **ChemSeal PU®** is a one component, gun grade non sag, moisture-cure polyurethane sealant. **ChemSeal PU®** is ideal for sealing most types of joints in construction structures and buildings with excellent weathering resistance and excellent adhesion to most building materials.

## Key Features

Permanently flexible, excellent weatherability.  
 Paintable.  
 Single component & convenient packing.  
 Excellent adhesion without priming.  
 Highly resistant to sea water, diluted acids and alkalis.  
 Odourless.  
 UV resistant/ fast curing.  
 Low VOC.  
 Easy to gun, Easy to tool.  
 Cures to a tough, durable, elastic consistency with excellent cut and tear resistance.  
 Non-sticky after cure.

## Uses

Sealant is designed to seal concrete construction joints.  
 To seal waterproof rivet seams and roof rails.  
 Sealing of dynamic structural cracks.  
 Sealing Air conditioning equipment, flashing and gutters.  
 Glazing joints of windows and door frames.

## Packaging

600ml sausage.  
 5&10kg pails.



## Technical Properties

Specific Gravity	g/ml @ 25°C (ASTM 1.30 - 1.24 (D1475
Tensile Strength	(N/mm2 (ASTM D412 0.6<
Elongation at break	(ASTM D412) % 150<
Hardness: Shore A	(ASTM D2240) 33 - 27
VOC	(g/L (USEPA Method 24 25>
Flow	(Non-Sag (ASTM C639
Skin Over Time	25°C, Minutes @ 35 - 10
Application Temperature	to + 40 °C +5
Service Temperature	to +80 °C -20
Color	White, Beige, Grey, and Black

# iFlex RS®

## Description

The **iFlex RS®** is extruded polyethylene sheet closed cell foam.

## Key Features

Available in several colors.  
 Easy to Apply.  
 Compatible with cold sealants materials.  
 Different thicknesses and widths available.  
 Highly flexible & compressible.  
 Good water resistance.  
 Good temperature resistance.  
 Closed Cell.

## Uses

The **iFlex RS®** As a backing material for applied joint, and as a joint filler, due to its highly permanent elasticity, which is most efficient for these purposes.

The **iFlex RS®** As a used in a wide range of flooring gyms and areas of children's games and kindergarten.

## Technical Properties

Compression	> 95 %
Tensile strength	8 kg/cm3
Density	100-130 kg/cm3
Elongation	300%
Base	Treated polyethylene
Composition	Extruded closed-cell Polyethylene
Color	Black and other colors as needed

## Packaging

Sheets 1m x 1&2 m in required thickness.  
 Available thicknesses: 5-10-20-30-40-50 mm.



## Storage

Store under cover, out of direct sunlight and protect from extreme temperatures. In tropical climates the product must be stored in air-conditioned environment.

## Shelf Life

Shelf life is up to 60 months when stored as per recommendations.

## Quality, Enviromental& HS

All products manufactured by iChemEG, or imported from iChemEG affiliate companies worldwide, are manufactured to procedures certified to conform to the quality, environment, health & safety management systems.

## Technical support

For any technical support, please contact IChem technical office or representatives.

## THERMAL MOVEMENT &amp; SEISMIC MOVEMENT

## WHAT IS THE DIFFERENCE?

## Thermal Movement

- Thermal movement occurs due to changes in temperature (increase or decrease), and its effects appear gradually over time.
- This movement takes the form of expansion or contraction of building materials, such as concrete or steel, which may lead to weakened connections between different parts of the building and cause cracks in walls or ceilings.



## Seismic Movement

- Seismic movement occurs during earthquakes, tremors, or any geological activity underground, and its effects are sudden and violent depending on the intensity of the earthquake or tremor.

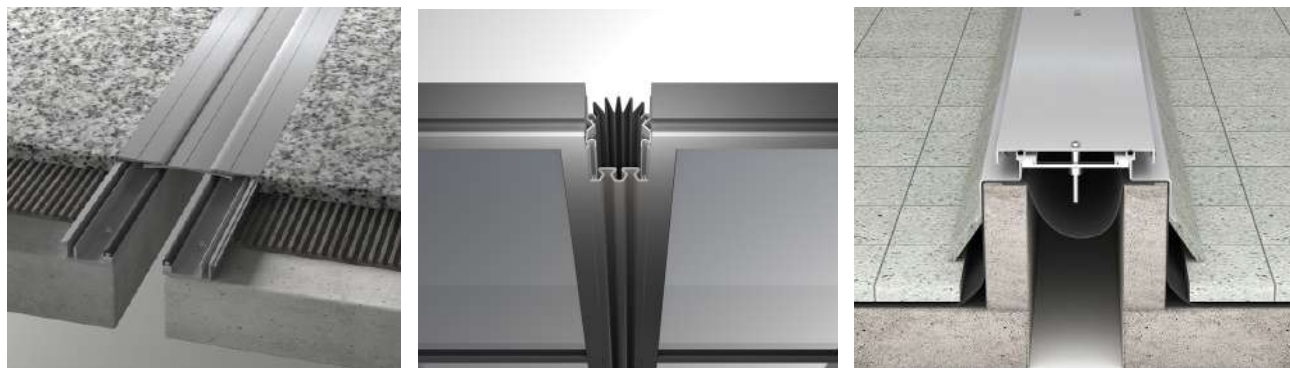



## PROFILES FOR FLOOR AND WALLS

- i3010
- i3011
- i3020
- i3021
- i3022
- i3030
- i3040
- i3050
- i3060
- i3061
- i3062
- iFlash metal

## STAIR NOSING PROFILE

- i2020
- i2025

## CONTROL JOINT PROFILE

- i340
- i345
- i348

## SKIRTING PROFILE

- i4010
- i4011

## OUR PROJECT

## ZAHA PARK MALL

Mall Zaha Park New Capital is one of the most famous landmarks in the New Administrative Capital, and the first mall in Egypt whose design was inspired by the architect Zaha Hadid in the form of waves, making the entire mall distinctive in the MU23 area.

Zaha Park Mall covers an area of approximately 7,200 square meters and is divided into unique units, services, facilities, and entertainment venues. The mall has 9 floors in addition to the ground floor.



## Location

New Cairo

## Client

Better Home

## Consultant

SABOUR

## Contractor

Dfcon Construction builders

## Quantities

380M

## iChem products used

i412 Floor systems  
i870 Wall Systems  
IFLEX EPDM – Expo mortar SF



PROFILE FOR  
FLOOR AND WALLS

# i3010®

## Color

Silver - Gold - Rose Gold.

## Material

Stainless 304 or 316.

## Thickness

0.8mm.

## Length

280cm.

## Used

Edges - Floor - Wall.

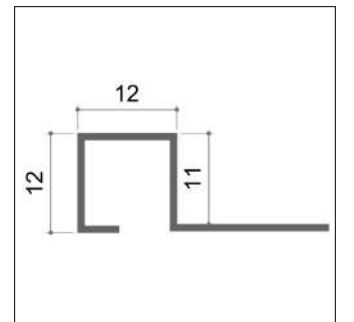
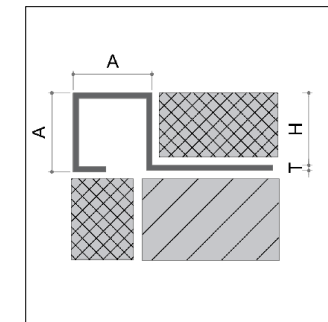
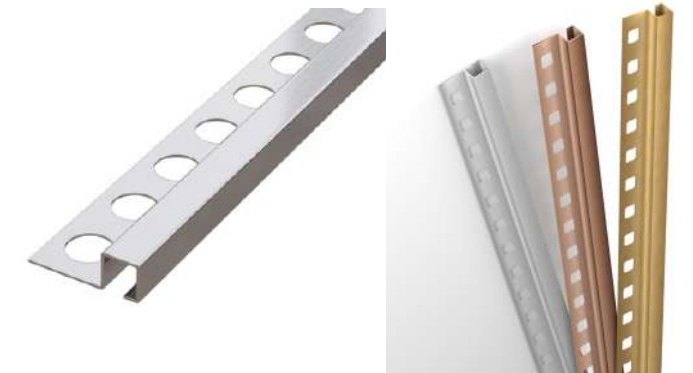



## i3011®

**Color**

Silver - Gold.

**Material**

Stainless 304 or 316.

**Thickness**

1 mm.

**Length**

280cm.

**Used**

Edges - Floor - Wall.

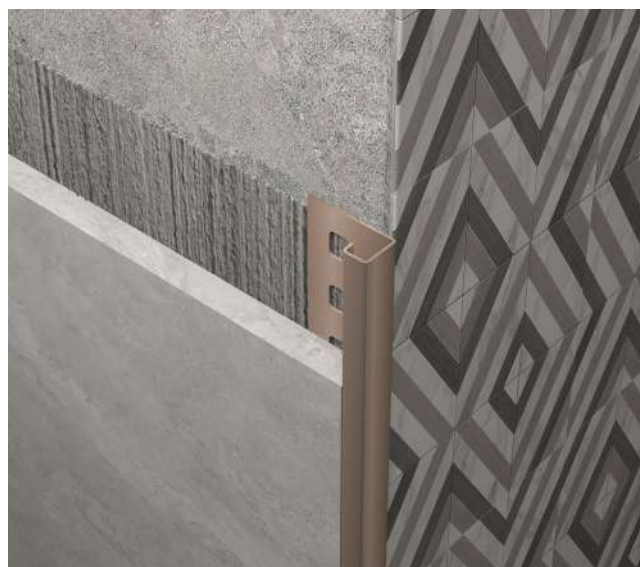
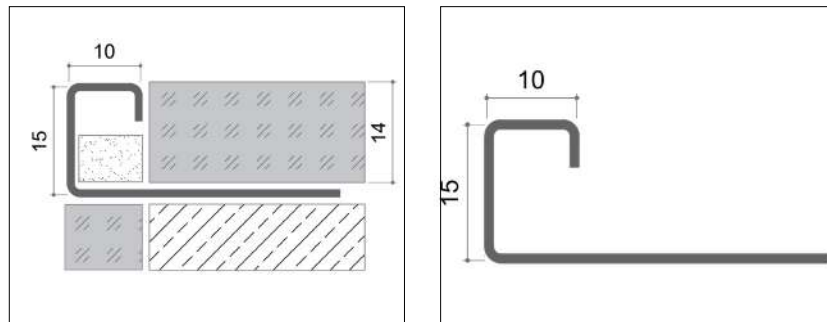
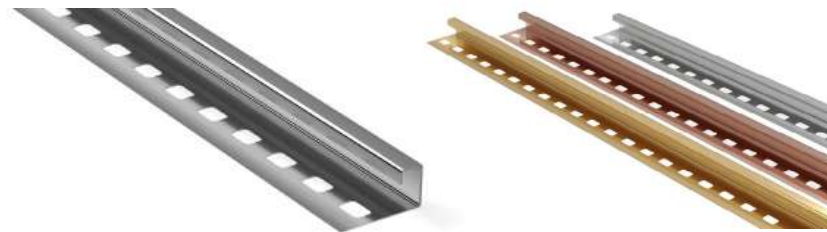

## i3020®

**Color**

Silver - Gold.

**Material**

Stainless 304 or 316.

**Thickness**

0.5mm.

0.7mm.

**Length**

280cm.

**Used**

Edges.

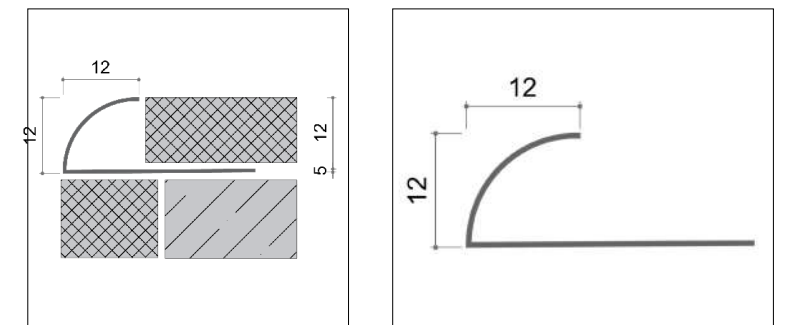

## i3021®

**Color**

Silver - Black.

**Material**

Aluminum.

**Thickness**

1 mm.

**Length**

280cm.

**Used**

Edges - Floor - Wall.

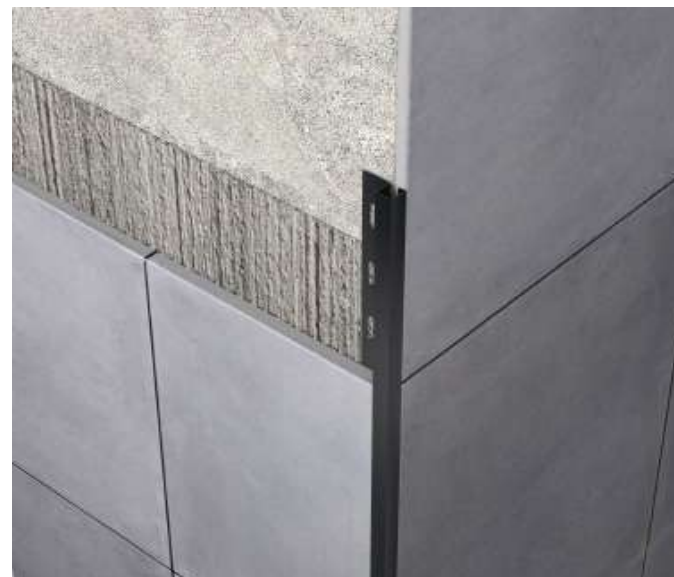
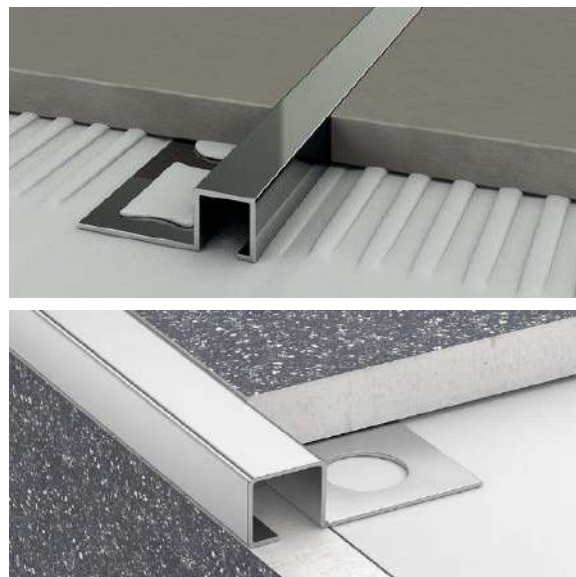
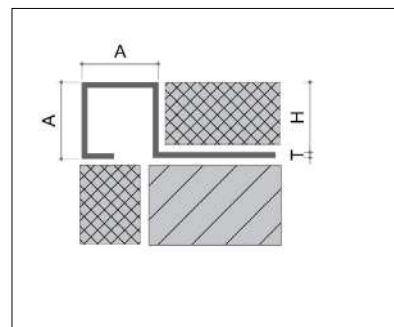
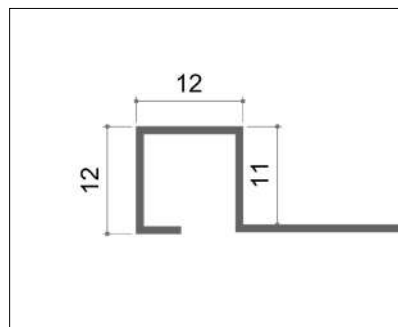

## i3022®

**Color**

Silver - Gold - Rose Gold.

**Material**

Stainless 304.

**Thickness**

0.8mm.

**Length**

300cm.

**Width**

1cm - 2cm &amp; 3cm.

**Used**

Floor - Wall.

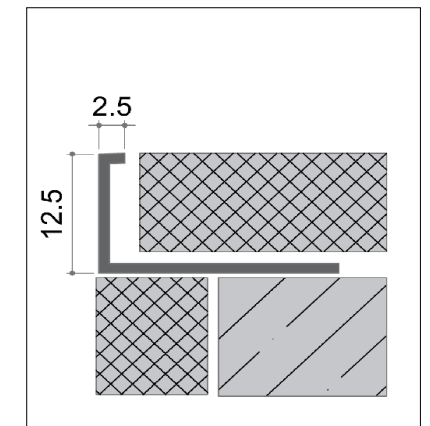
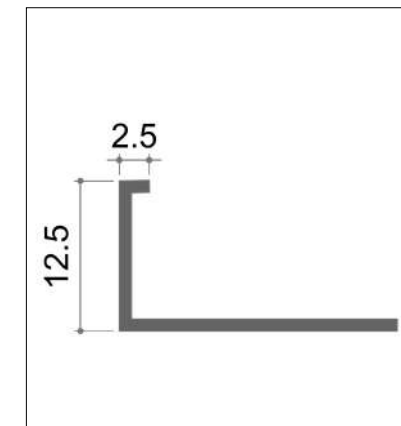



## i3030®

**Color**

Silver - Gold - Rose Gold.

**Material**

Stainless 304.

**Thickness**

0.8mm.

**Length**

280cm.

**Used**

Floor - Wall.

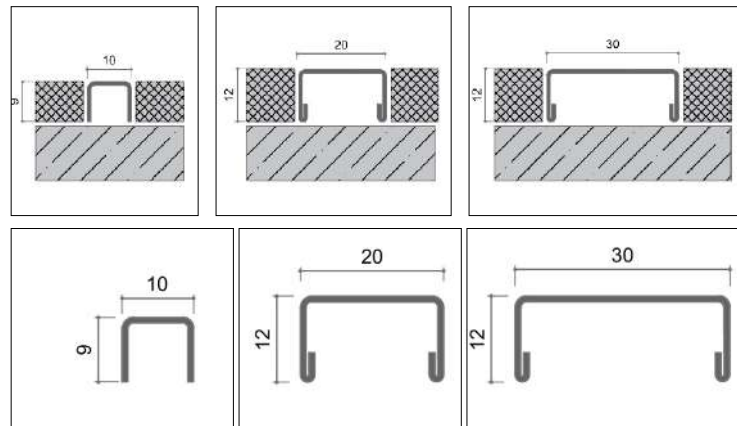
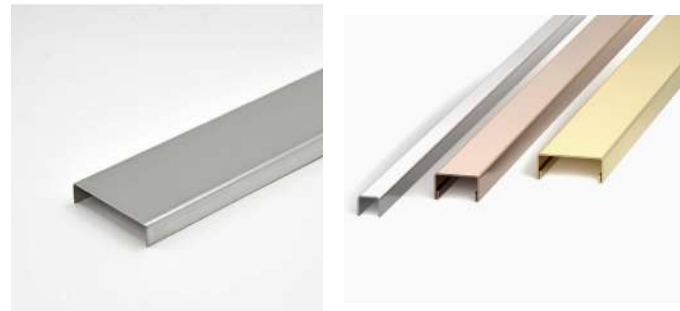

## i3040®

**Color**

Silver - Gold - Rose Gold.

**Material**

Stainless 304.

**Thickness**

0.6mm.

**Length**

250cm.

**Used**

Joints.

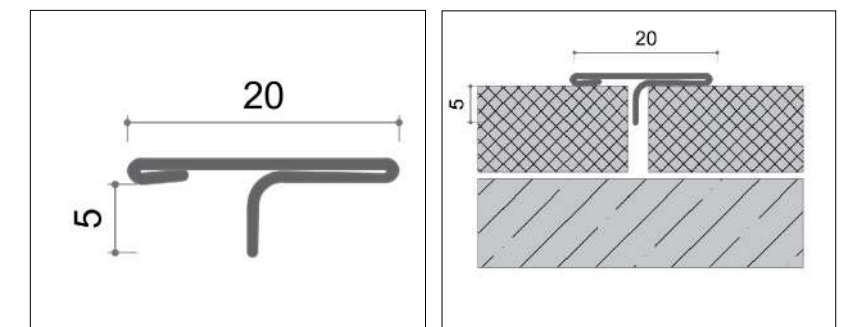
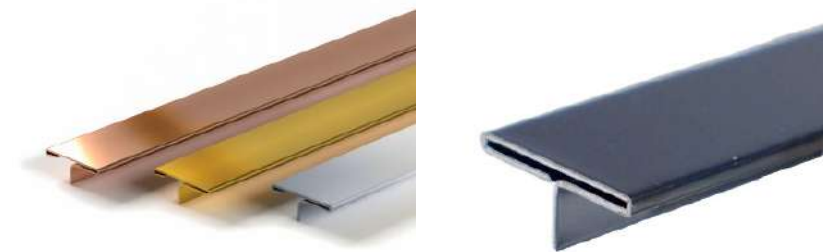

i3050<sup>®</sup>**Color**

Silver.

**Material**

Aluminum.

**Thickness**

1mm.

**Length**

250cm.

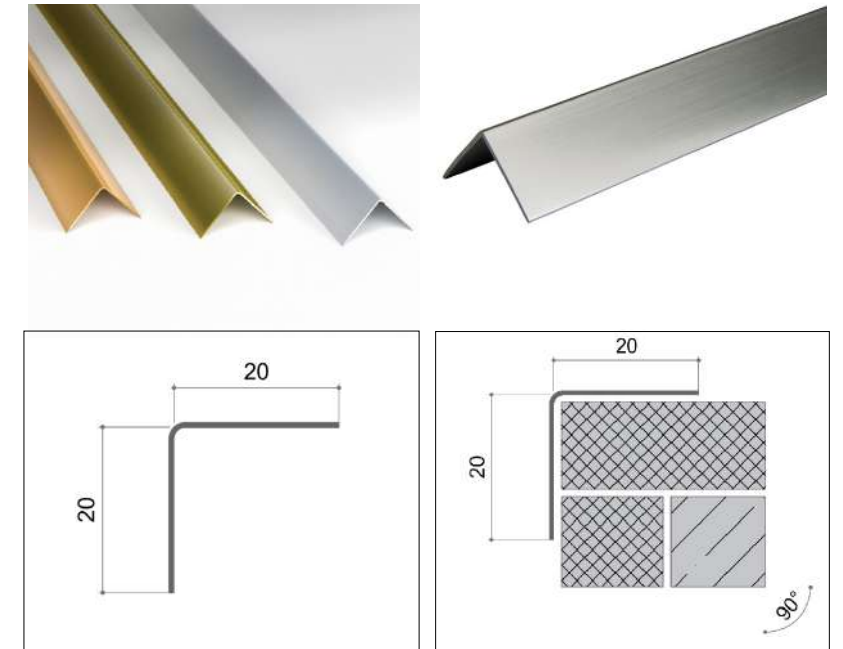
**Used**Corner Guard  
& Stair nose.



## i3060®

**Color**

Silver.

**Material**

Aluminum.

**Thickness**

1mm.

**Length**

300cm.

**Width**

28mm.

**Used**

Floor hdf - Carpet.

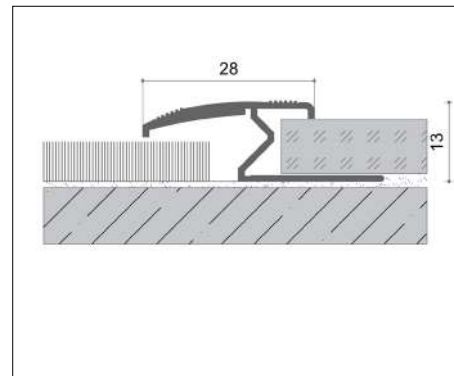
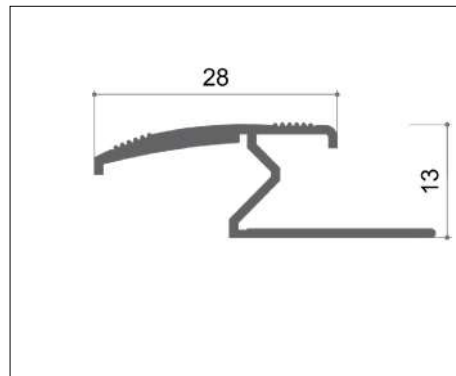

## i3061®

**Color**

Silver.

**Material**

Aluminum.

**Thickness**

0.7mm.

**Length**

280cm.

**Used**

Internar Corner.

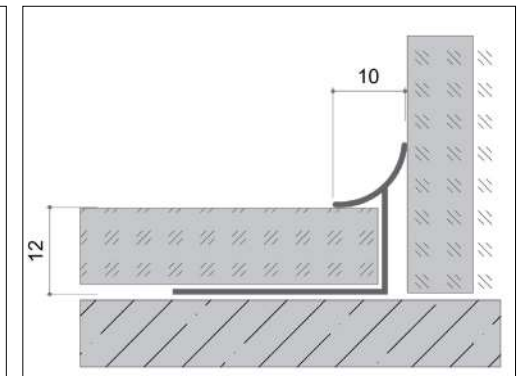
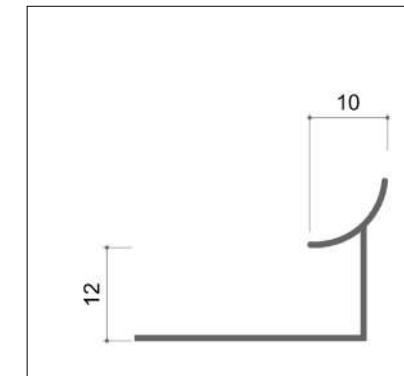
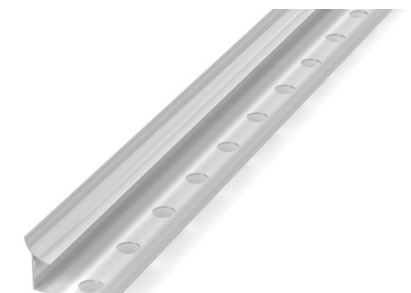

i3062®

- Color
- Silver - White - Black.
- Material
- Aluminum.
- Thickness
- 1mm.
- Length
- 250cm.
- Used
- Glass Profile - Edges.

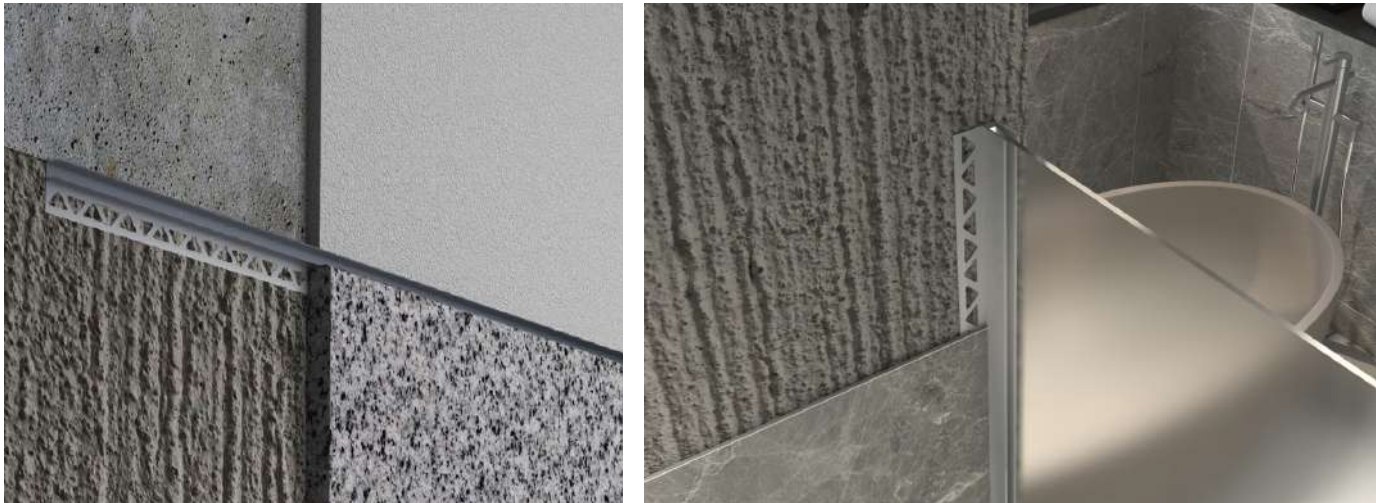
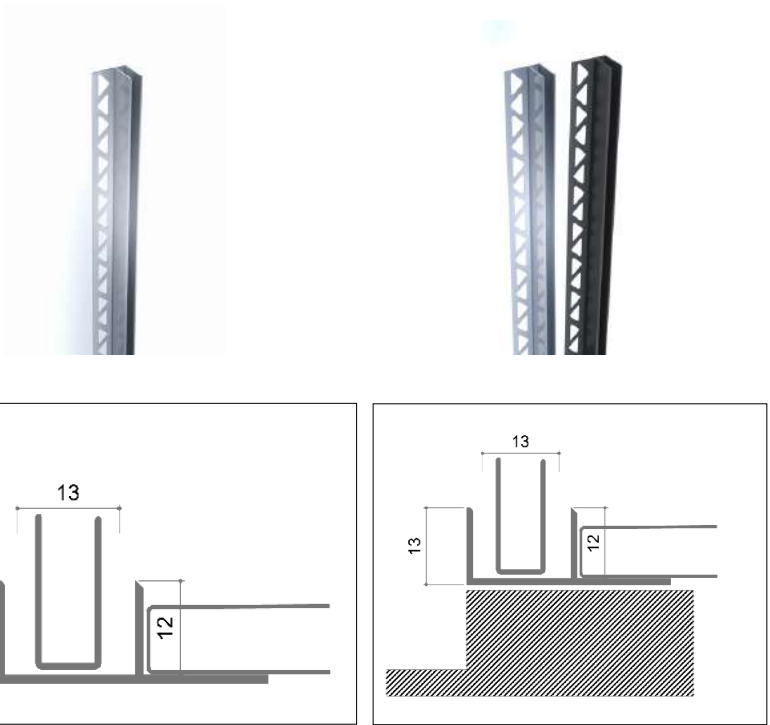

iFlash Metal®

- Description
- The **iFlash Metal®** System is Designed for installed at wall and roof intersections, at gutters, wherever there is a change in roof slope or direction and round roof opening. where flashing is of metal.
- Key Features
- Install Condition:

Roof/Roof, Roof/Wall .

Flush mount exterior systems reduce sightline.

Adaptable to many finishes, including exterior paints, marble, stone, etc.

Mill finish aluminum.
- Materials
- Aluminum: Alloy types of 6061-T6, 6063-T6, 6005A, or 5052-H32 sheet goods.



iFlash Metal -Roof to Roof		iFlash Metal - Roof to Wall		
Application	System	W	H1	L
		Width	Thickness	Length
		mm	mm	m
Roof to Roof	iFlash Metal-60	60	1/1.5/2/3	3
	iFlash Metal-80	80	1/1.5/2/3	3
	iFlash Metal-100	100	1/1.5/2/3	3
	iFlash Metal-120	120	1/1.5/2/3	3
	iFlash Metal-150	150	1/1.5/2/3	3



OUR  
PROJECT

MIDTOWN SOLO MALL

Midtown Solo Mall project in the New Administrative Capital is one of the largest commercial projects that have been established in New Million City. Midtown Solo project was established in one of the most important investment destinations in the future. It was designed and constructed according to the latest models and styles, and it was provided with all facilities and services.

Better Home Real Estate Development Company was able to establish its huge commercial project in the most vital areas of the Administrative Capital, specifically in the seventh residential district R7, which occupies a wide reputation among the most prestigious neighborhoods of the New Capital.



Location	New Administrative Capital
Client	Better Home
Consultant	Better Home
Contractor	Alshorouk - Redcon - Hueck - Alahram
Quantities	400 M
iChem products used	I330 Floor systems I845 Floor systems i412 Exterior systems I870 Wall systems

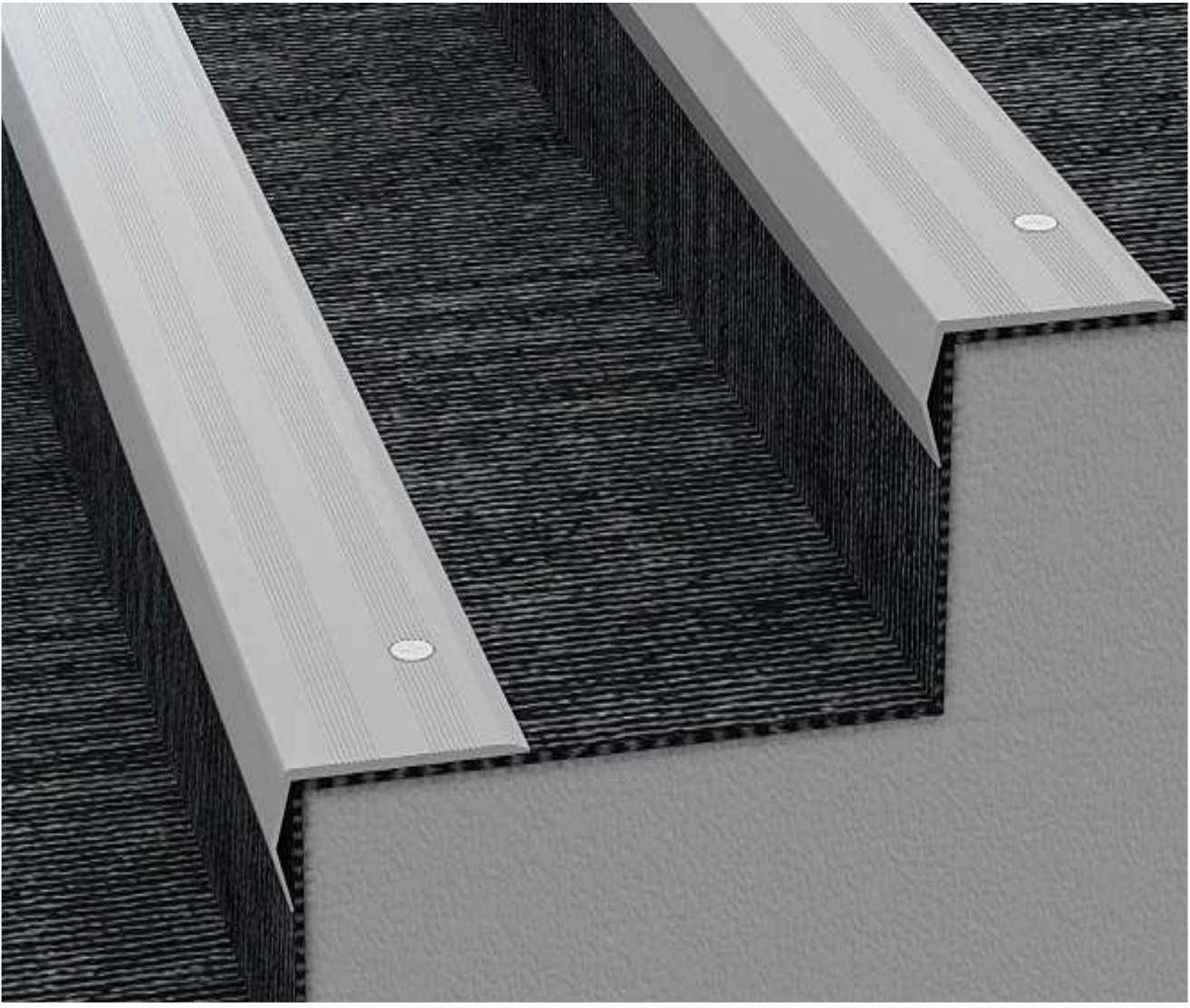

STAIR NOSE



## i2020®



## Description

The **i2020®** a System is a Stair Nosing Profile matching with many finishes.

## Key Features

Adaptable to many finishes, including ceramic tile, marble, stone, terrazzo and resin.  
 Snap-fit design for easy on site assembly.  
 No dirt or water traps.  
 Aluminium available in several colors.  
 Anodized Aluminium.

## Uses

Provide Slip Resistance.  
 Protect Step Edge.  
 Provide Visual Contrast for step edge.

## Materials

Aluminium Alloy 6063, T6.

## Application Instructions

1. Cut **i2020®** to the desired length.
2. Remove all remains of oil, grease and dirt. from the surface where the **i2020®** will be laid.
3. When the surface is dry, remove the protective film.
4. Correctly position the **i2020®** and press it without hitting.

## Maintenance

The **i2020®** does not require any special maintenance; it is suggested to clean it with normal household cleaning products.

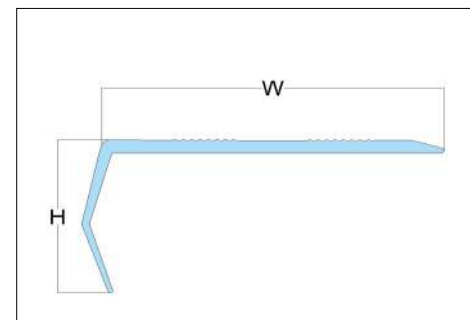
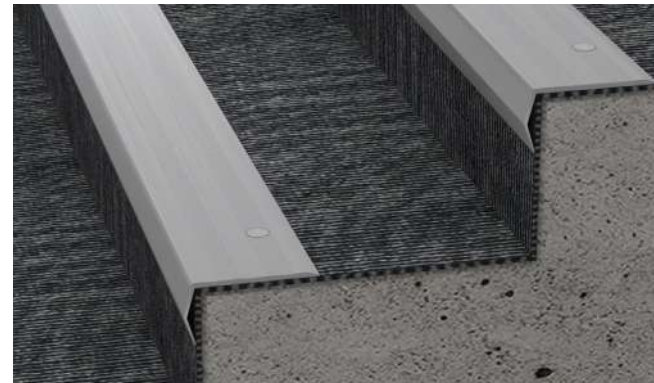

## Protect

The **i2020®** increase the lifespan of the stairs, providing a long lasting and safe staircase. Stair Nosing helps protect the most exposed areas of the stair tread from damage and general wear.

## Store

Store components in original containers in a clean, dry location. Ensure temperature or moisture sensitive components are stored in a tempered location.

Contractor to provide temporary protective covers on all installed finished surfaces. Protection is required to guard against both surface abrasions as well as overloading of horizontal deck components by construction traffic.

System	W	H	S
	Width	Height	thickness
	mm	mm	mm
i2020	75	30	3

## i2025®



## Description

The **i2025®** a System is a Stair Nosing Profile matching with many finishes.

## Key Features

Adaptable to many finishes, including ceramic tile, marble, stone, terrazzo and resin.  
 Snap-fit design for easy on site assembly.  
 No dirt or water traps.  
 Aluminium available in several colors.  
 Anodized Aluminium.

## uses

Provide Slip Resistance.  
 Protect Step Edge.  
 Provide Visual Contrast for step edge.

## Materials

Aluminium Alloy 6063, T6.  
 Rubber.

## Application Instructions

1. Cut **i2025®** to the desired length.
2. Remove all remains of oil, grease and dirt. from the surface where the **i2025®** will be laid.
3. When the surface is dry, remove the protective film.
4. Correctly position the **i2025®** and press it without hitting.

## Maintenance

The **i2025®** does not require any special maintenance; it is suggested to clean it with normal household cleaning products.

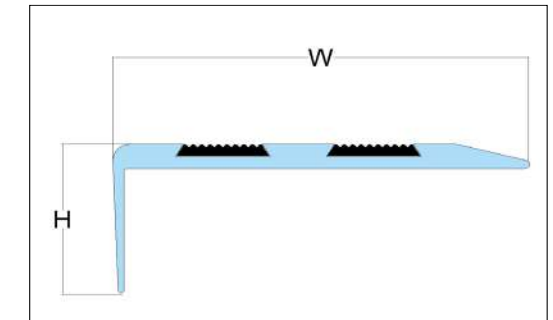

## Protect

The **i2025®** increase the lifespan of the stairs, providing a long lasting and safe staircase. Stair Nosing helps protect the most exposed areas of the stair tread from damage and general wear.

## Store

Store components in original containers in a clean, dry location. Ensure temperature or moisture sensitive components are stored in a tempered location.

Contractor to provide temporary protective covers on all installed finished surfaces. Protection is required to guard against both surface abrasions as well as overloading of horizontal deck components by construction traffic.

System	W	H	S
	Width	Height	thickness
	mm	mm	mm
i2025	75	30	5



OUR  
PROJECT

EGYPT JAPAN UNIVERSITY OF  
SCIENCE & TECHNOLOGY

IChemEG has played a significant role in the Egypt-Japan University of Science and Technology project by providing advanced Expansion Joint Solutions and Concrete Additives. These high-quality construction materials ensure the structural integrity, durability, and long-term sustainability of the university's infrastructure. IChemEG's innovative solutions enhance the flexibility of buildings, protecting them from environmental stresses like temperature changes and seismic shifts. With a focus on quality and sustainability, IChemEG's contributions support the development of world-class educational facilities, ensuring that E-JUST remains resilient, eco-friendly, and ready for future growth.



Location	Borg Elarab City
Client	Egypt Japan University of Science & Technology
Consultant	MZECH
Contractor	Al Safa For general Contracting
Quantities	620 M
iChem products used	i424-i330-i845 Floor systems IFLEX EPDM – iFlex PVC



CONTROL  
JOINT



# i340®



Description

The **i340®** a System is a Floor Aluminum Movement Joi used for the expansion gap between floors.

Key Features

- Install Condition:** Floor/Floor.
- Joint width:** 15mm.
- Recessed modular frames for minimal sight line.
- Dual durometer seal provides secure fit and optimal flexibility.
- Adaptable to many finishes,including ceramic tile, marble,stone,terrazzo and resin.
- Excellent weatherability and UV resistant.
- Standard and Custom seal colors available.
- Snap-fit design for easy on site assembly.
- Easy to clean flush seals.
- No dirt or water traps.
- Mill finish aluminum.
- Available in several colors:** Beige-Black-Grey-White.

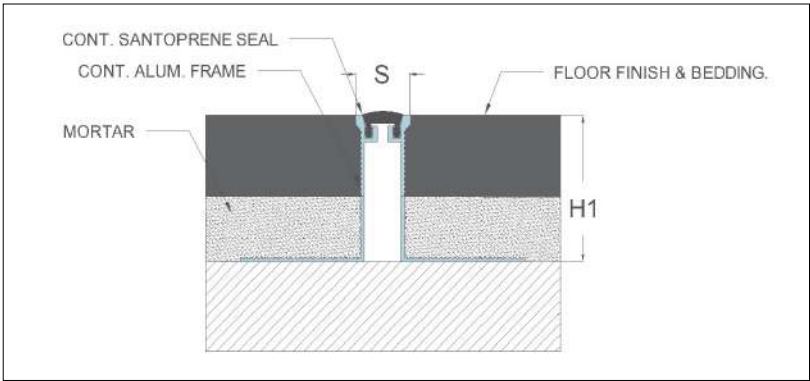

Movement ± 25%

System	W	H1	H2	S	B	Movement +/-	
	Joint Width	Frame Height 1	Height 2	Sightline	Blockout	Horizontal	Vertical
	mm	mm	mm	mm	mm	mm	mm
i340-40	15	40	*	10	*	3	3
i340-15	15	15	*	10	*	3	3

# i345®



Description

The **i345®** a System is a Floor Aluminum Movem Joint used for the expansion gap between floors

Key Features

- Install Condition:** Floor/Floor.
- Joint width:** 10-20mm.
- Recessed modular frames for minimal sight line.
- Dual durometer seal provides secure fit and optimal flexibility.
- Adaptable to many finishes,including ceramic tile,marble,stone, terrazzo and resin.
- Snap-fit design for easy on site assembly.
- Easy to clean flush seals.
- No dirt or water traps.
- Mill finish aluminum.
- Available in several colors:** Beige-Black-Grey-White.

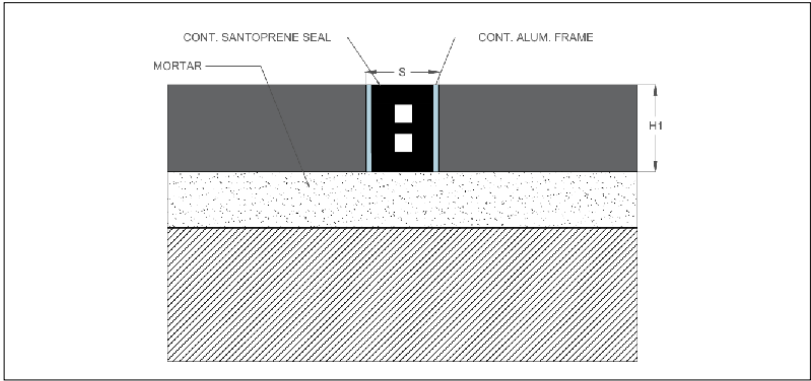

Movement ± 25%

System	W	H1	H2	S	B	Movement +/-	
	Joint Width	Frame Height 1	Height 2	Sightline	Blockout	Horizontal	Vertical
	mm	mm	mm	mm	mm	mm	mm
i345-10*20	10	20	*	10	*	2.5	2.5
i345-20*20	20	20	*	20	*	5	5
i345-20*40	20	40	*	20	*	5	5
i345-40*20	40	20	*	40	*	10	10



## i348®

## Description

The i348® a System is a Floor PVC Movement Joint used for the expansion gap between floors.

## Key Features

**Install Condition:** Floor/Floor.

**Joint width:** 8mm.

Recessed modular frames for minimal sight line.

Dual durometer seal provides secure fit and optimal flexibility.

Adaptable to many finishes, including ceramic tile, marble, stone, terrazzo and resin.

Snap-fit design for easy on site assembly.

No dirt or water traps.

Available in several colors.

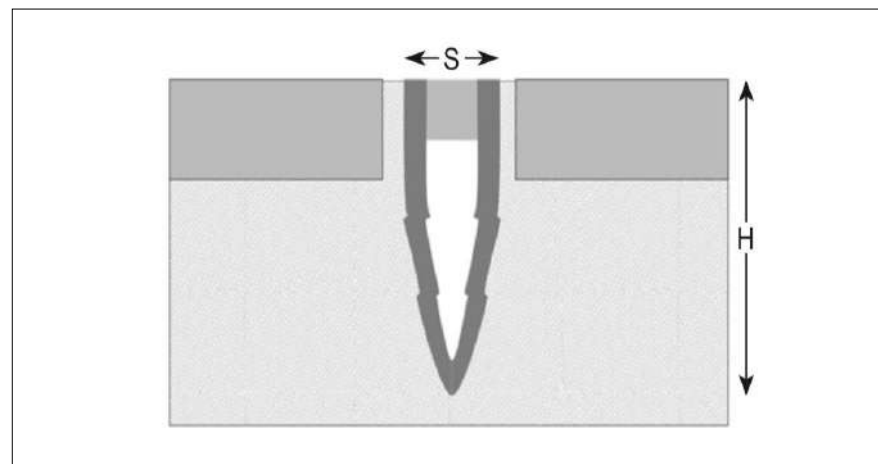
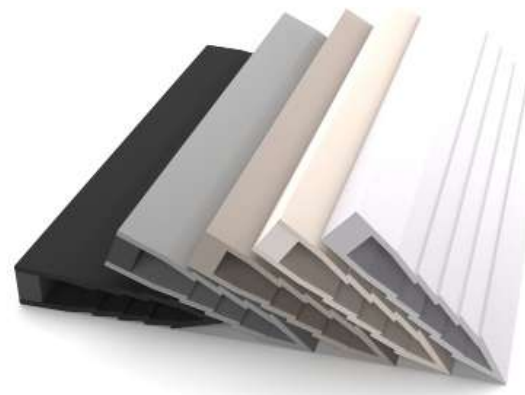

System	W	H1	H2	S	B	Movement +/-	
	Joint Width	Frame Height 1	Height 2	Sightline	Blockout	Horizontal	Vertical
	mm	mm	mm	mm	mm	mm	mm
i348	8	35	*	8	*	2	2

## EXPANSION JOINTS &amp; CONTROL JOINT

## WHAT IS THE DIFFERENCE?



## Expansion Joints

- Special joints or gaps in a structure, typically filled with flexible materials, that are designed to absorb the movement or expansion of the building or structure due to temperature changes, pressure variations, or other environmental factors. These joints help prevent cracks and damage to the structure by allowing for movement without compromising the integrity of the materials.
- They are commonly used in roads, bridges, buildings, and other large-scale structures to accommodate thermal expansion, contraction, vibration, or shifting of materials.

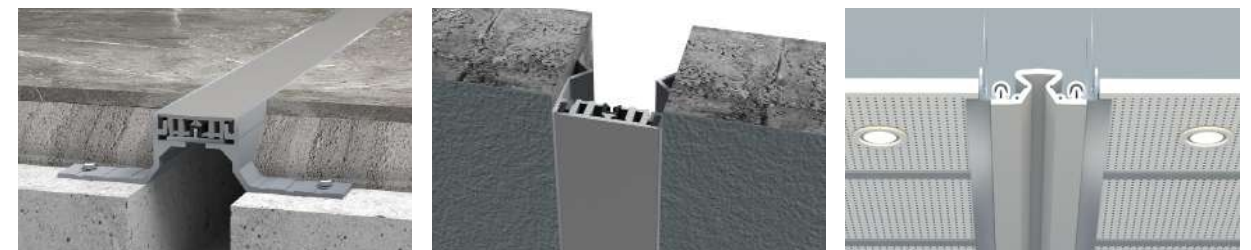

## Control Joint (in Finishing)

- control joints are designed to enhance the aesthetic appearance or define spaces in finishing work, with less impact on the structural integrity. They are used to separate architectural elements or regulate expansion and contraction in decorative materials (such as walls, floors, and surface finishes).
- Location: Architectural joints are used mainly in interior finishes or between decorative surfaces like flooring, walls, or ceilings.





OUR PROJECT

KERNEL BUSINESS HUB

Kernel New Cairo Mall features an elegant and modern-styled design, it competes with other malls in New Cairo. Affix Developments provides a ground floor and 4 upper floors, in addition to 2 floors for a garage which can accommodate the largest number of cars. Moreover, Mall Kernel Business Hub contains administrative, medical and commercial units to satisfy diverse tastes. Kernel Mall New Capital extends over an area of 4,400 m2 which is ideal for all activities, especially since the height of each floor is 3.5 m. Additionally, Affix provides varying spaces, depending on the type of activity; the spaces of medical units start from 36 m2, while the space of administrative units in Kernel Mall starts from 32 m2.



Location	New Cairo.
Client	Affix Developments.
Consultant	Affix.
Contractor	Affix.
Quantities	100 M
iChem products used	i424-i330-i870 Floor system-siFlex PVC.



SKIRTING  
PROFIELS



# i4010®

## Description

The **i4010®** is an aluminum skirting board system designed for flooring. The product features a sleek, modern profile with a hidden mounting system for a clean finish. It provides durable wall protection while enhancing the overall aesthetic of interior spaces.

## Material

Aluminum.

## Thickness

1.5mm.

## Length

250cm.

## Used

skirting board.

## Color

Silver.

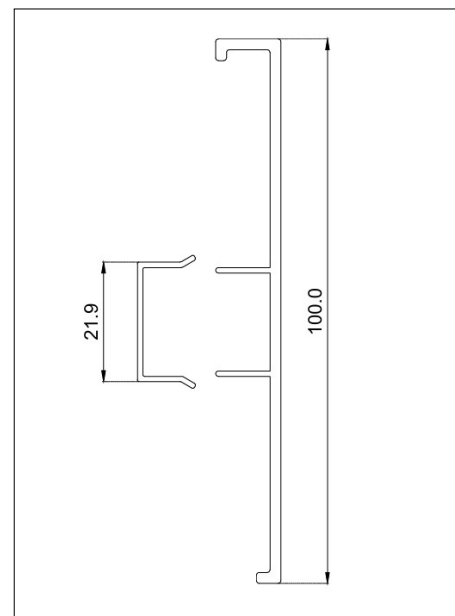

And a lot of electrostatic colors for Example:



# i4011®

## Description

The **i4011®** is an aluminum skirting board system with integrated concealed lighting, designed for flooring. The product features a sleek, modern profile with a hidden mounting system and LED channel for ambient lighting. It provides durable wall protection while enhancing the aesthetic of interior spaces.

## Material

Aluminum.

## Thickness

1.5mm.

## Length

250cm.

## Used

skirting board with light system.

## Color

Silver.

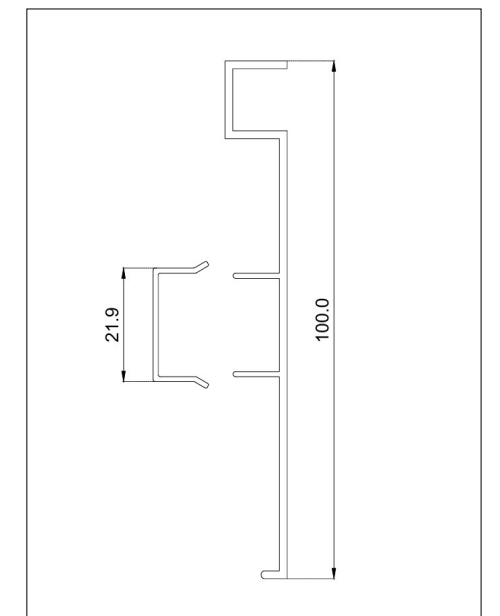

With a lot of light system for Example:



## Available Finishes



## Stocked Finishes



Mail



Clear Anodized

A lot of electrostatic colors: for Example

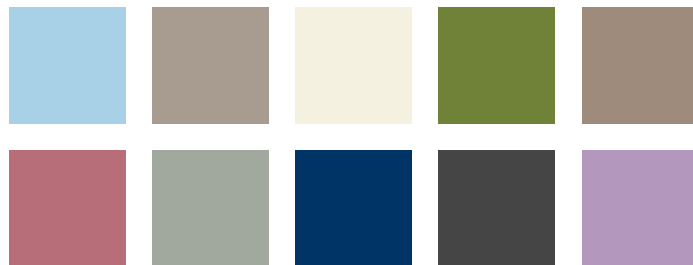

## Standard Santoprene Seals



 [www.ichemeg.com](http://www.ichemeg.com)

 [info@ichemeg.com](mailto:info@ichemeg.com)

 02 229 091 20

 010 220 00050

